

# Revell

# HOT ROD

7124-3800

## '56 FORD PICKUP

Hot Rod Magazine has the highest circulation of any automotive publication in the United States.

Established in 1948, no one has consistently picked trends, set standards, or kept the American car enthusiast as informed as Hot Rod.

For over 35 years, Revell has been actively involved in popularizing various aspects of the automotive hobby. Many of today's real car builders and enthusiasts got their start building scale models carrying the Revell logo.

With the combined excellence of almost 75 years, Hot Rod and Revell have teamed up to produce an exciting new line of classic vehicles for today's model enthusiasts — the Hot Rod Magazine Automotive Series.

The '56 Ford Pickup is the most frequently customized truck of the 1950's. The body stylizing was originally introduced in 1953 and was modified in 1956 by the addition of a wraparound front windshield. Revell's 1/25 scale Hot Rod Classic is packed with all the

options you could ask for including two complete engines (a Thunderbird V-8 and a custom blown 421 Pontiac), "blackout" trim, and modular wheels.

High-tech graphics and contemporary styling complete the picture or a total 80's look.

**ENGLISH:** ASSEMBLY DRAWINGS SHOULD BE REVIEWED BEFORE PROCEEDING WITH CONSTRUCTION. A NUMBER IDENTIFIES EACH PLASTIC PART FOR YOUR CONVENIENCE. PAINT SMALL PARTS ON RUNNER BEFORE REMOVING. ALLOW PAINT TO DRY THOROUGHLY BEFORE CONTINUING ASSEMBLY OF KIT. SCRAPE CHROME OR PAINT AT AREA TO BE GLUED. WASH PLASTIC IN MILD DETERGENT SOLUTION. RINSE AND LET AIR DRY FOR BETTER PAINT AND DECAL ADHESION.

**FRANCAIS:** EXAMINER LES SCHEMAS D'ASSEMBLAGE AVANT DE COMMENCER LA CONSTRUCTION. UN NUMERO IDENTIFIE CHAQUE PIECE DE PLASTIQUE POUR PLUS DE FACILITE. PEINDRE LES PETITES PEICES SUR LE SUPPORT AVANT DE LES ENLEVER. LAISSER LA PEINTURE SECHER COMPLETEMENT AVANT DE CONTINUER L'ASSEMBLAGE.

**DU KIT:** GRATTER LE CHROME OU LA PEINTURE SUR LES SURFACE A COLLER. LAYER LE PLASTIQUE DANS UNE SOLUTION DE DETERGENT LEGERE, RINCER ET LAISSER SECHER A L'AIR POUR UNE MEILLEURE ADHERENCE DE LA PEINTURE ET DES DECALS.

**ESPAÑOL:** DIBUJOS DE ENSAMBLAJE DEBEN SER REPASADOS ANTES DE SEGUIR CON LA CONSTRUCCION. UN NUMERO IDENTIFICA CADA PARTE DEL PLASTICO PARA SU CONVENIENCIA. PINTAR PARTES PEQUEÑAS DEL KIT ANTES DE QUITARLAS. DEJE SECAR BIEN LA PINTURA ANTES DE SEGUIR EL ENSAMBLAJE. RASPE EL CROMO O LA PINTURA DEL SITIO ANTES DE SER PEGADO. LAVE EL PLASTICO EN UNA SOLUCION SUAVE DETERGENTE, ENJUAGUE, Y DEJE SECAR EN EL AIRE PARA MEJOR ADHESION DE LA PINTURA Y CALCOMANIA.



GLUE  
COLLE  
PEGA



NO GLUE REQUIRED  
LA COLLE N'EST PAS NECESSAIRE  
NO NECESITA PEGA



DO IT THIS MANY TIMES  
LE FAIRE CE NOMBRE DE FOIS  
HAGALO ESTA CANTIDAD DE VECES



OPTIONAL  
FACULTATIF  
OPCIONAL

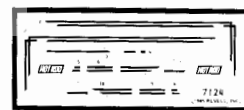

APPLY DECALS  
COLLER LES DECALCOMANIES  
APLICAR CALCAS



SHOWN ASSEMBLED  
VU ASSEMBLE  
MOSTRADO ARMADO



CLEAR  
TRANSPARENT  
TRANSPARENTE



DARK BLUE  
BLEU FONCE  
AZUL OSCURO



CHROME  
LE CHROME  
EL CROMO

<b>A</b>	YELLOW	JAUNE	AMARILLO
<b>B</b>	SILVER	ARGENT	PLATA
<b>C</b>	BLACK	NOIR	NEGRO
<b>D</b>	BLUE GRAY	GRIS BLEU	GRIS AZUL
<b>E</b>	METALLIC GRAY	GRIS METALLISE	GRIS METALICO

<b>F</b>	RED	ROUGE	ROJO
<b>G</b>	DARK BLUE	BLEU FONCE	AZUL OSCURO
<b>H</b>	MEDIUM BLUE	BLEU MOYEN	AZUL MEDIO
<b>I</b>	MATT BLACK	NOIR MAT	NEGRO MATE

**1**

- 1 ENGINE BLOCK TOP
- 2 ENGINE BLOCK BOTTOM
- 3 ENGINE FRONT PLATE
- 6 INTAKE MANIFOLD

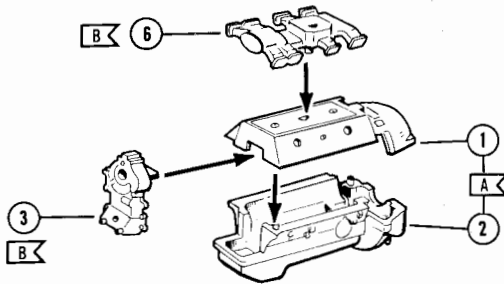
**2**

- 4 HEAD—LEFT
- 5 HEAD—RIGHT
- 9 VALVE COVER—LEFT (CHROME)
- 10 VALVE COVER—RIGHT (CHROME)

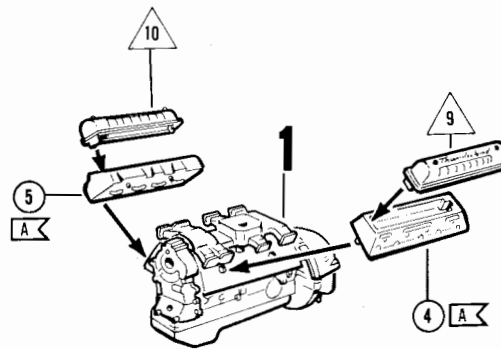
**3**

- 7 BELTS AND PULLEYS
- 12 FAN
- 13 OIL FILTER (CHROME)

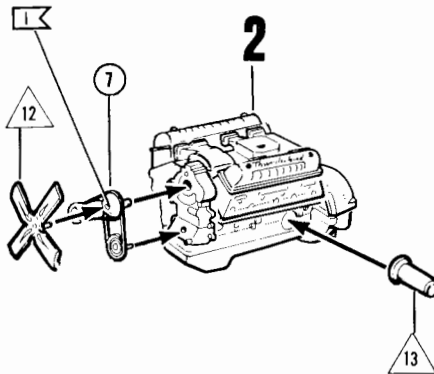
**4**

- 14 TRANSMISSION LEFT HALF
- 15 TRANSMISSION RIGHT HALF
- 16 STARTER (CHROME)

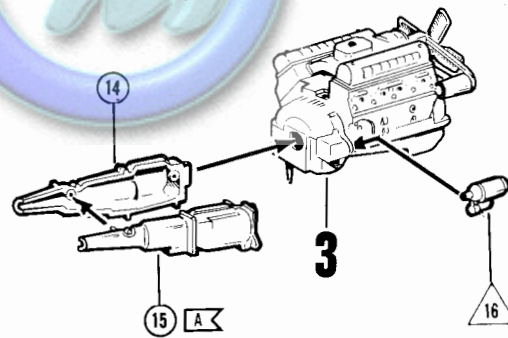

**5**

- 18 EXHAUST MANIFOLD LEFT  
19 EXHAUST MANIFOLD RIGHT

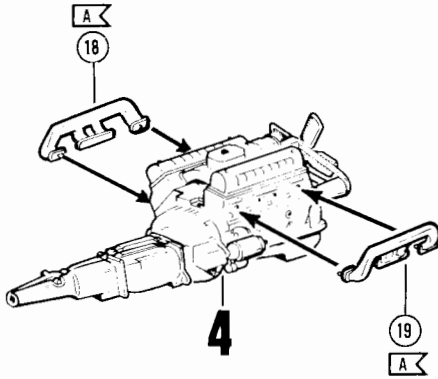
**6**

- 8 CARBURETOR (CHROME)  
11 AIR CLEANER (CHROME)  
17 DISTRIBUTOR

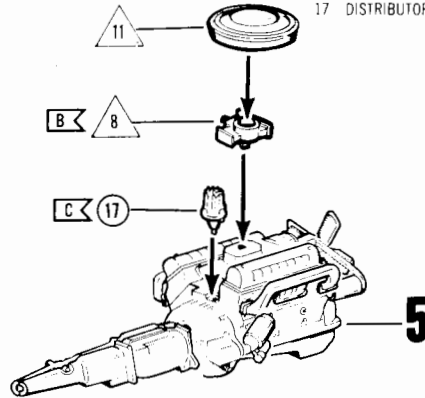
**7** (2X)

- 42 FRONT WHEEL INSIDE (2 PARTS) (CHROME)  
43 FRONT WHEEL OUTSIDE (2 PARTS) (CHROME)

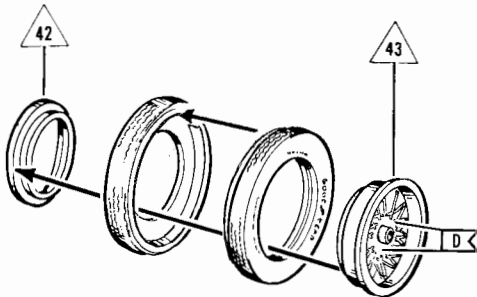
**8** (2X)

- 42 REAR WHEEL INSIDE (2 PARTS) (CHROME)  
43 REAR WHEEL OUTSIDE (2 PARTS) (CHROME)

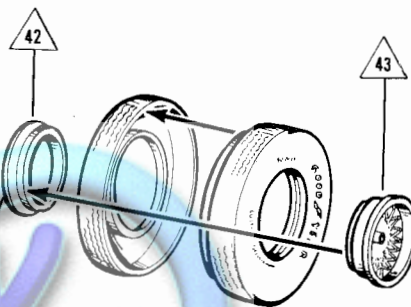
**9**

- 39 FRONT AXLE—STOCK OR DROPPED  
40 STEERING ARM  
41 TIE ROD  
44A WHEEL RETAINERS (2 PARTS) (CHROME)

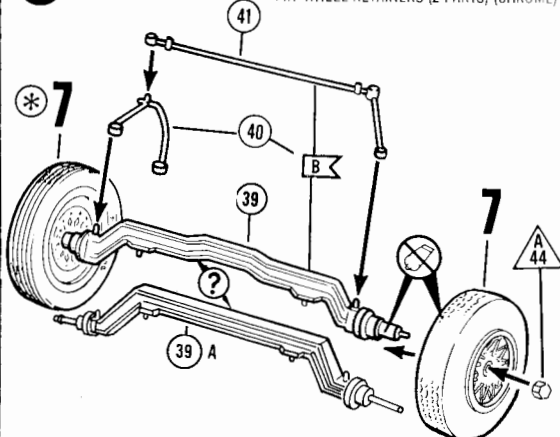
**10**

- 51 REAR AXLE HOUSING TOP  
52 REAR AXLE BOTTOM  
52A REAR AXLE

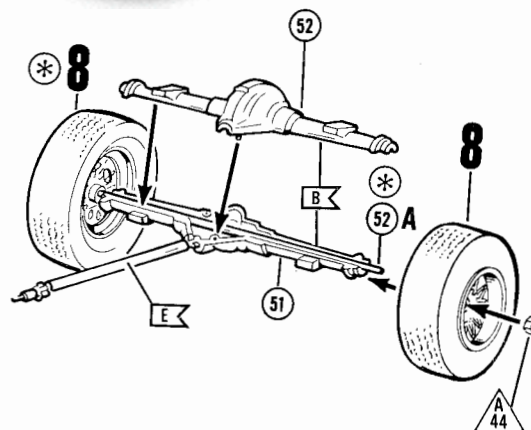

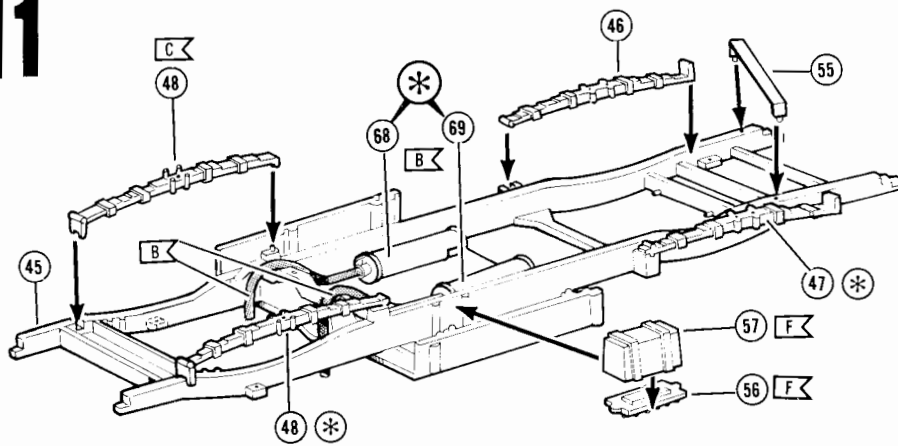
**11**

- 45 FRAME
- 46 REAR SPRING — LEFT
- 47 REAR SPRING — RIGHT
- 48 FRONT SPRING (2 PARTS)
- 55 SPARE TIRE HANGER
- 56 BATTERY — TOP
- 57 BATTERY — BOTTOM
- 68 MUFFLER — LEFT
- 69 MUFFLER — RIGHT

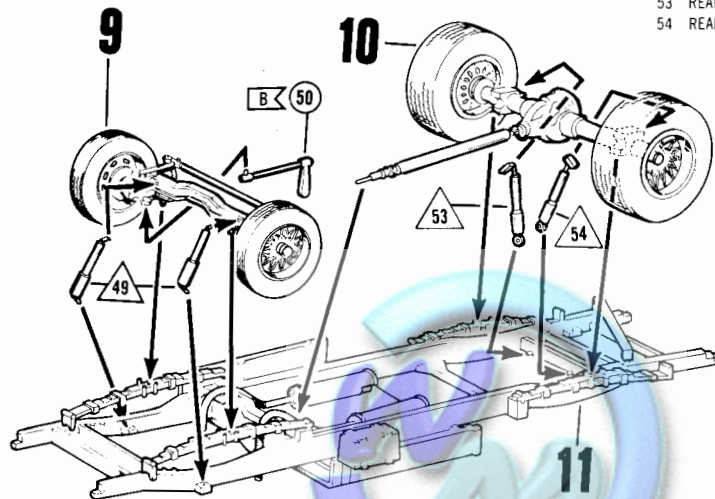
**12**

- 49 FRONT SHOCKS (2 PARTS)
- 50 DRAG LINK
- 53 REAR SHOCK — LEFT (CHROME)
- 54 REAR SHOCK — RIGHT (CHROME)

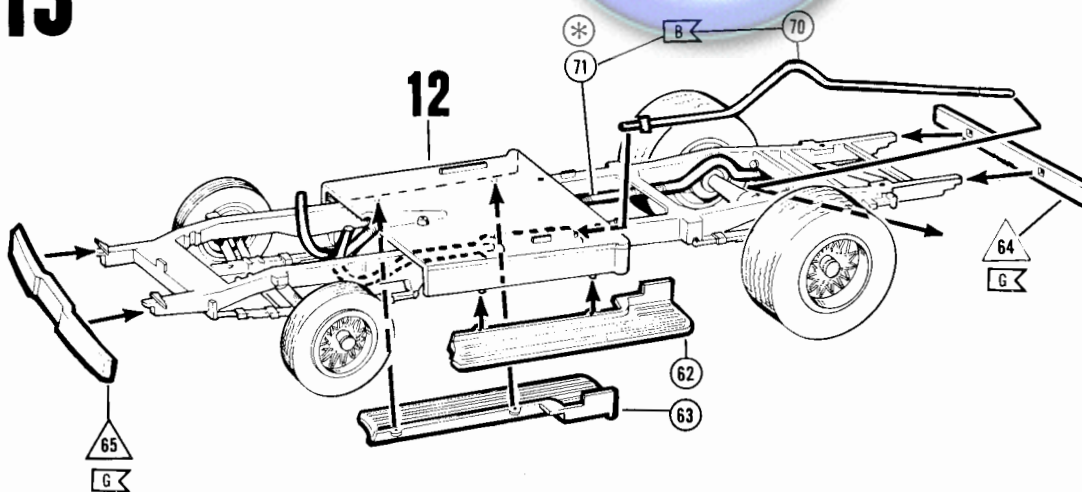
**13**

- 62 RUNNING BOARD — LEFT
- 63 RUNNING BOARD — RIGHT
- 64 REAR BUMPER (CHROME)
- 65 FRONT BUMPER (CHROME)
- 70 TAIL PIPE — LEFT
- 71 TAIL PIPE — RIGHT
- 114 BALL HITCH

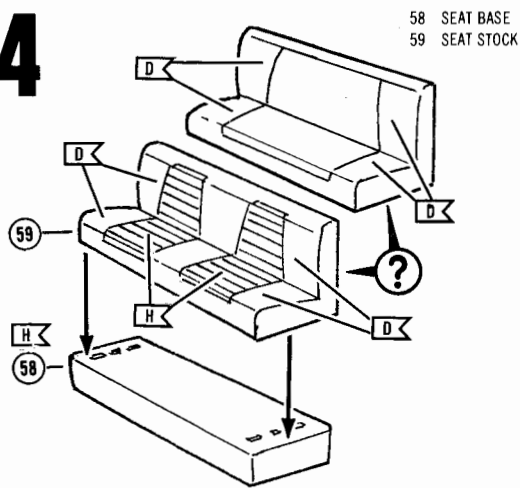
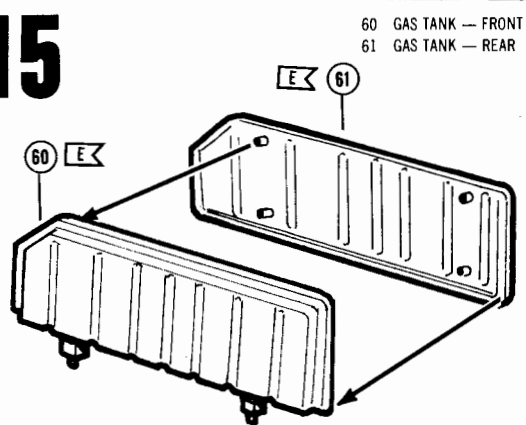
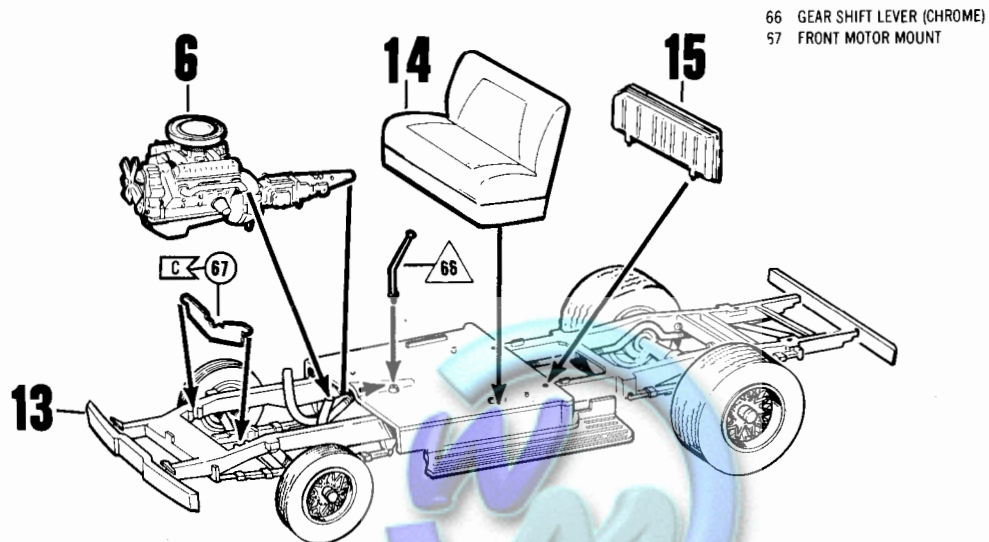
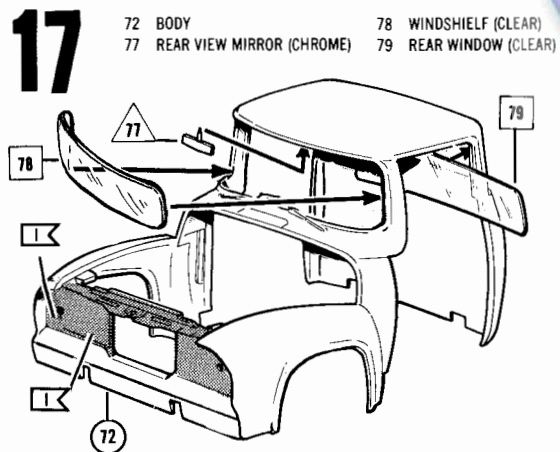
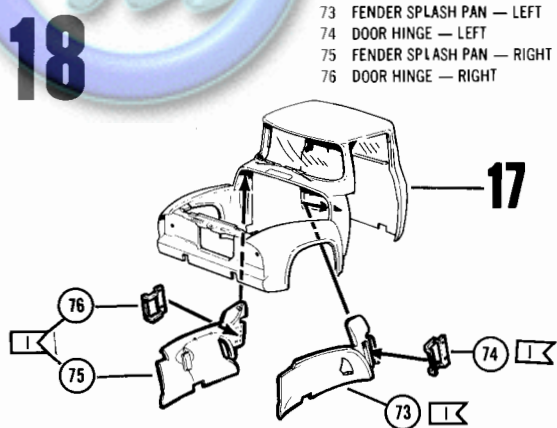

**14****15****16****17****18**

**19**

81 GRILLE — STOCK (CHROME)  
82 LENS (2 PARTS) (CLEAR)

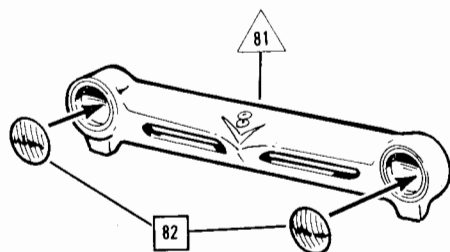
**20**

81A BEZEL (2 PARTS) (CHROME)  
82A LENS (2 PARTS) (CLEAR)  
81B GRILLE (CHROME)

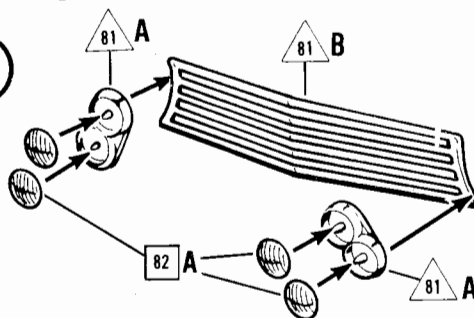
**?****21**

80 RADIATOR

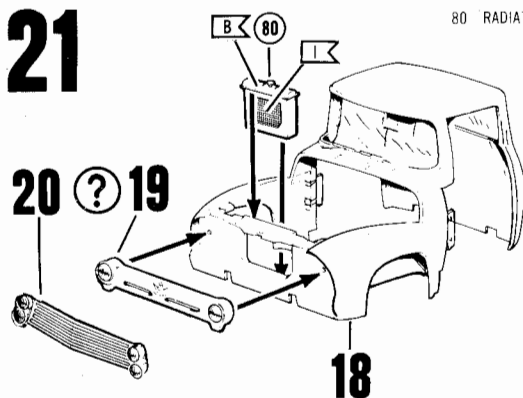
**22**

83 HOOD HINGE — LEFT  
84 HOOD HINGE — RIGHT  
91 HOOD  
92 HOOD ORNAMENT — LEFT (CHROME)  
93 HOOD ORNAMENT — RIGHT (CHROME)

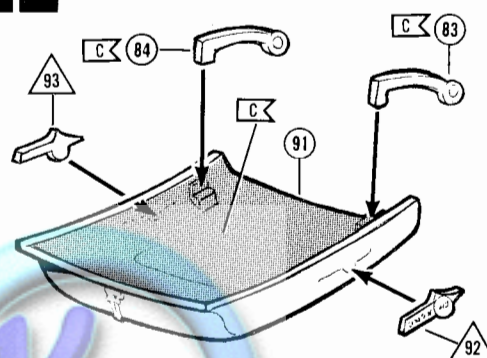
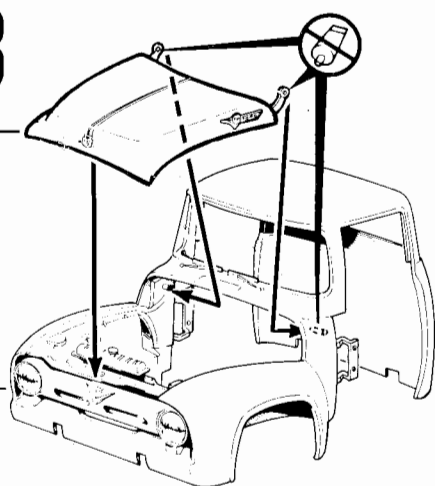
**23****22****21****24**

85 FIREWALL  
86 STEERING COLUMN  
87 STEERING WHEEL  
88 THROTTLE PEDAL  
89 BRAKE PEDAL  
90 CLUTCH PEDAL

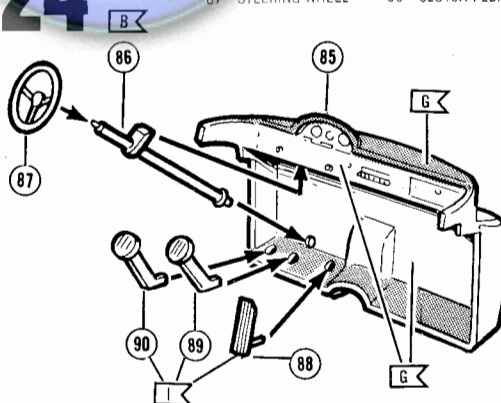

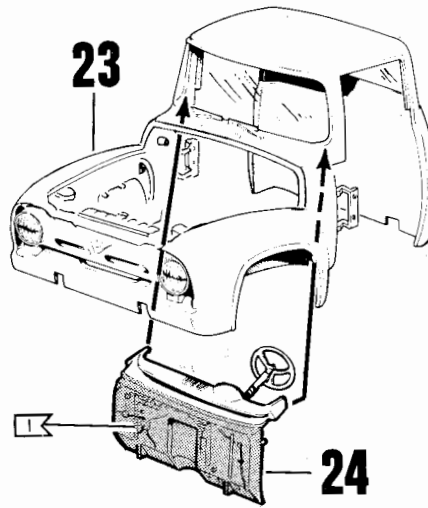
**25****26**

94 DOOR — LEFT  
99 VENT WINDOW — LEFT (CLEAR)

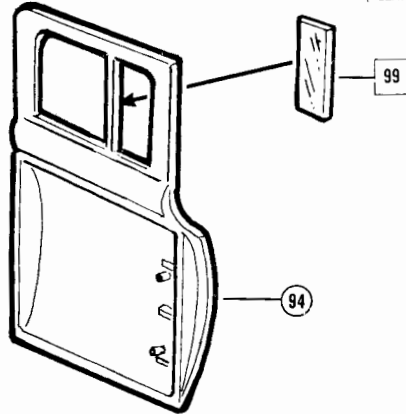
**27**

95 DOOR — RIGHT  
100 VENT WINDOW — RIGHT (CLEAR)

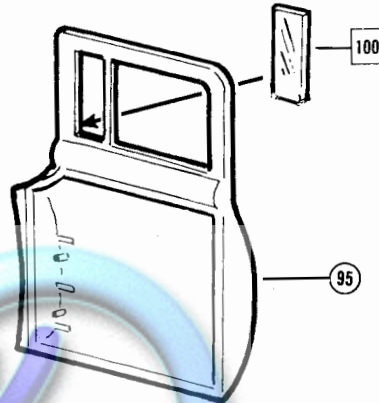
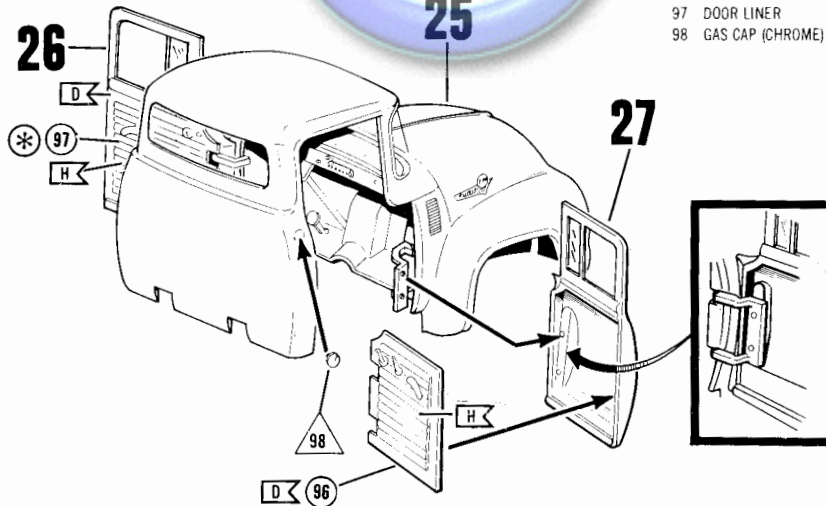
**28**

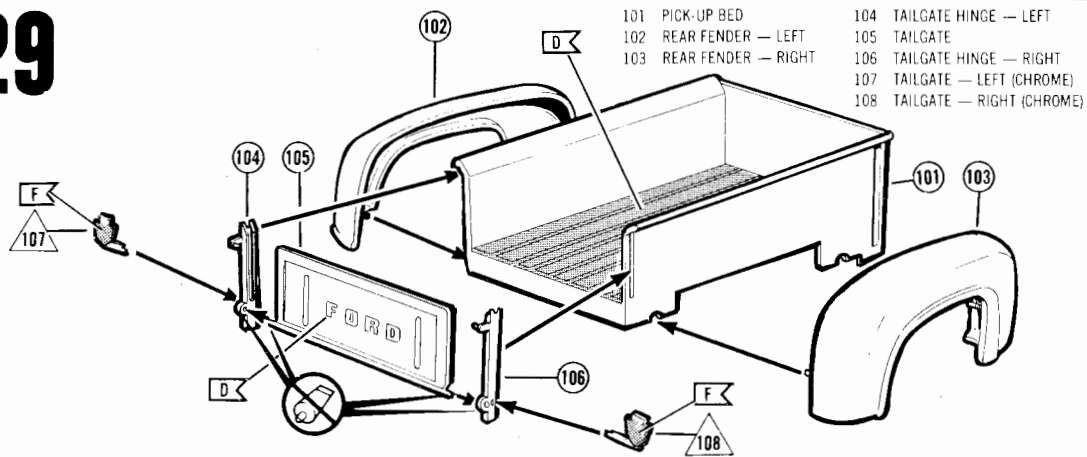
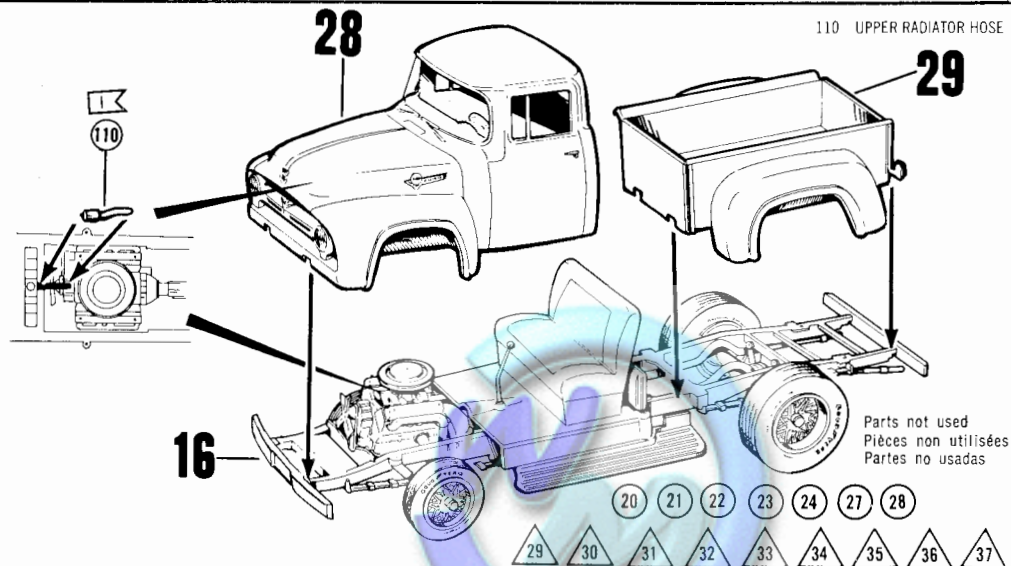
**29****30****31**