



KIT 2844

**DALE EARNHARDT, JR.**  
**DALE EARNHARDT TRIBUTE CONCERT**  
**MONTE CARLO™**

85284400200

Chance Motorsports was formed in 1994 by Dale and Teresa Earnhardt specifically for the purpose of helping Dale's children Kerry, Kelley and Dale Jr. get into racing through the smaller NASCAR® Late Model series. Talent for piloting a race car must definitely run in the genes as Kerry and Dale Jr both excelled, quickly moving up to the Grand National series. As a result, the Earnhardts disbanded Chance shortly thereafter, its purpose accomplished.

In 2003, Teresa and Dale Jr formed Chance 2 Motorsports in the same spirit as the original-helping up and coming drivers and crew members get into the sport. It was under the Chance 2 banner that the #8 Dale Earnhardt Tribute Concert Monte Carlo™ was entered in the spring Grand National race at the Talladega superspeedway. The Dale Earnhardt Tribute Concert was held June 28, 2003 at the Daytona International Speedway, the first time a large musical, rather than racing, event was held at the facility. The fund raising concert benefited the Dale Earnhardt Foundation and charitable causes the late seven-time Cup champion backed during his

career, including educational & scholarship programs and wildlife preservation.

Although Dale Earnhardt, Jr had clinched the championship twice during his Grand National career, he had never won a GN race at the Talladega track. Using the same car that he had driven to victory at the February race at Daytona, Dale Jr qualified in third place on the starting grid. The race itself was packed with all the thrills that fans expect to see at the huge Alabama track, including a 21 car crash that Dale Jr managed to avoid.

Waiting until the very last moment to come in for their last pit stop, Dale Jr and the Chance 2 crew brought the specially painted Monte Carlo™ across the finish line first. In fact, they cut it so close that the car ran out of fuel on the cool down lap and had to be pushed into Victory Lane by a tow truck.

Another exciting and emotional victory for the Earnhardt family. The very next day, the Cup series combatants also took to the Talladega high banks. Yep, Dale Jr won that, too.



**\* REPEAT SEVERAL TIMES**  
 \* A REPETER PLUSIEURS FOIS



**\* OPTIONAL PARTS**  
 \* PIECES EN OPTION



**\* DECAL**  
 \* DECAL COMANIE



**\* ALTERNATIVE ASSEMBLY**  
 \* ENSEMBLAGE ALTERNATIVE



**\* CEMENT TOGETHER**  
 \* A COLLER



**\* REMOVE AND THROW AWAY**  
 \* A RETIRER ET JETER



**\* DO NOT CEMENT**  
 \* NE PAS COLLER

#### READ THIS BEFORE YOU BEGIN

- \* Study the assembly drawings.
- \* Each plastic part is identified by a number.
- \* In the assembly drawings, some parts will be marked by a star (★) to indicate chrome plated plastic.
- \* For better paint and decal adhesion, wash the plastic parts in a mild detergent solution. Rinse and let air dry.
- \* Check the fit of each piece before cementing in place.
- \* Use only cement for polystyrene plastic.
- \* Scrape plating and paint from areas to be cemented.
- \* Allow paint to dry thoroughly before handling parts.
- \* Any unused parts may be discarded.

#### DECAL APPLICATION INSTRUCTIONS

1. Cut desired decal from sheet.
2. Dip decal in water for a few seconds.
3. Place wet decal on paper towel.
4. Wait until decal is movable on paper backing.
5. Place decal in position on model, face up and slide backing away.
6. Press out air bubbles with a soft damp cloth.
7. Milkyness that may appear is for better decal adhesion and will dry clear. Wipe away any excess adhesive.
8. Do not touch decal until fully dry.
9. Allow the decals 48 hours to dry before applying clear coat.

**NOTE: Decals are compatible with setting solutions or solvents.**

#### LIRE CE QUI SUIT AVANT DE COMMENCER

- \* Etudier les schémas de montage.
- \* Chaque pièce en plastique est identifiée par un numéro.
- \* Sur les schémas de montage, certaines pièces sont marquées d'une étoile (★) pour indiquer qu'elles sont en plastique chromé.
- \* Pour une meilleure prise de la peinture et des autocollants, laver les pièces en plastique avec une solution détergente peu concentrée. Les rincer et les laisser sécher à l'air.
- \* Vérifier que chaque pièce s'ajuste bien avant de la coller en place.
- \* N'utiliser que de la colle pour polystyrène.
- \* Gratter les parties à coller pour enlever le chrome et la peinture.
- \* Laisser la peinture bien sécher avant de manipuler les pièces.
- \* Toute pièce inutilisée peut être jetée.

#### DIRECTIVES D'APPLICATION DES AUTOCOLLANTS

1. Découper l'autocollant désiré de la feuille.
2. Tremper l'autocollant dans de l'eau pendant quelques secondes.
3. Placer l'autocollant mouillé sur une serviette en papier.
4. Attendez que l'autocollant puisse être déplacé sur son support en papier.
5. Mettre l'autocollant en position sur le modèle face sur le dessus et faire glisser le support pour l'enlever.
6. Appuyer avec un chiffon doux humide pour éliminer les bulles d'air.
7. La substance laiteuse qui peut apparaître est destinée à améliorer l'adhésion de l'autocollant et devient incolore au séchage. Essuyer tout excédent d'adhésif.
8. Ne pas toucher l'autocollant tant qu'il n'est pas bien sec.
9. Laisser l'autocollant sécher pendant 48 heures avant d'appliquer une couche transparente.

**This paint guide is provided to complete this kit as shown on the box.**

*Ce guide de peinture est fourni pour reproduire le modèle réduit qui apparaît sur la boîte.*

<b>Aluminum</b>	<i>Aluminum</i>
<b>Flat Black</b>	<i>Noir mat</i>
<b>Flat White</b>	<i>Blanc mat</i>
<b>Flat Yellow</b>	<i>Jaune mat</i>
<b>Gloss Black</b>	<i>Noir brillant</i>
<b>Gloss Red</b>	<i>Rouge brillant</i>
<b>Gloss White</b>	<i>Blanc brillant</i>
<b>Light Gray</b>	<i>Gris clair</i>
<b>Satin White</b>	<i>Blanc satiné</i>
<b>Semigloss Black</b>	<i>Noir satiné</i>
<b>Silver</b>	<i>Argent</i>
<b>Steel</b>	<i>Acier</i>

**If you have any questions or comments, call our hotline at: (800) 833-3570 or, please write to:**

**Revell-Monogram Consumer Service Department, 8601 Waukegan Road, Morton Grove, Illinois 60053**

*Be sure to include the plan number (85284400200), part number, description, your return address and phone number.*

**Visit our website: [www.revell-monogram.com](http://www.revell-monogram.com)**

# 1

# ENGINE ASSEMBLY

**A** \* **NOTE: BEND PLUG WIRES SO THAT LONG TABS ON WIRES FIT INTO DEPRESSIONS ON CYLINDER HEADS**

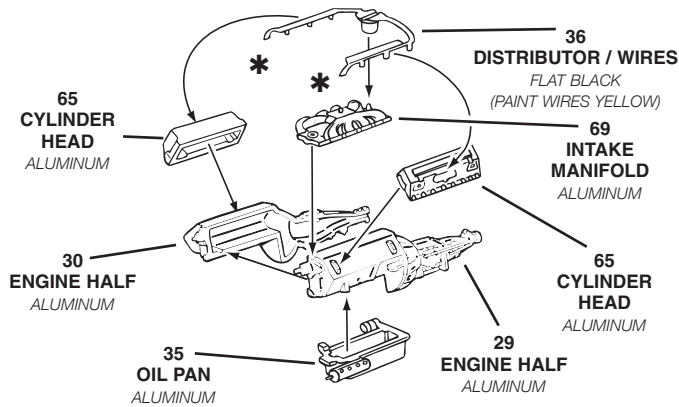

**B**

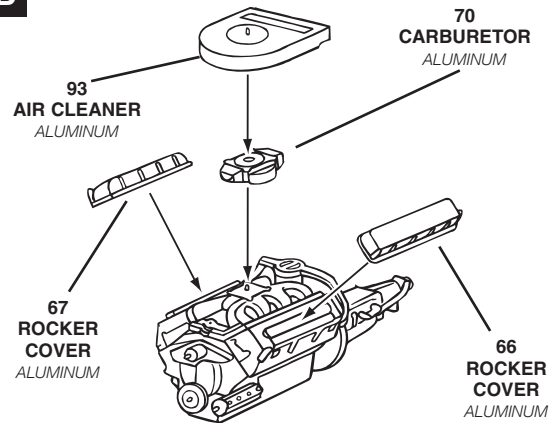

**C**

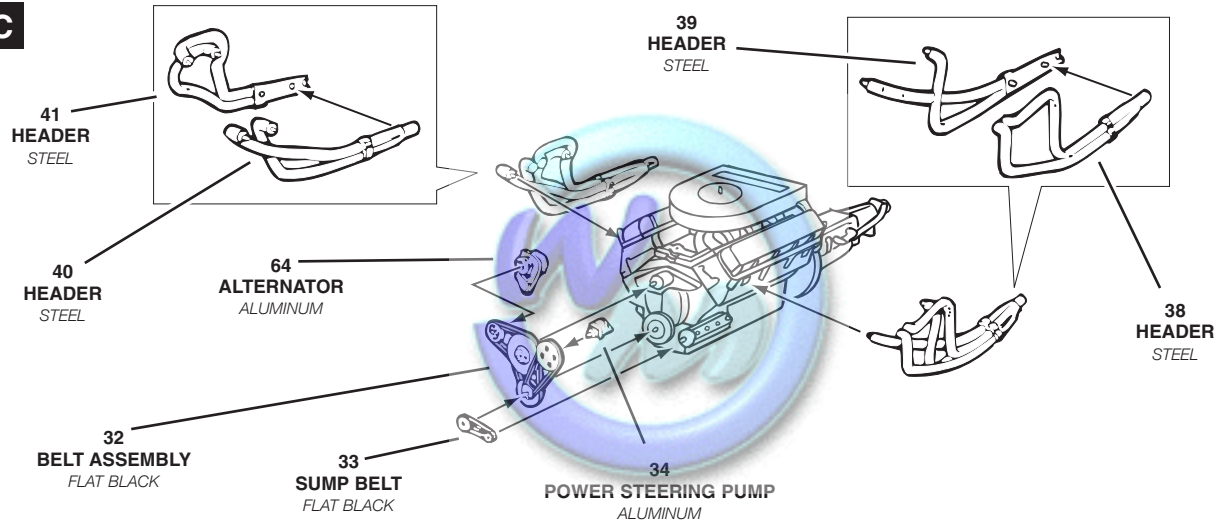

# 2

# CHASSIS AND INTERIOR ASSEMBLY

**A**

**NOTE: LEAVE SUPPORT STRAP IN PLACE UNTIL STEP 4A**

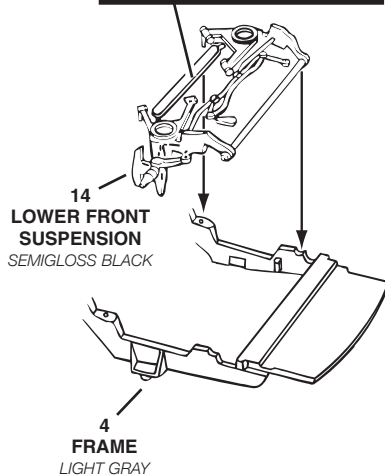

**B**

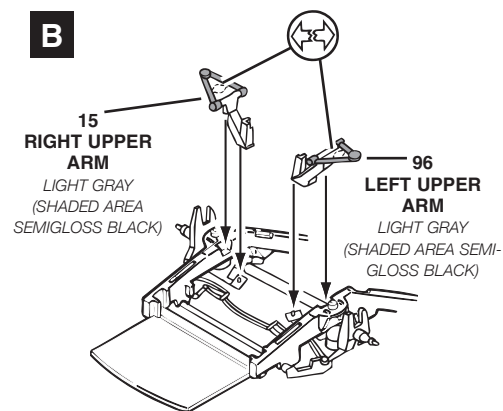

**C**

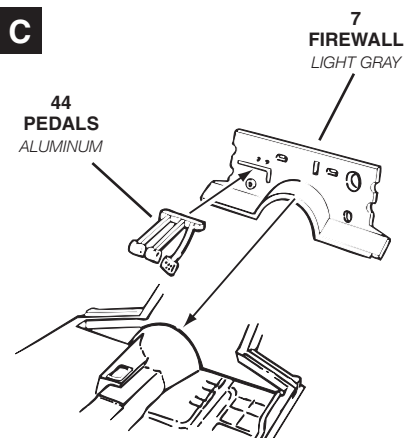

## 2

## CHASSIS AND INTERIOR ASSEMBLY CONTINUED

D

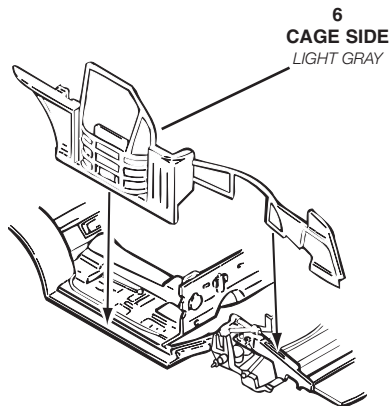

E

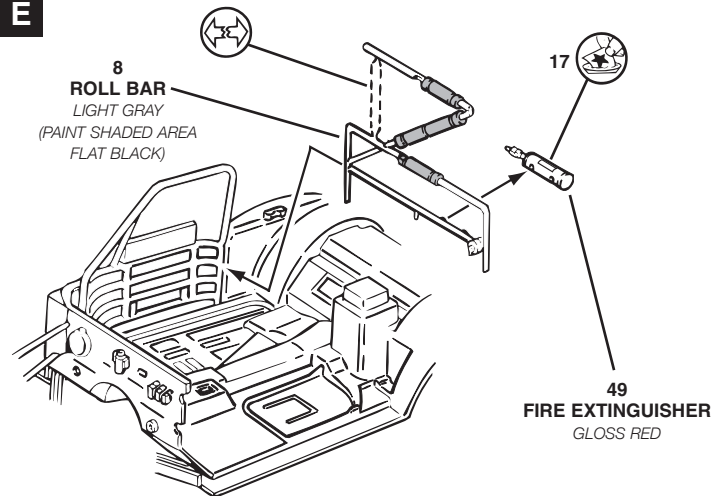

F

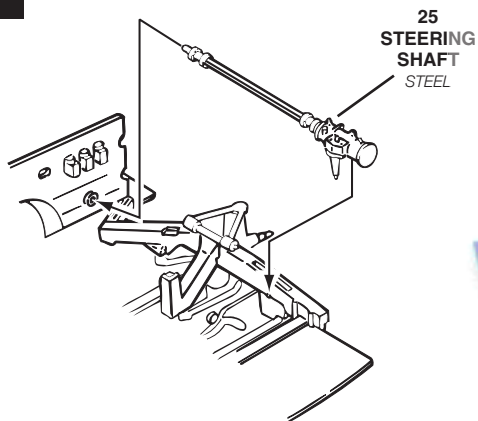

G

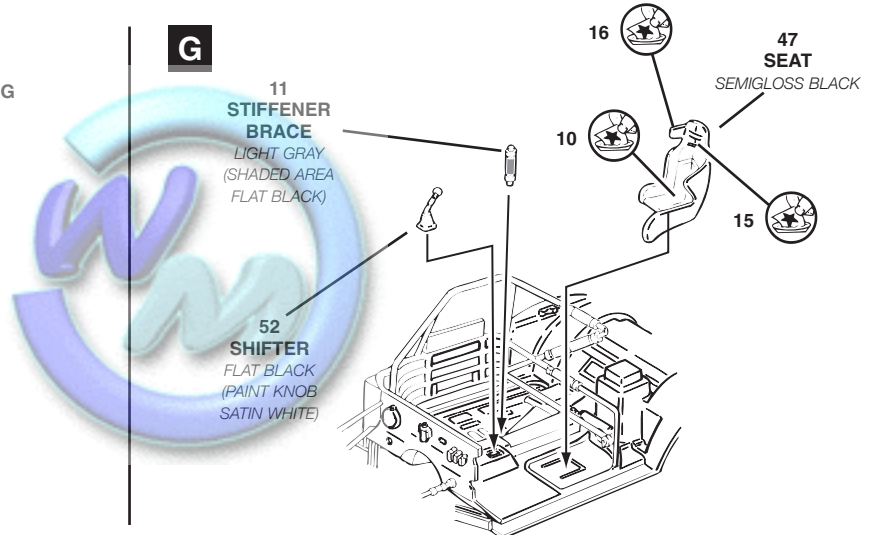

H

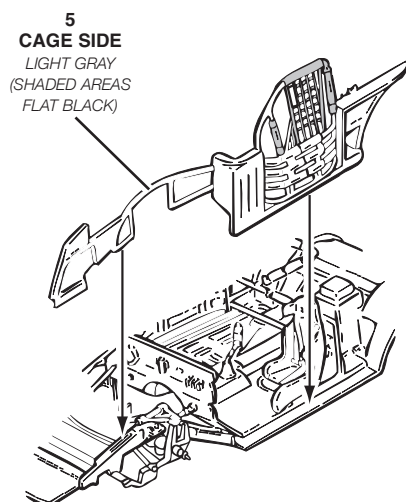

I

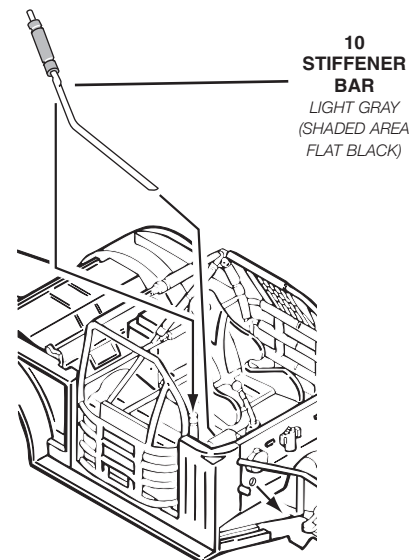

# 2

## CHASSIS AND INTERIOR ASSEMBLY CONTINUED

**J**

57  
**PETTY BAR**  
LIGHT GRAY

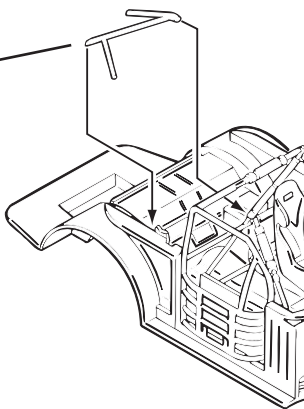

**K**

50  
**HOSE**  
FLAT BLACK

48  
**HOSE**  
FLAT BLACK

51  
**HOSE**  
FLAT BLACK

61  
**HOSE**  
FLAT BLACK

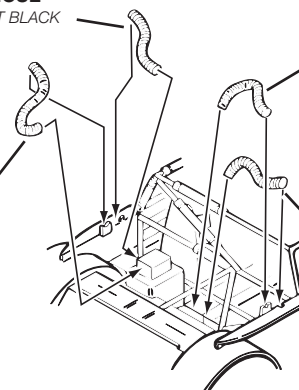

**L**

73  
**TOP STIFFENER BAR**  
LIGHT GRAY  
(SHADED AREA FLAT BLACK) **FIRST**

9  
**TOP BRACE**  
LIGHT GRAY  
(SHADED AREA FLAT BLACK) **SECOND**

72  
**MIRROR**  
FLAT BLACK  
(MIRROR FACE SILVER)

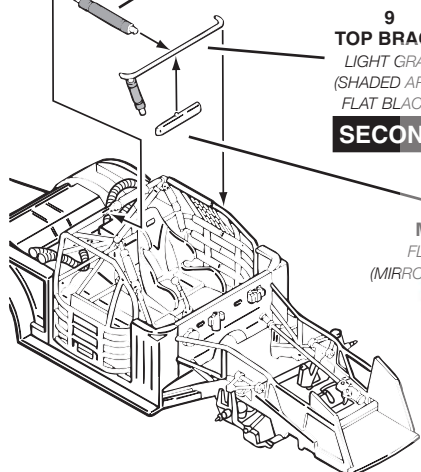

**M**

56  
**REAR SHELF**  
SEMIGLOSS BLACK  
**THIRD**

12  
**KICKER BAR ASSEMBLY**  
LIGHT GRAY  
**SECOND**

13  
**FUEL CELL**  
LIGHT GRAY  
(PAINT SHADED AREA ALUMINUM)  
**FIRST**

92  
**REAR SUSPENSION ADJUSTMENT TUBES**  
LIGHT GRAY

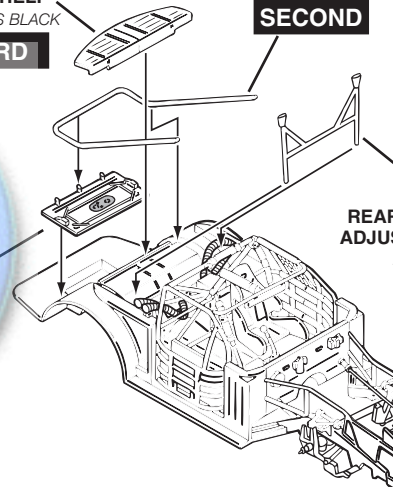

# 3

## SUSPENSION AND CHASSIS ASSEMBLY

**A**

59  
**OILER TANK**  
ALUMINUM

22  
**SHOCK ASSEMBLY**  
LIGHT GRAY  
(SHADED AREA ALUMINUM)

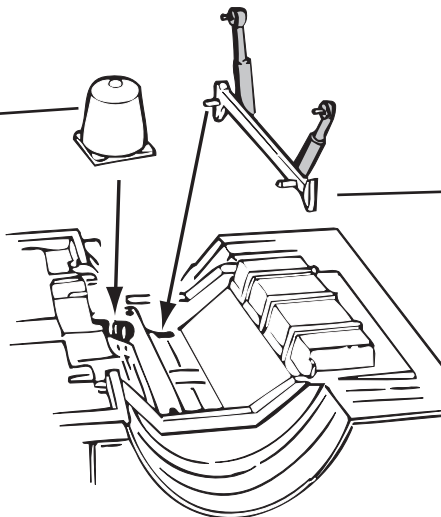

# 3

## SUSPENSION AND CHASSIS ASSEMBLY CONTINUED

**B**

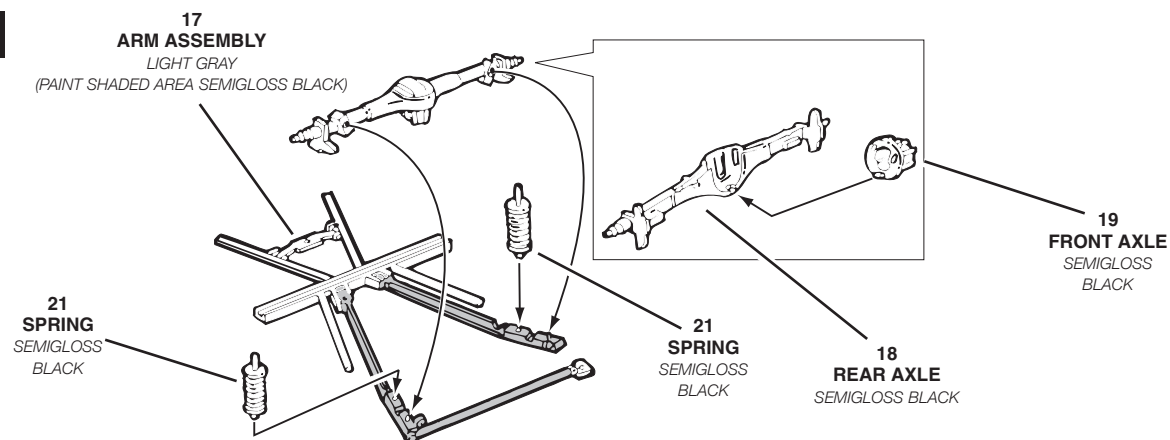

**C**

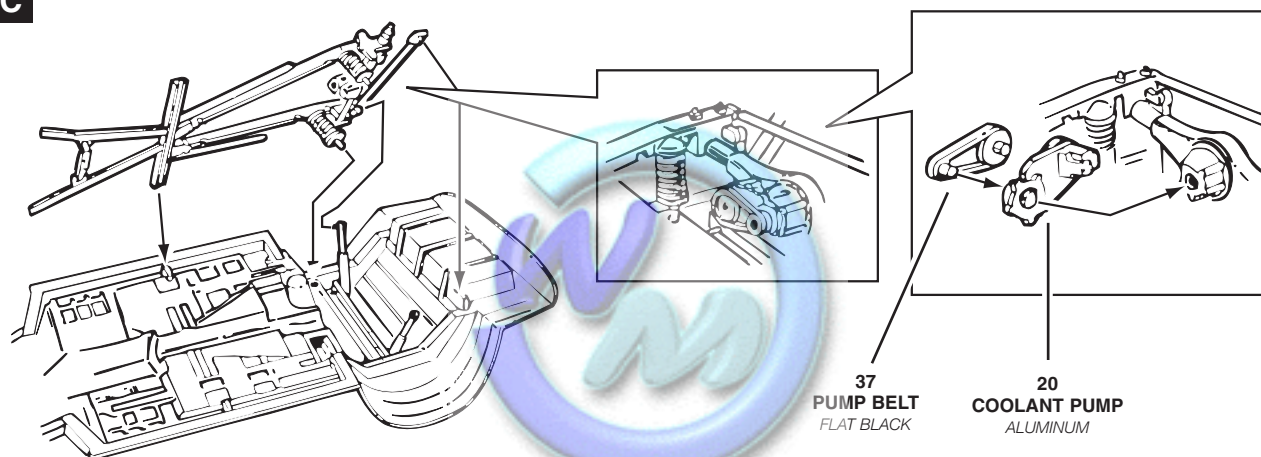

# 4

## CHASSIS DETAIL ASSEMBLY

**A**

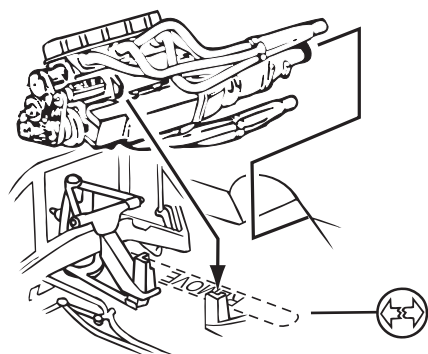

**B**

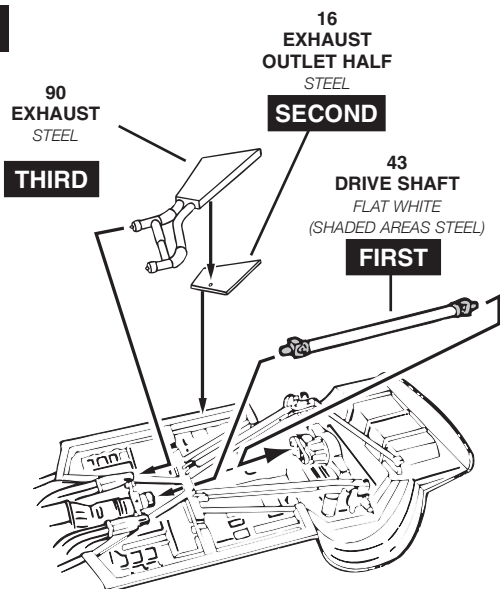

# 4

# CHASSIS DETAIL ASSEMBLY CONTINUED

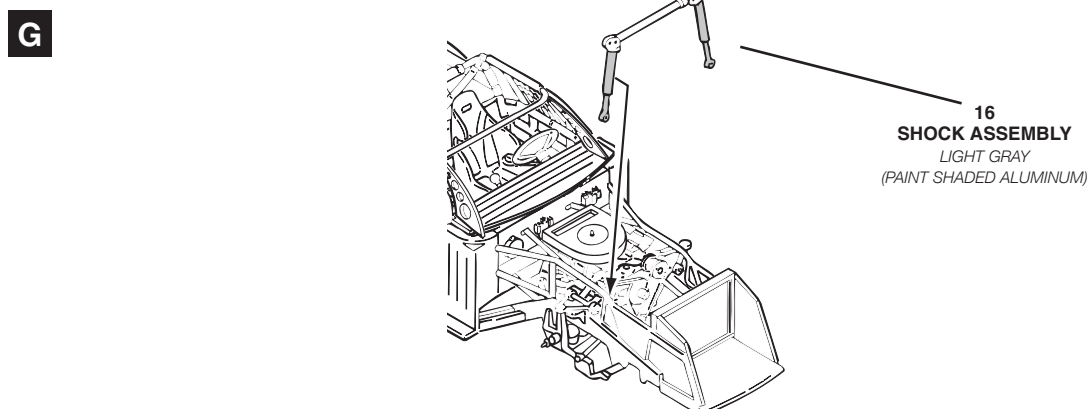
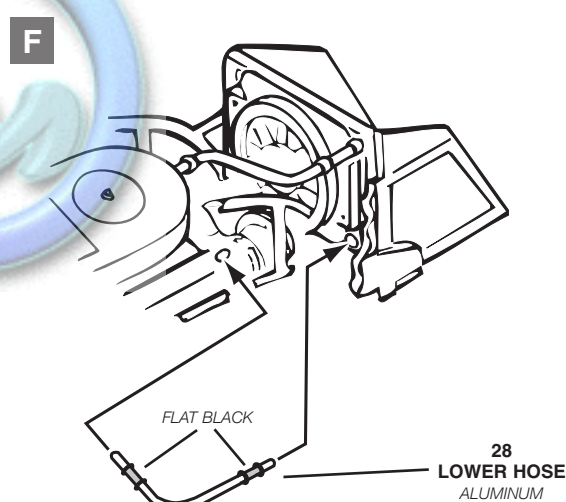
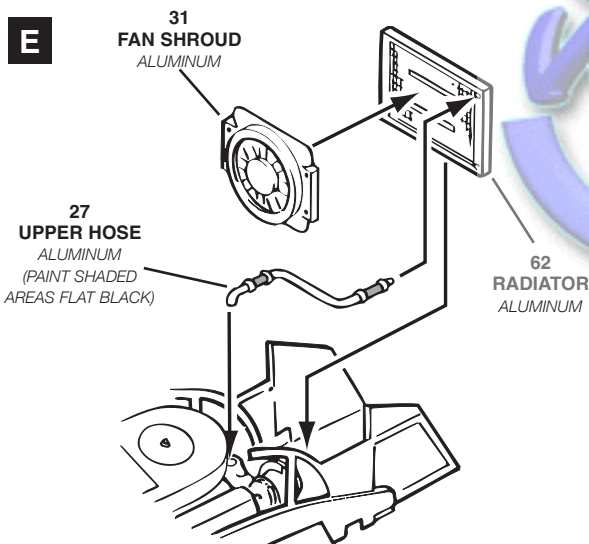
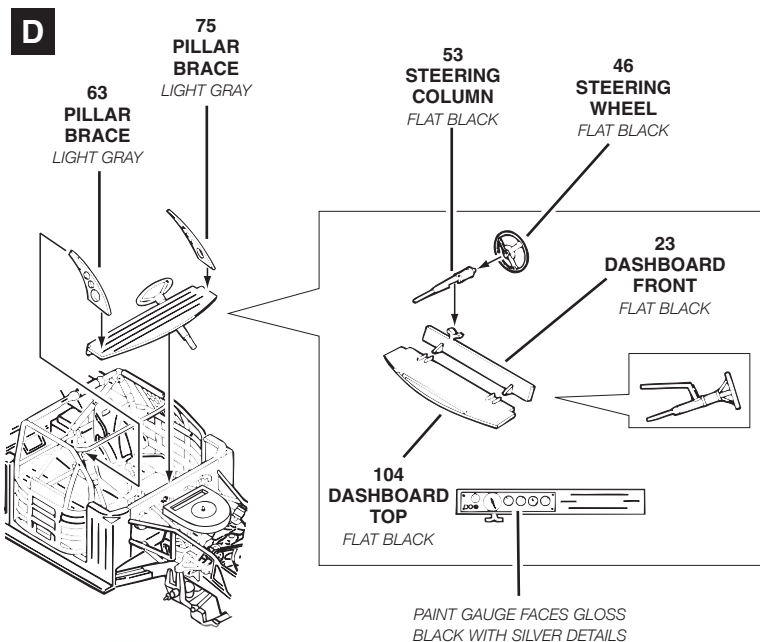
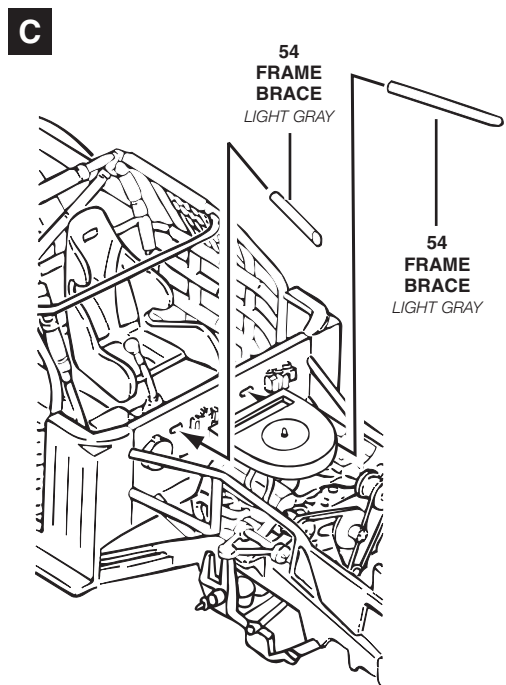

# 5

# FINAL ASSEMBLY

**A**

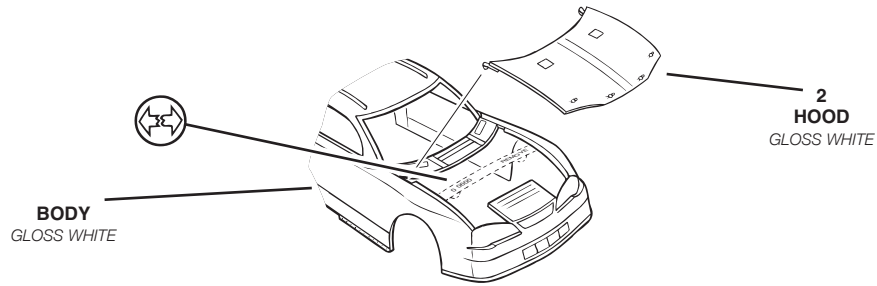

**B**

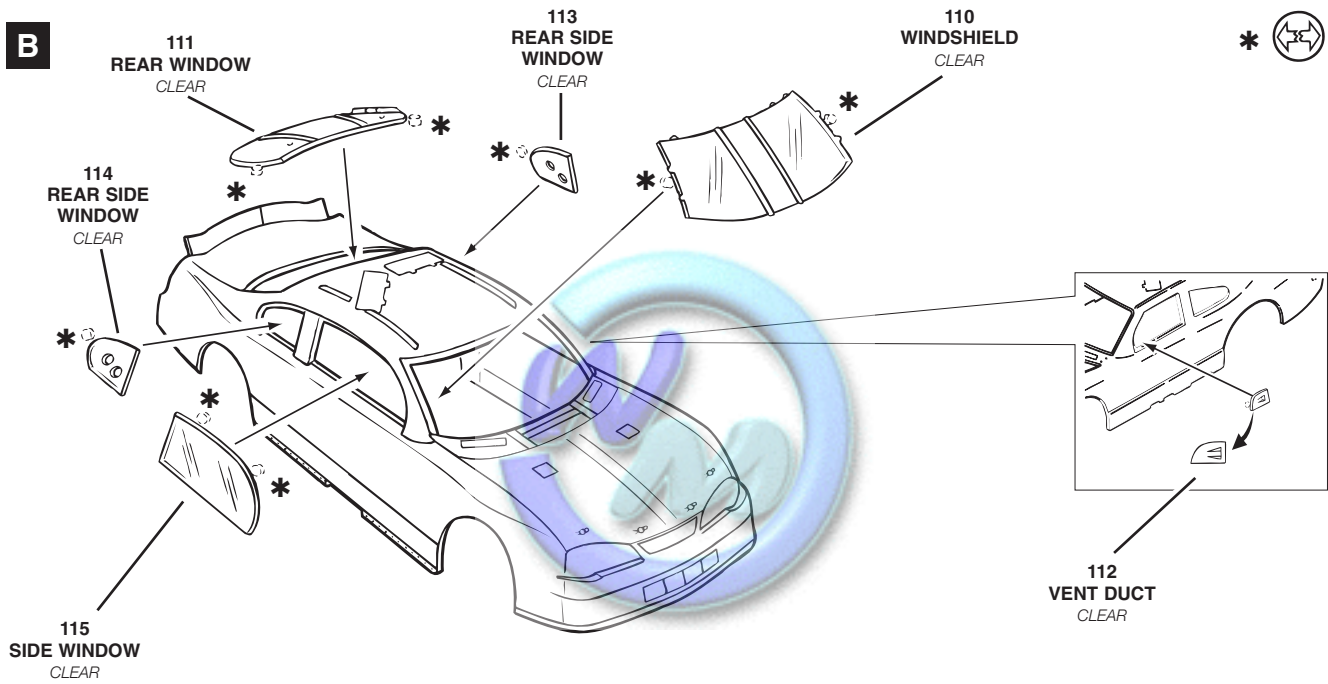

**NOTE: PAINT ALL WINDOW TRIM SEMIGLOSS BLACK**

**C**

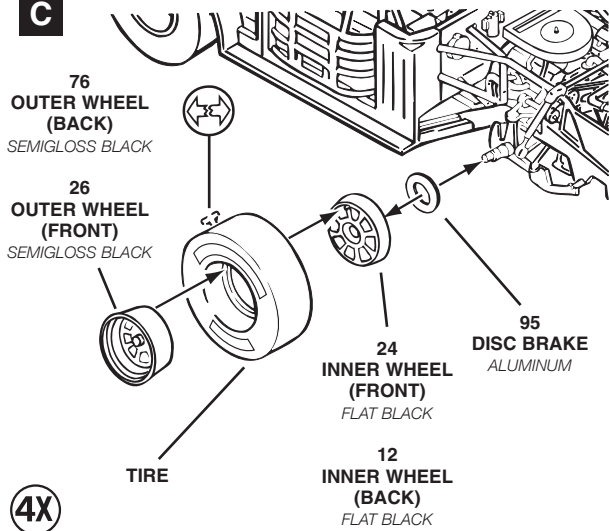

**D**

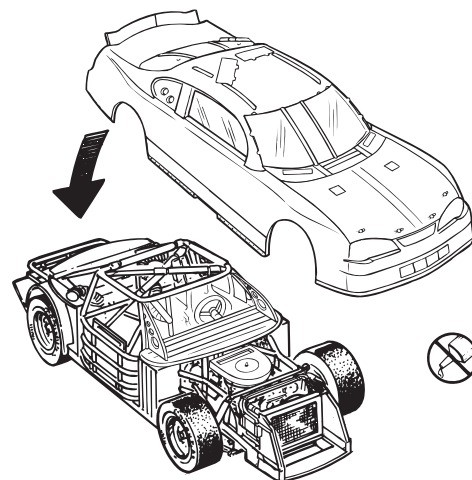

# 6

# DECAL PLACEMENT



**NOTE: DECALS 1,2,31, AND 32, MUST BE APPLIED FIRST**

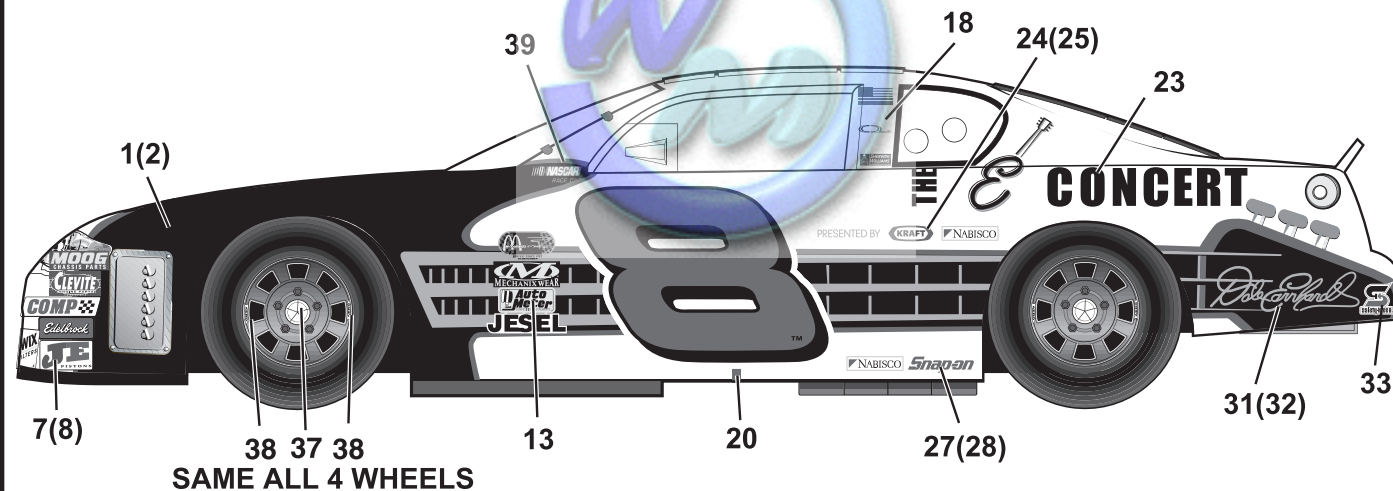
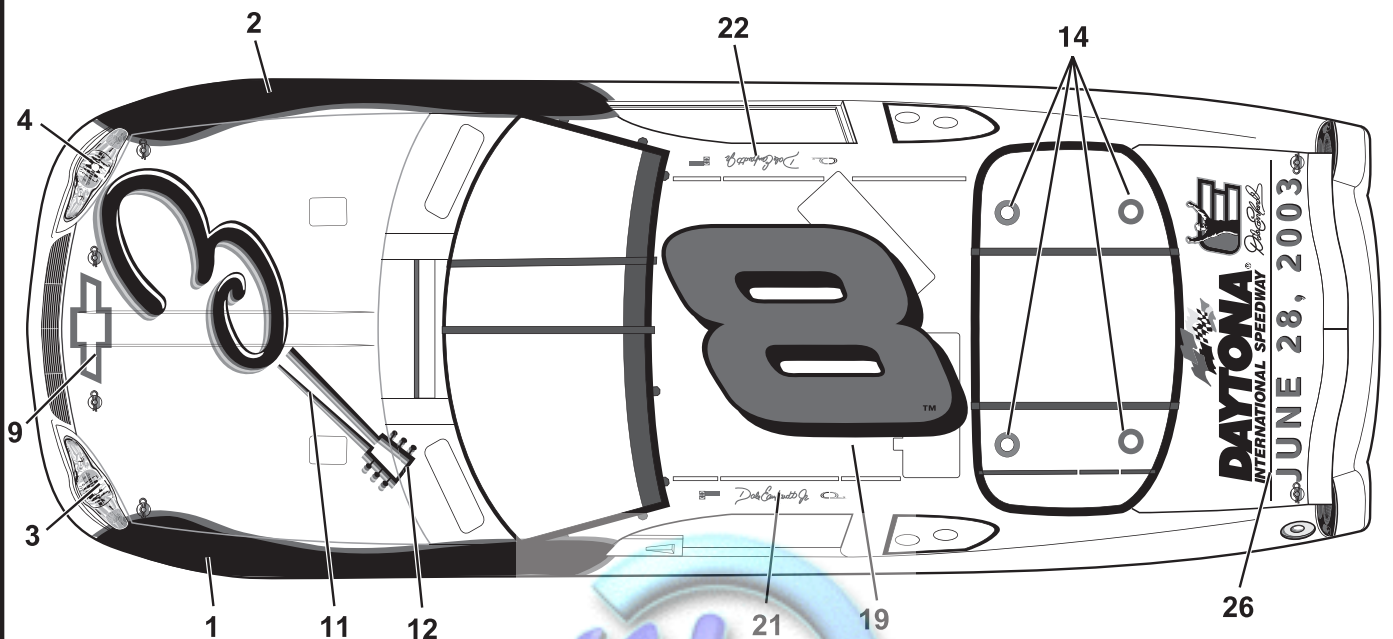

(X)=OPPOSITE SIDE

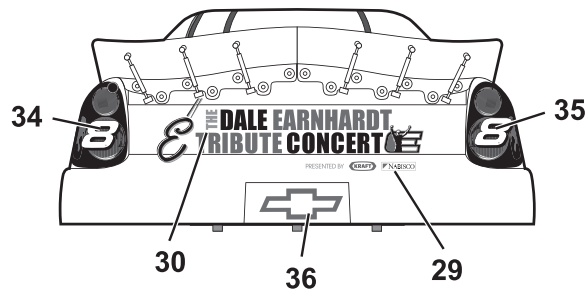
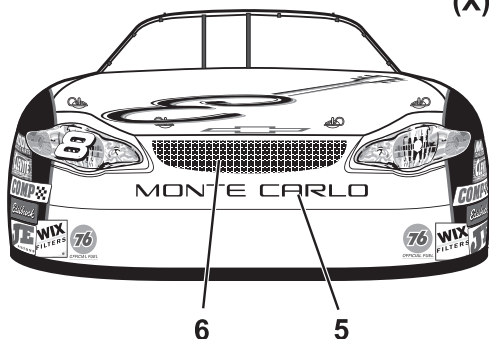

10 15 16 17 FOR INTERIOR USE