



KIT 2016

85201600200

CORVETTE C6-R

Here is a quick summary of the 2005 season results in the GT1 class of the American LeMans Series: Corvette® C6R™. The factory-backed two car team simply blew everyone else away with 10 wins in 11 races. In nine of those ten races, the two team cars finished first and second. During the first race of the season, which was the only race that the Corvette team did not win, they finished second and third. So for the most part, about the only time the other competitors saw the front end of either the #3 or #4 Corvette C6R race cars was in their rear view mirrors... just before they passed by. Much of the same engineering that went into making the street-legal version of the sixth generation Corvette such a blast to drive can be found in the C6R, as well. However, this kind of design prowess is nothing new, especially when you realize that Corvettes have scored One-Two finishes four

of the last five years of the grueling 24 Hours of Lemans. These guys know what they're doing. The Revell model kit that you will soon start building is a scale version of the C6R that features a 7 liter V-8 engine with a dry-sump lubrication system, CNC-ported cylinder heads, titanium valves and connecting rods and a forged steel crankshaft. Add the driving talent the team brought on board-Ron Fellows, Johnny O'Connell and Max Papis in the #3 car, Oliver Gavin, Olivier Baretta and Jan Magnussen in the #4 car and it's easy to see why there was a yellow Corvette in the lead most of the time.

In a total team effort for 2005 they won the ALMS GT1 Manufacturers Championship, the Drivers Championship, the Team Championship and the Pit Crew Championship. Was there anything else this unbeatable team could have won in 2005? We don't think so!



* REPEAT SEVERAL TIMES
* A REPETER PLUSIEURS FOIS



* OPTIONAL PARTS
* PIECES EN OPTION



* DECAL
* DECAL COMANIE



* ALTERNATIVE ASSEMBLY
* ENSEMBLAGE ALTERNATIVE



* CEMENT TOGETHER
* A COLLER



* REMOVE AND THROW AWAY
* A RETIRER ET JETER



* DO NOT CEMENT
* NE PAS COLLER

READ THIS BEFORE YOU BEGIN

- * Study the assembly drawings.
- * Each plastic part is identified by a number.
- * In the assembly drawings, some parts will be marked by a star (★) to indicate chrome plated plastic.
- * For better paint and decal adhesion, wash the plastic parts in a mild detergent solution. Rinse and let air dry.
- * Check the fit of each piece before cementing in place.
- * Use only cement for polystyrene plastic.
- * Scrape plating and paint from areas to be cemented.
- * Allow paint to dry thoroughly before handling parts.
- * Any unused parts may be discarded.

DECAL APPLICATION INSTRUCTIONS

1. Cut desired decal from sheet.
2. Dip decal in water for a few seconds.
3. Place wet decal on paper towel.
4. Wait until decal is movable on paper backing.
5. Place decal in position on model, face up and slide backing away.
6. Press out air bubbles with a soft damp cloth.
7. Milkyness that may appear is for better decal adhesion and will dry clear. Wipe away any excess adhesive.
8. Do not touch decal until fully dry.
9. Allow the decals 48 hours to dry before applying clear coat.

NOTE: Decals are compatible with setting solutions or solvents.

LIRE CE QUI SUIT AVANT DE COMMENCER

- * Etudier les schémas de montage.
- * Chaque pièce en plastique est identifiée par un numéro.
- * Sur les schémas de montage, certaines pièces sont marquées d'une étoile (★) pour indiquer qu'elles sont en plastique chromé.
- * Pour une meilleure prise de la peinture et des autocollants, laver les pièces en plastique avec une solution détergente peu concentrée. Les rincer et les laisser sécher à l'air.
- * Vérifier que chaque pièce s'ajuste bien avant de la coller en place.
- * N'utiliser que de la colle pour polystyrène.
- * Gratter les parties à coller pour enlever le chrome et la peinture.
- * Laisser la peinture bien sécher avant de manipuler les pièces.
- * Toute pièce inutilisée peut être jetée.

DIRECTIVES D'APPLICATION DES AUTOCOLLANTS

1. Découper l'autocollant désiré de la feuille.
2. Tremper l'autocollant dans de l'eau pendant quelques secondes.
3. Placer l'autocollant mouillé sur une serviette en papier.
4. Attendez que l'autocollant puisse être déplacé sur son support en papier.
5. Mettre l'autocollant en position sur le modèle face sur le dessus et faire glisser le support pour l'enlever.
6. Appuyer avec un chiffon doux humide pour éliminer les bulles d'air.
7. La substance laiteuse qui peut apparaître est destinée à améliorer l'adhésion de l'autocollant et devient incolore au séchage. Essuyer pour enlever tout excédent d'adhésif.
8. Ne pas toucher l'autocollant tant qu'il n'est pas bien sec.
9. Laisser l'autocollant sécher pendant 48 heures avant d'appliquer une couche transparente.

REMARQUE: Les autocollants sont compatibles avec les solutions de fixation ou les solvants.

This paint guide is provided to complete this kit as shown on the box.

Ce guide de peinture est fourni pour reproduire le modèle réduit qui apparaît sur la boîte.

Aluminum	Aluminum
Flat Black	Noir mat
Gloss Black	Noir lustré
Semigloss White	Blanc lustré
Gunmetal	Bronze
Flat Red	Rouge mat
Semigloss Black	Noir satin
Steel	Acier
Chrome	Chrome
Gloss Yellow	Jaune Brillant
Light Blue	Bleu clair
Transparent Red	Rouge transparent
Turn Signal Amber	ambre transparent

If you have any questions or comments, call our hotline at: **(800) 833-3570**
or, please write to:

Revell-Monogram Consumer Service Department, 725 Landwehr Road, Northbrook, Illinois 60062

Be sure to include the plan number (85201600200), part number, description, your return address and phone number.

Visit our website: www.revell.com

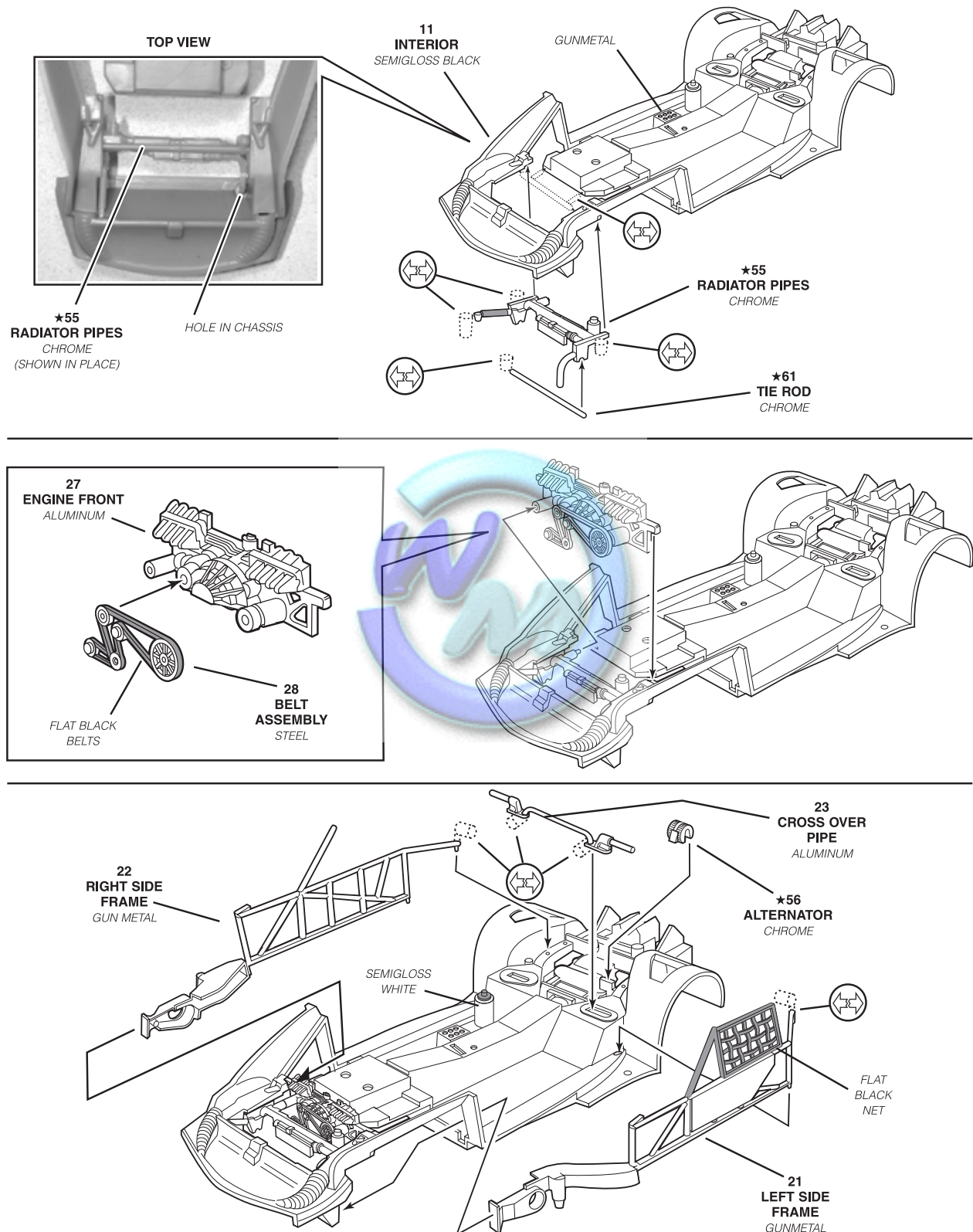
1**FRAME / ENGINE ASSEMBLY**

2

SEAT / INTERIOR ASSEMBLY

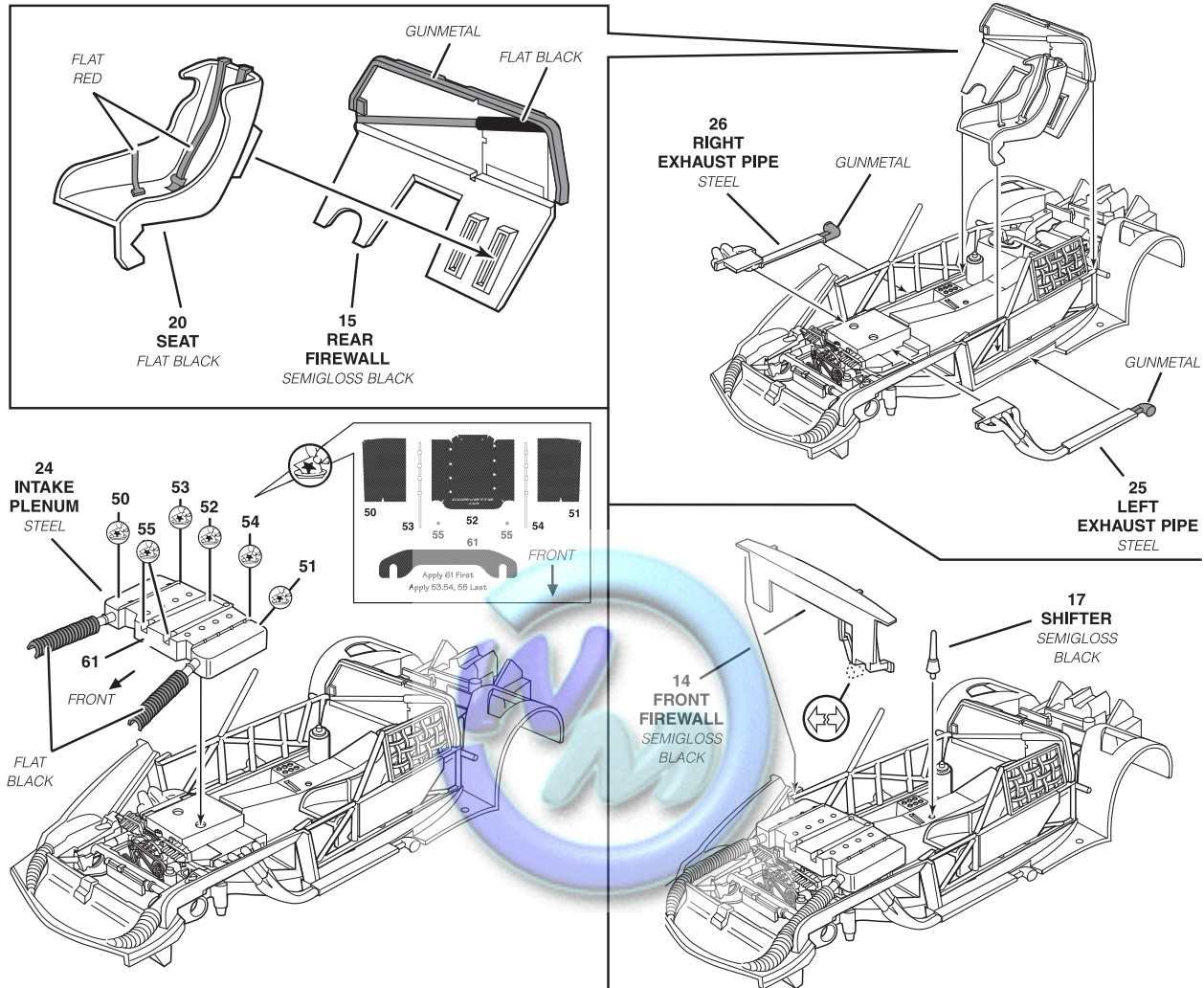

3

DASH / OIL TANK ASSEMBLY

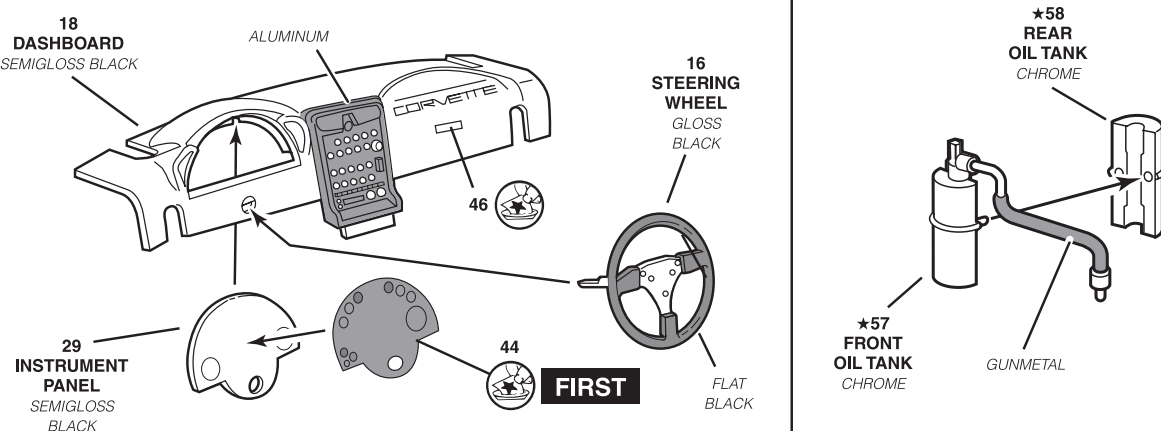

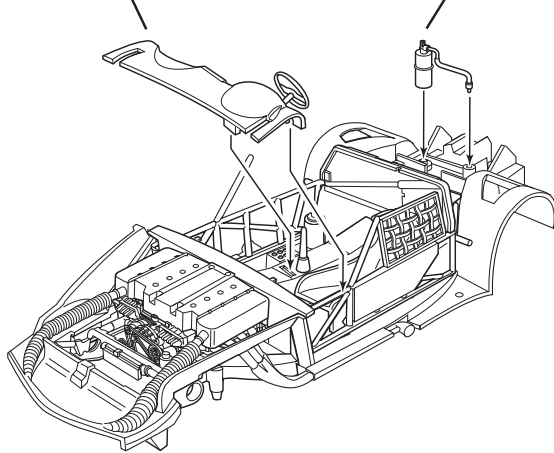
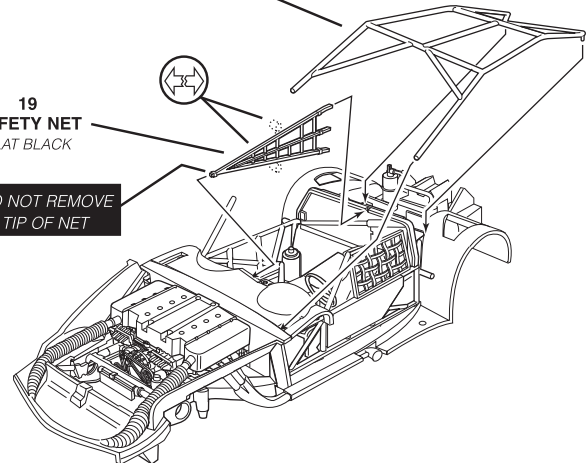
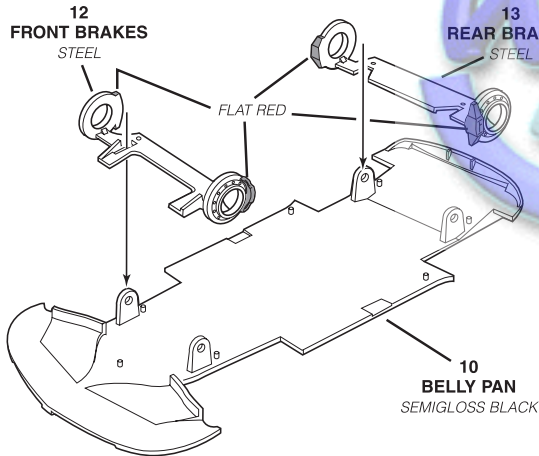
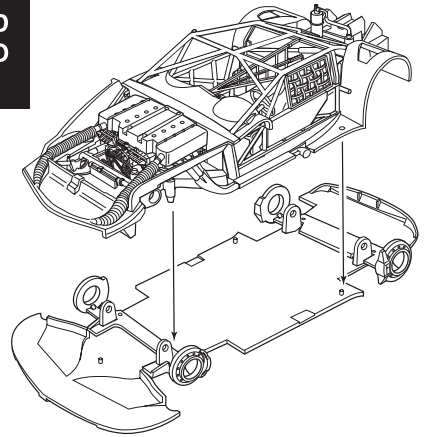
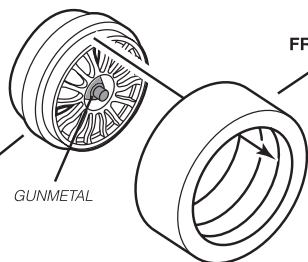
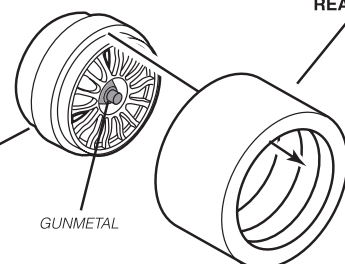
4***DASH / TANK / CAGE ASSEMBLY*****COMPLETED
DASH****COMPLETED
OIL TANK****30
CAGE TOP
GUNMETAL****19
SAFETY NET
FLAT BLACK****DO NOT REMOVE
TIP OF NET****5*****BRAKE ASSEMBLY*****12
FRONT BRAKES
STEEL****13
REAR BRAKES
STEEL****FLAT RED****COMPLETED
INTERIOR TO
PAN****10
BELLY PAN
SEMIGLOSS BLACK****6*****WHEEL ASSEMBLY*****FRONT****(2X)****FRONT TIRE*****59
FRONT WHEEL
CHROME****GUNMETAL****REAR****(2X)****REAR TIRE*****60
REAR WHEEL
CHROME****GUNMETAL**

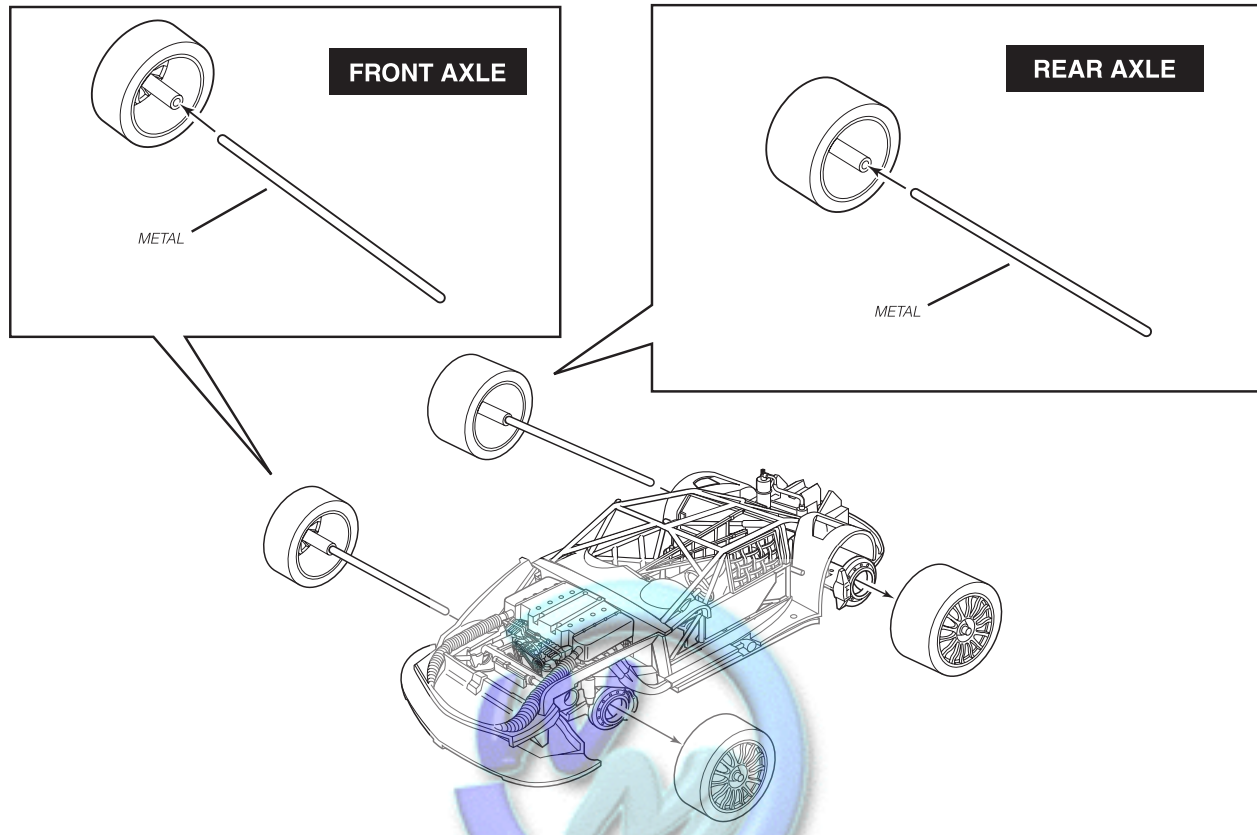
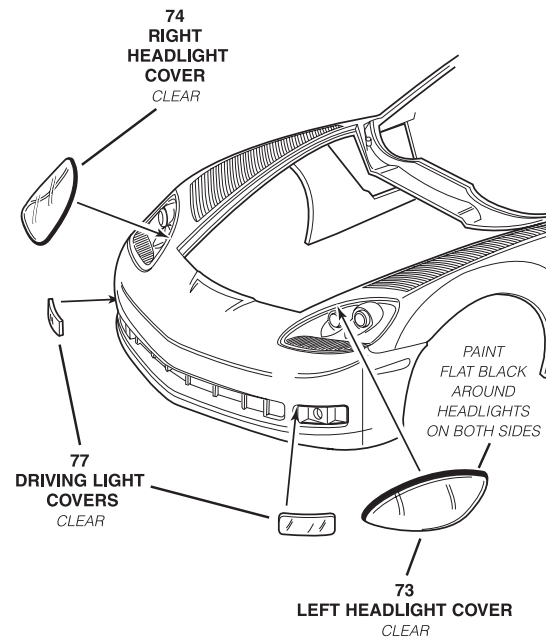
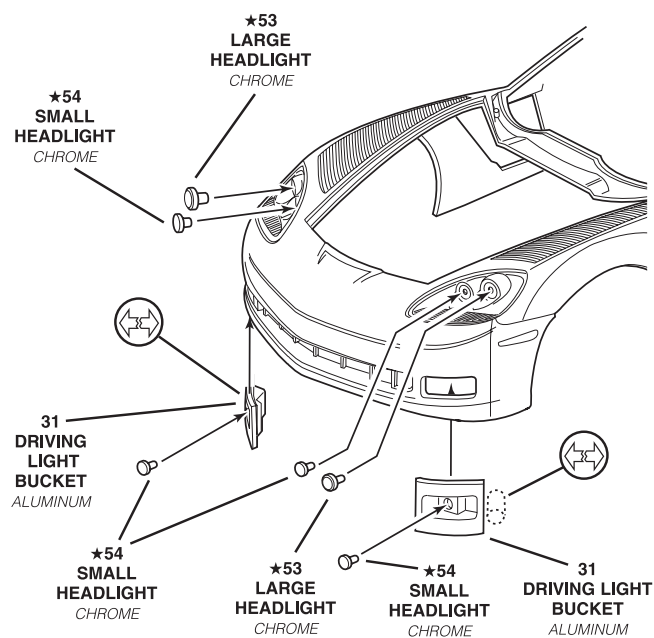
6**WHEEL ASSEMBLY CONTINUED****7****FRONT ASSEMBLY**

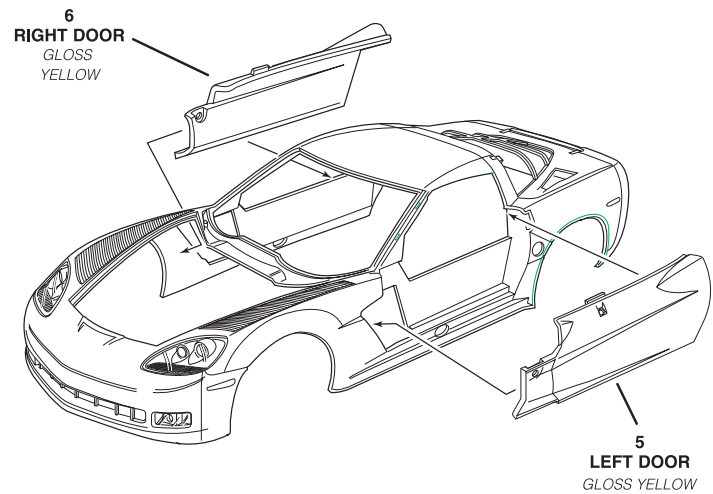
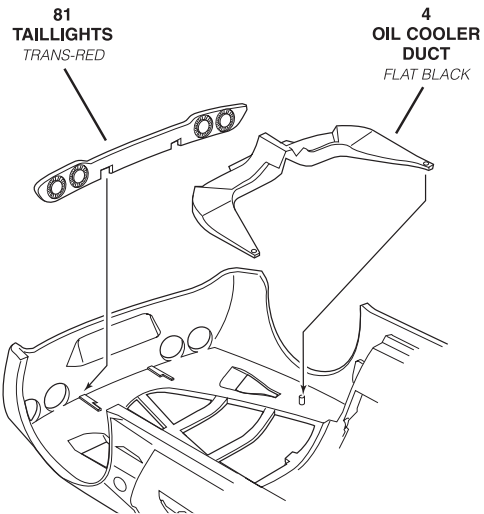
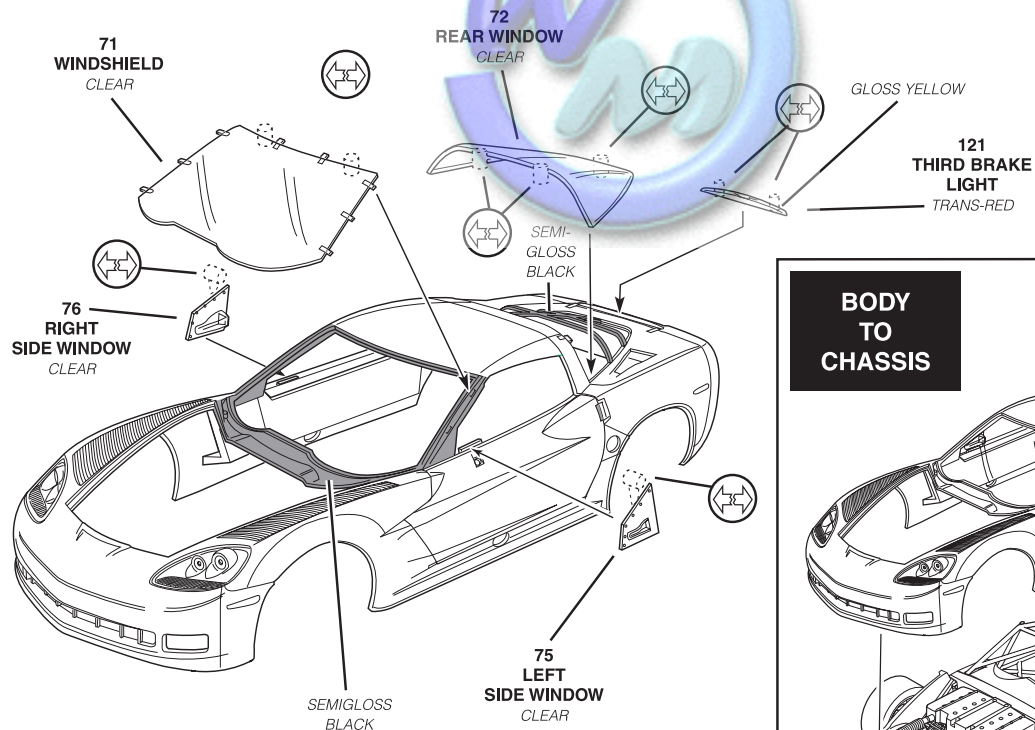
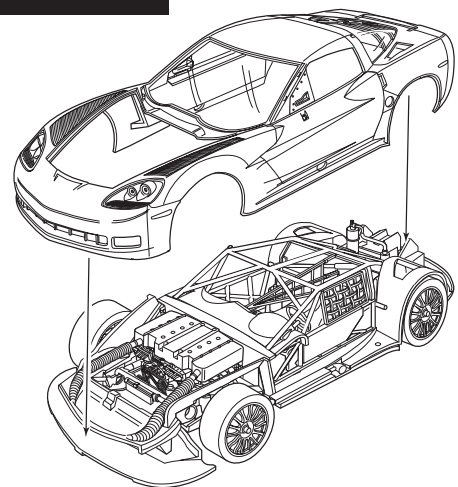
8**REAR / SIDE PANEL ASSEMBLY****9****WINDOW ASSEMBLY****BODY
TO
CHASSIS**

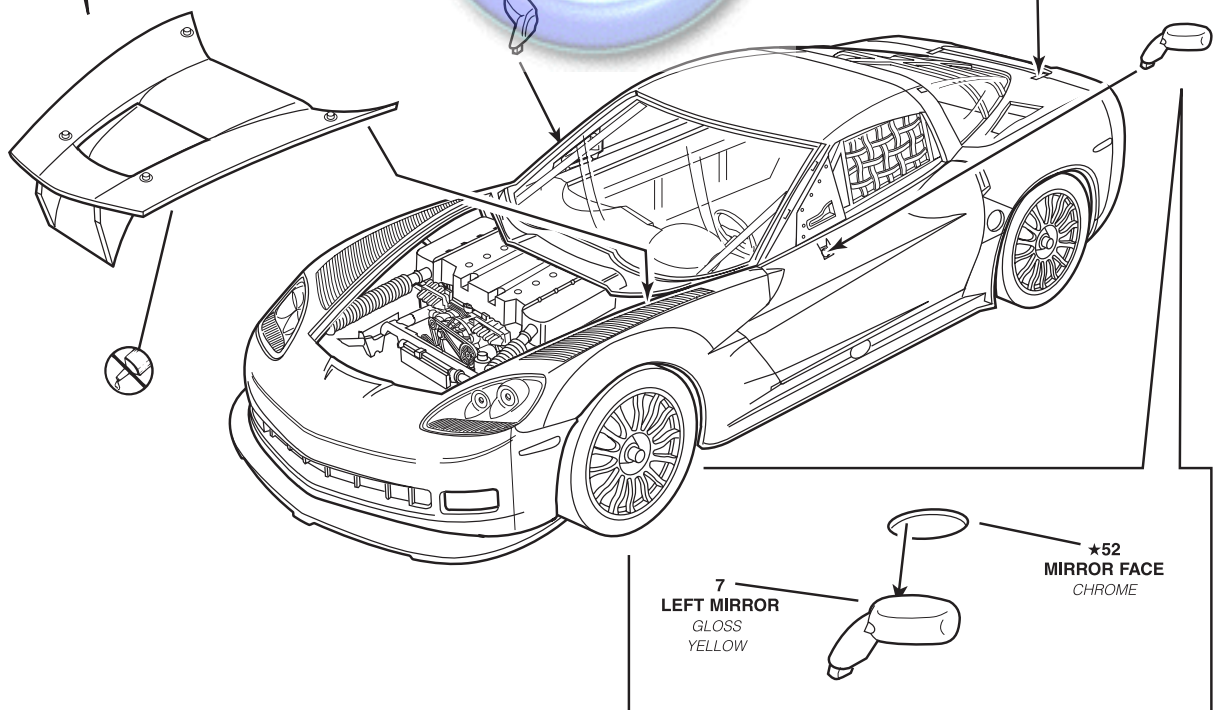
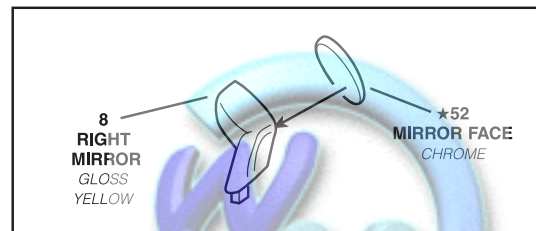
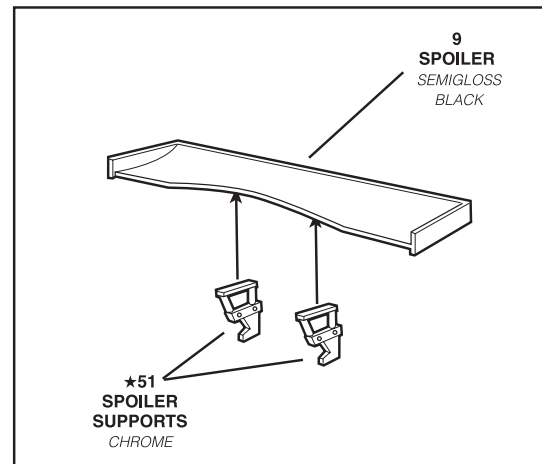
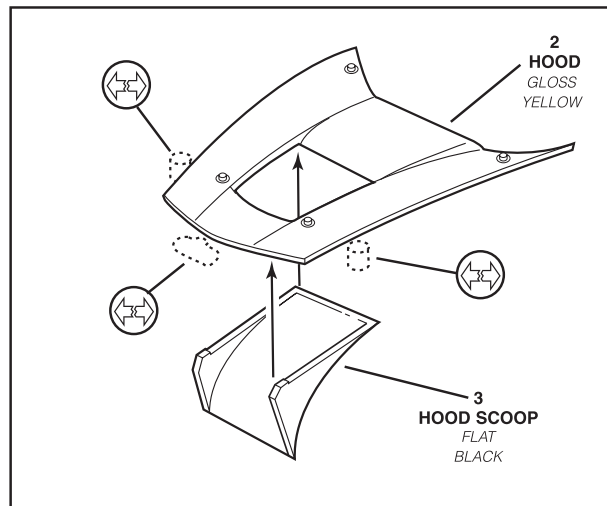
10**FINAL ASSEMBLY**

11

DECAL PLACEMENT

24 HOURS OF LEMANS VERSION 2005

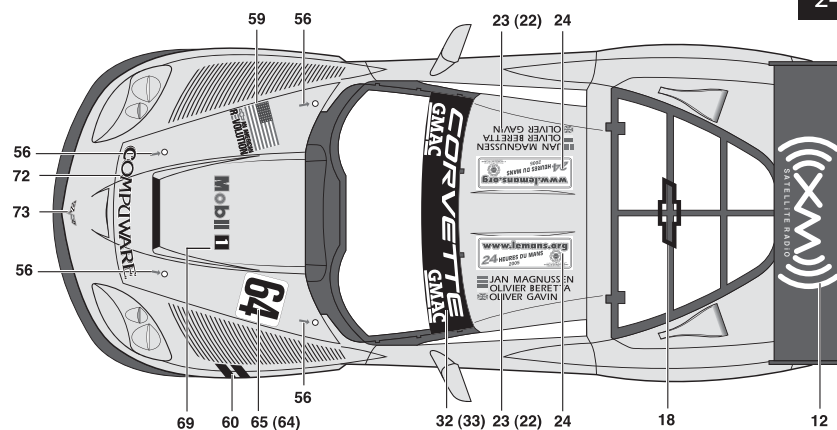
**Building Note:**

Apply Decals **#38** before attaching the mirrors on right and left sides.

Building Note:

To make the Le Mans **C6R #63** version, substitute the decals shown in parenthesis.

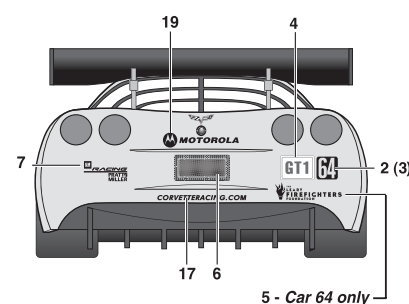
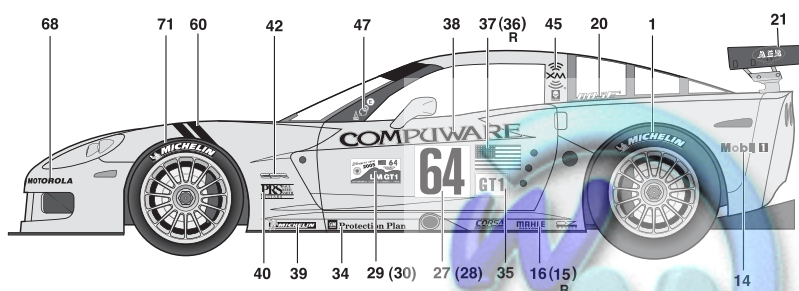

5 - Car 64 only

ALMS RACING VERSION 2005

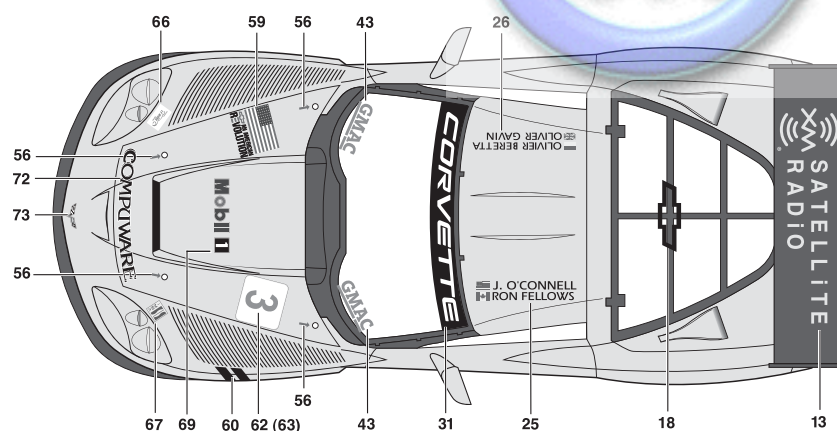
**Building Note:**

Apply Decals **#38** before attaching the mirrors on right and left sides.

Building Note:

To make the **ALMS C6R #4** version, substitute the decals shown in parenthesis.

