

Revell®

KIT 1441

85144100200

Chevrolet® L89

Big Block Engine

First Introduced in 1966 with its aluminum cylinder heads and triple carburetors, the huge Turbo-Jet 427 L-89 V8 was one of the most feared high performance engines on the drag strip! With a bore of 4.25 cubic inches and power ratings said to be conservative, the fire breathing L89 pumps out over 435 hp and 460 ft-lbs of torque! Painted in authentic factory "Chevy Orange" with simulated aluminum heads, this brute is loaded with details like realistic spark plug wires, vacuum hoses, fuel lines, chrome valve covers and a removable air filter! Your 1/6th Revell Chevrolet® L89 Big Block Engine kit includes rubber belts to connect all moving parts, so that when you turn the flywheel, the starter, alternator, fan and pulleys all rotate at the same time! It's so true to life you'll almost want to put gas in it and fire it up!

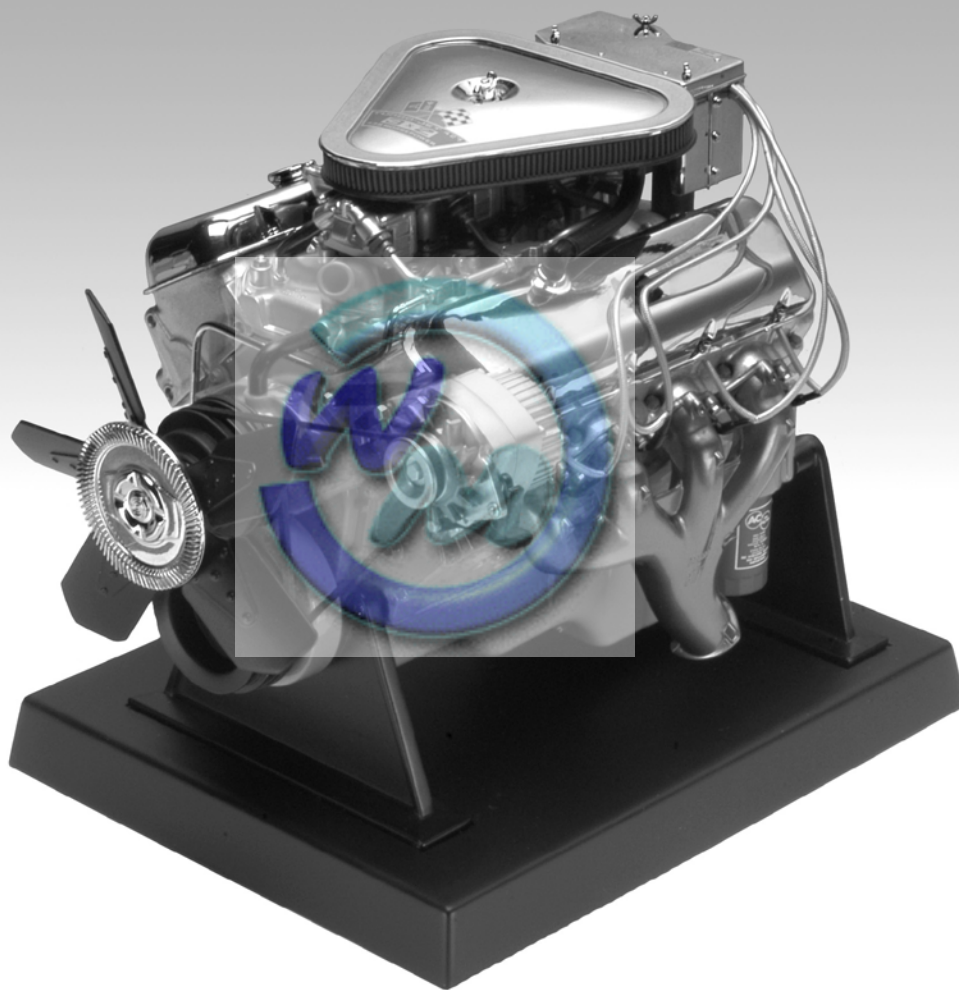

* REPEAT SEVERAL TIMES
* A REPETER PLUSIEURS FOIS



* CEMENT TOGETHER
* A COLLER



* DO NOT CEMENT
* NE PAS COLLER

If you have any questions or comments, call our hotline at: **(800) 833-3570**
or, please write to:

Revell-Monogram Consumer Service Department, 725 Landwehr Road, Northbrook, Illinois 60062

Be sure to include the plan number (85144100200), part number, description, your return address and phone number.

Visit our website: www.revell.com

1

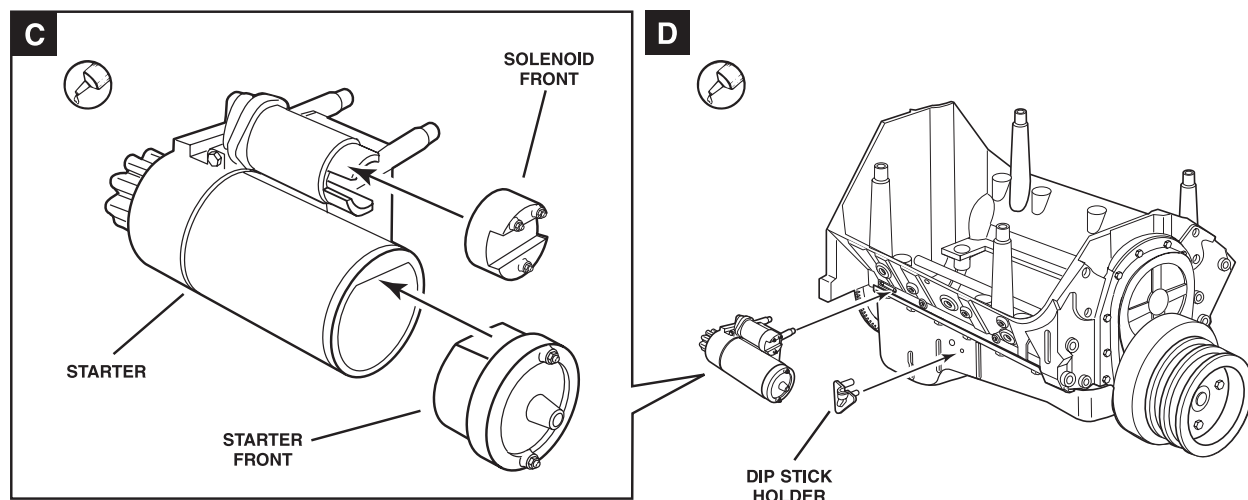
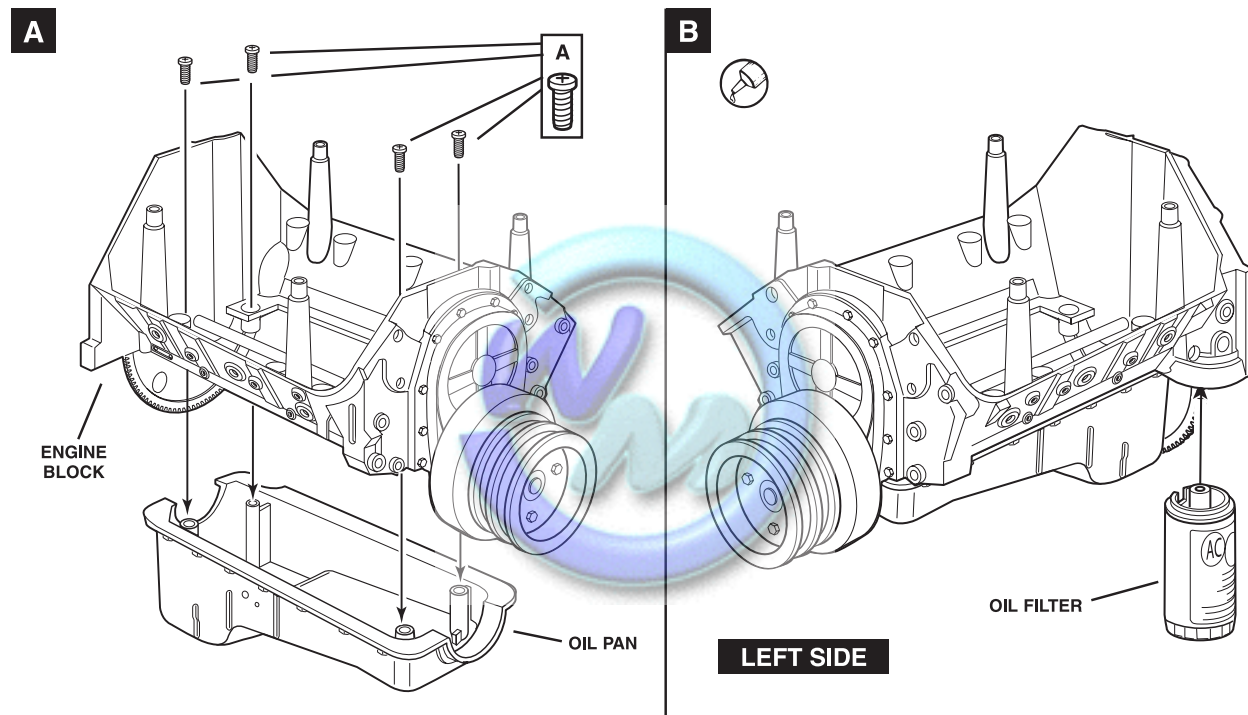
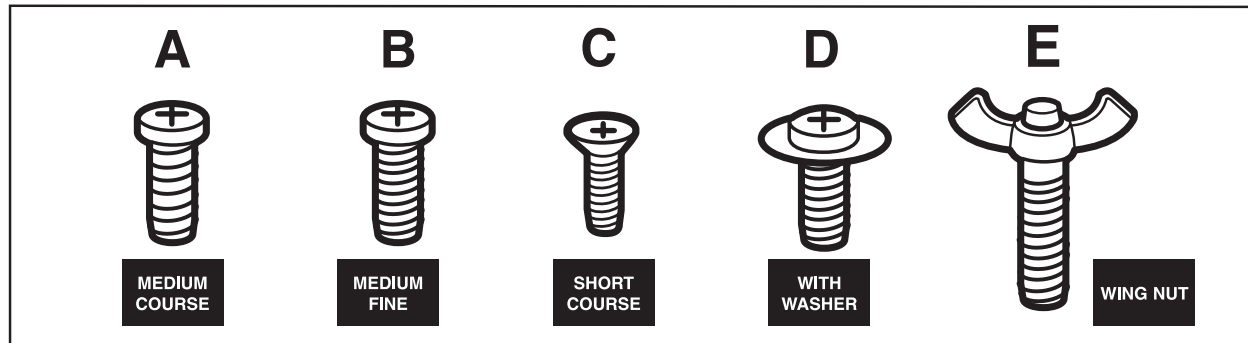
BLOCK ASSEMBLY

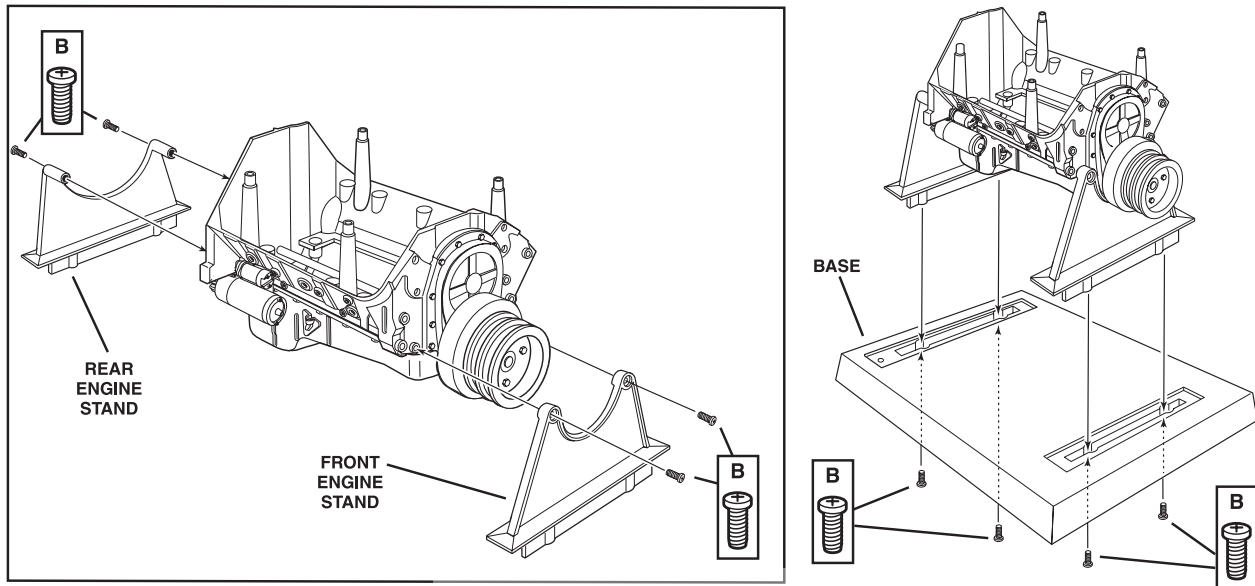
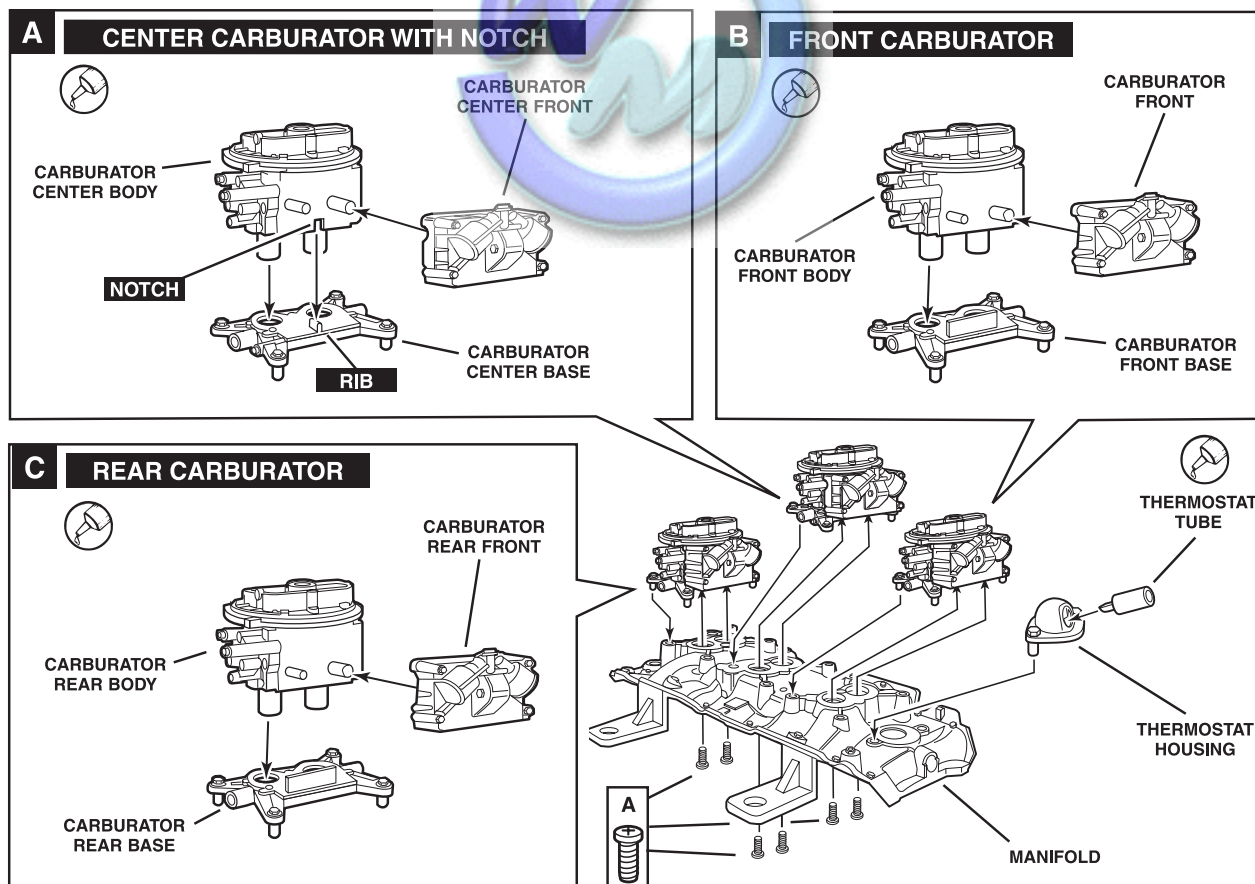
2**STAND ASSEMBLY****3****CARBURATOR / MANIFOLD ASSEMBLY**

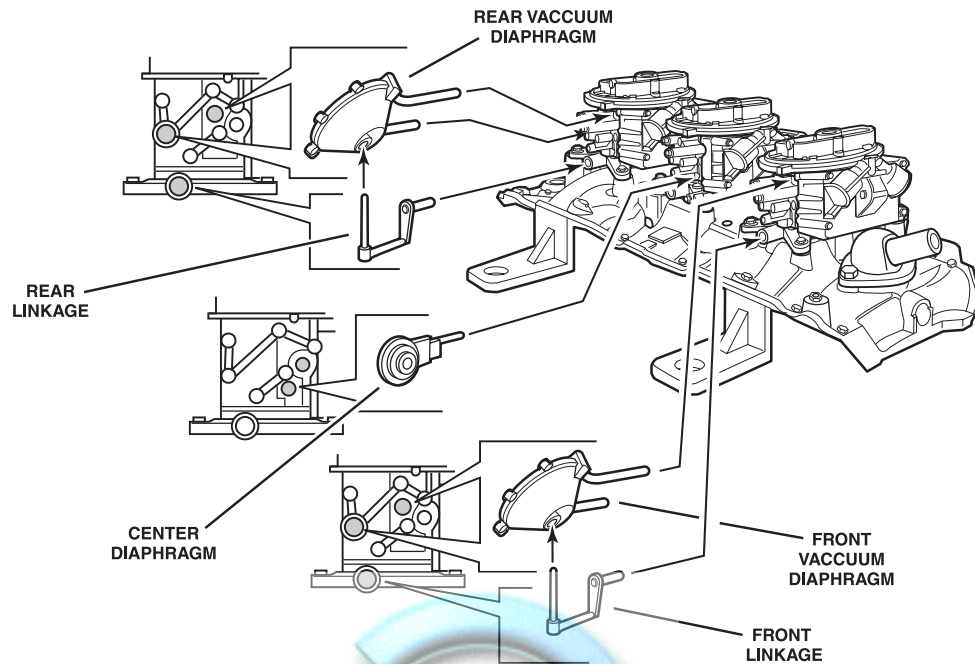
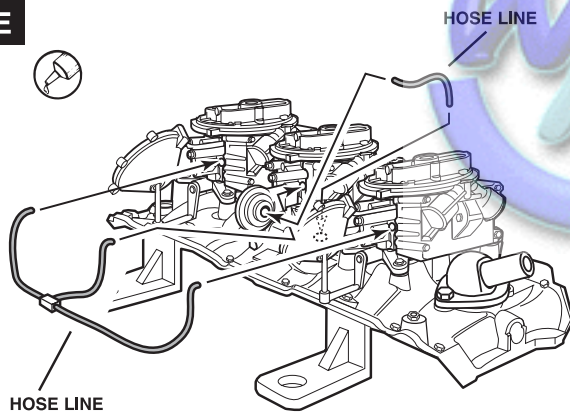
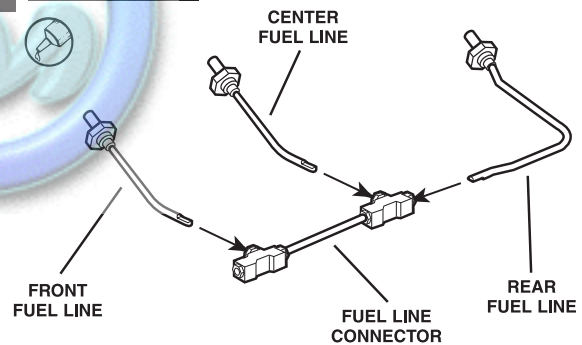
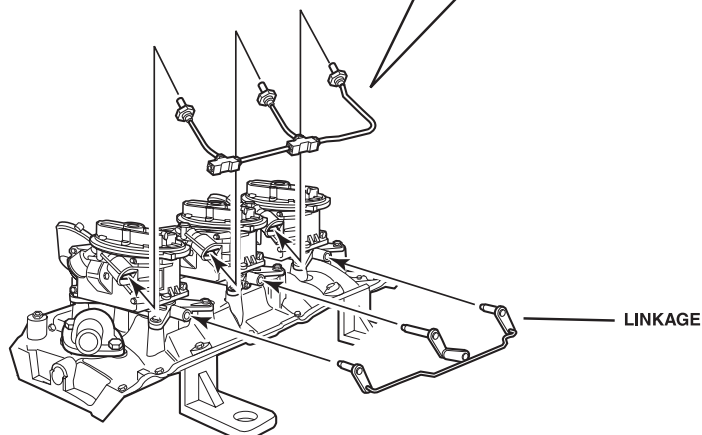
3**CARBURATOR ASSEMBLY CONTINUED****D****E****F LEFT SIDE****G**

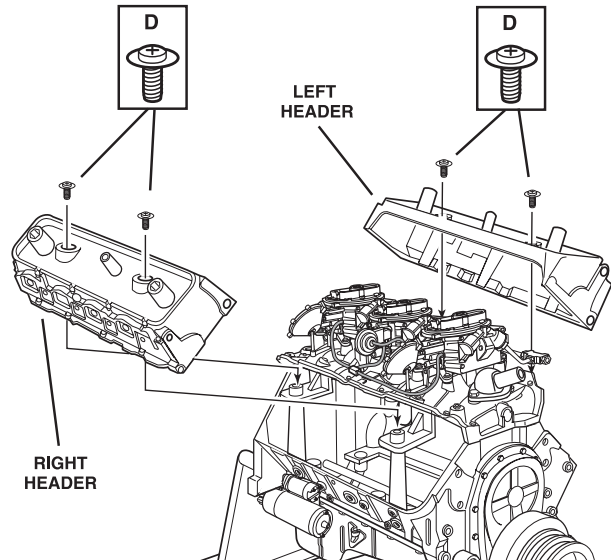
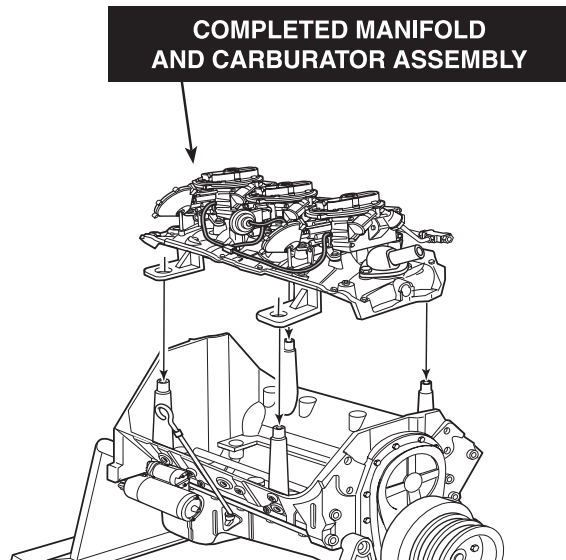
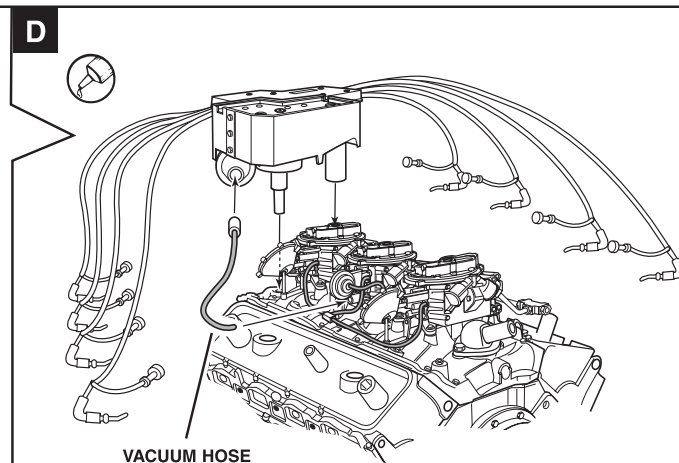
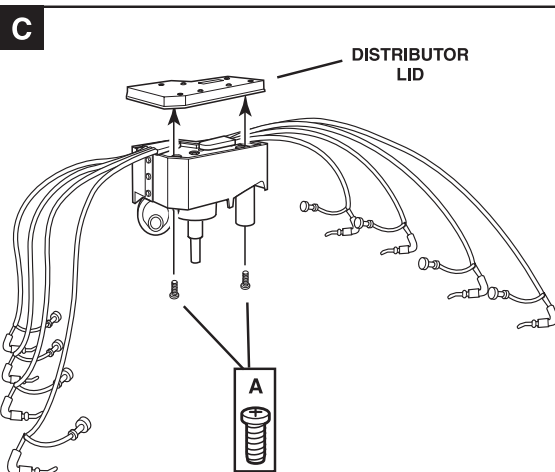
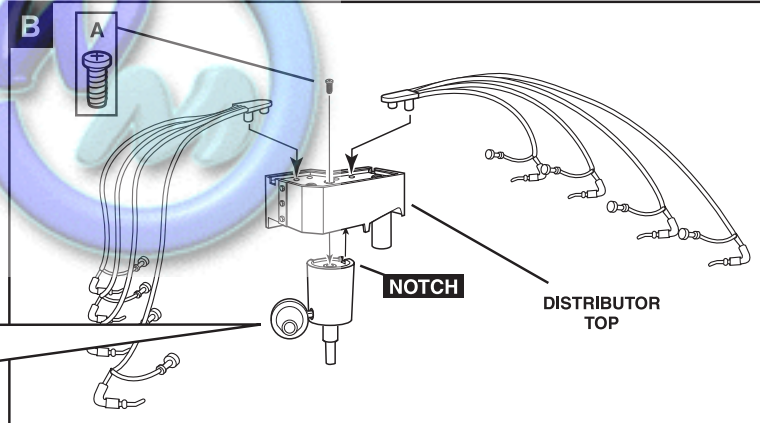
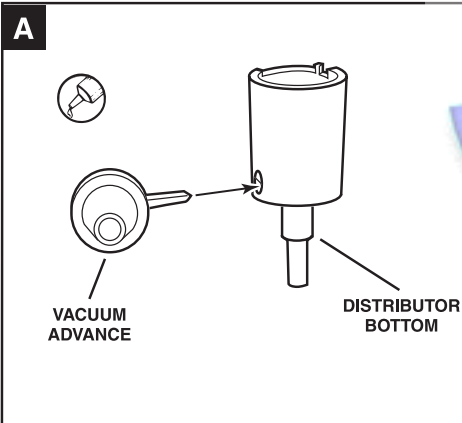
4**MANIFOLD / HEADER ASSEMBLY****5****DISTRIBUTOR ASSEMBLY**

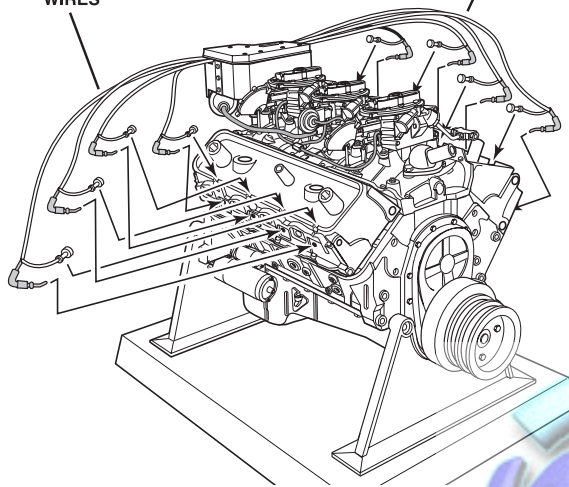
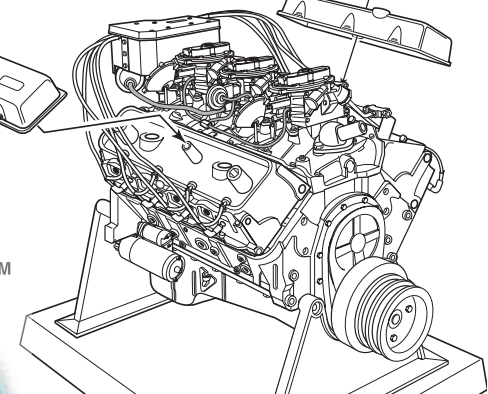
6**WIRES / COVERS ASSEMBLY****SPARK PLUG
WIRES TO HEADERS**RIGHT SPARK
PLUG
WIRESLEFT SPARK
PLUG
WIRESOIL FILLER
CAPROCKER-ARM
COVERSPARK PLUG
WIRE
CLIPSPARK PLUG
WIRE
CLIPROCKER-ARM
COVER**7****DIP STICK / EXHAUST ASSEMBLY**

PCV HOSE

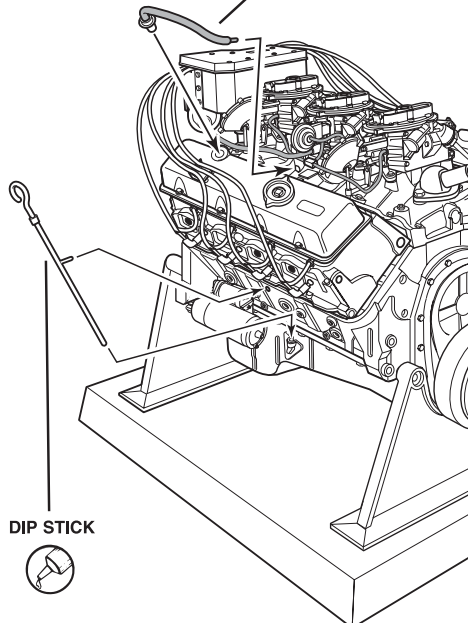

DIP STICK

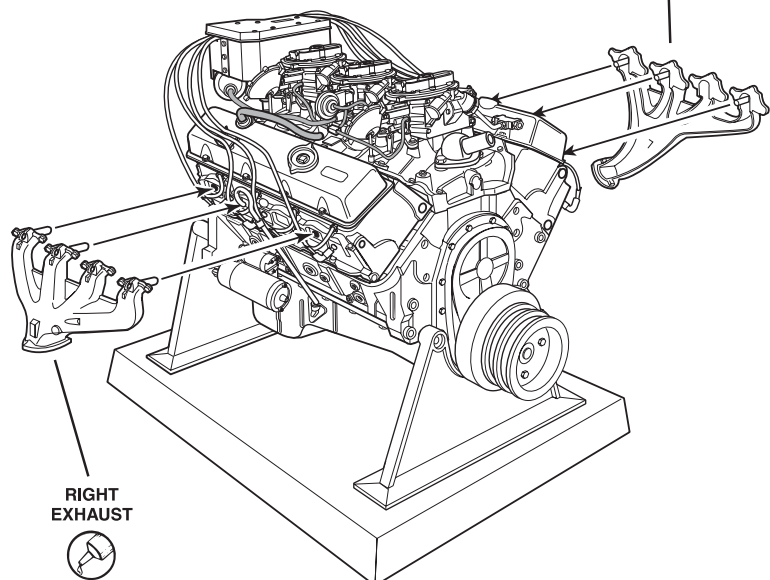
LEFT
EXHAUSTRIGHT
EXHAUST

8

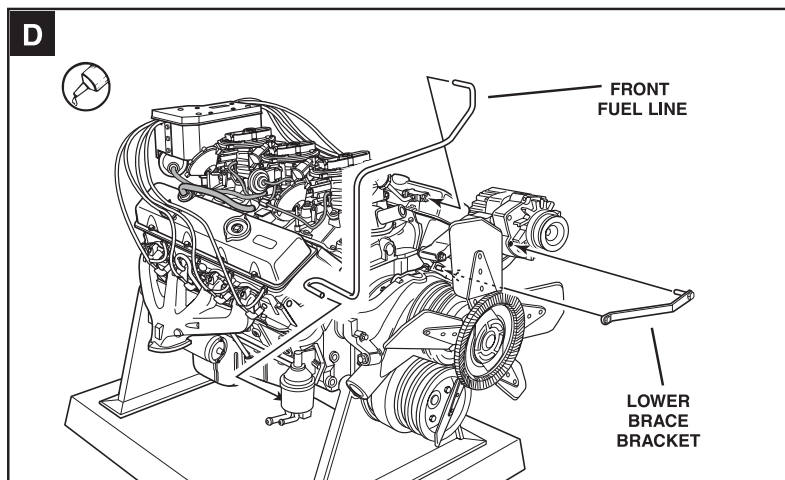
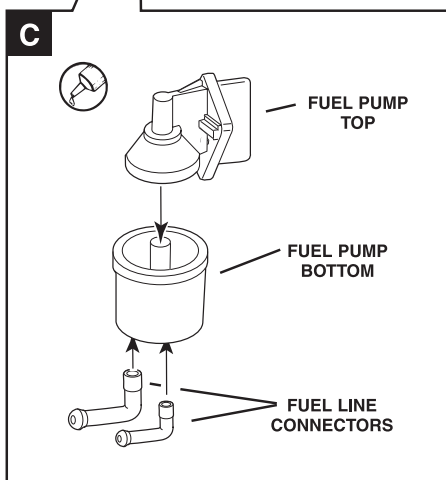
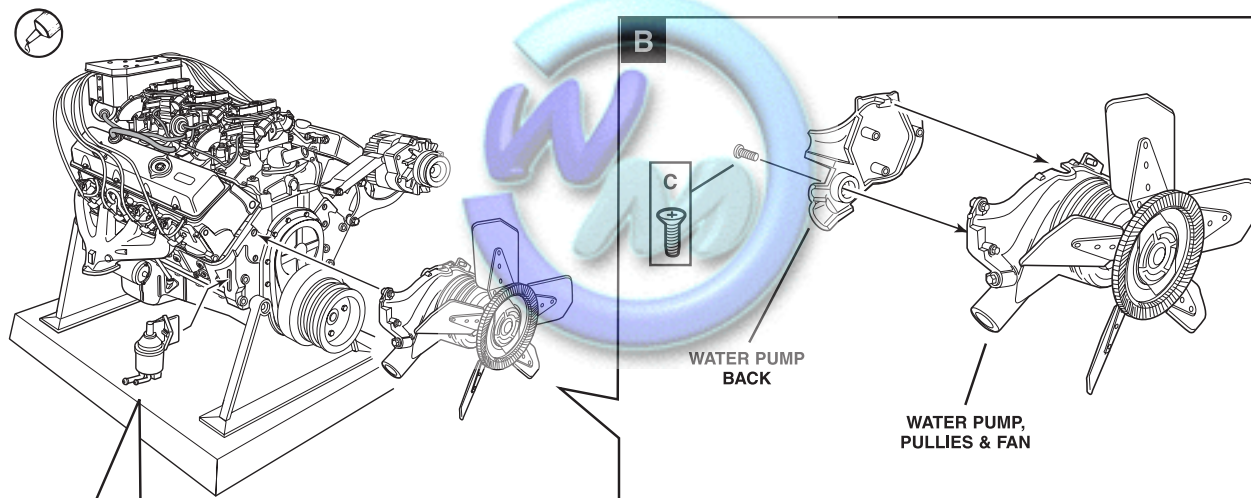
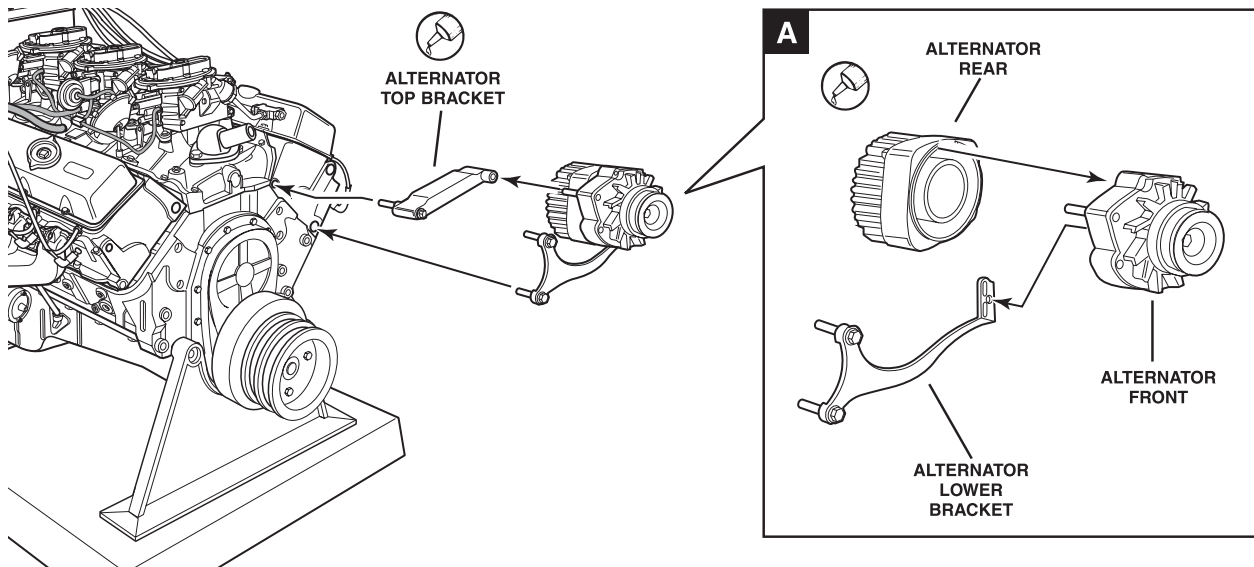
FRONT ENGINE ASSEMBLY

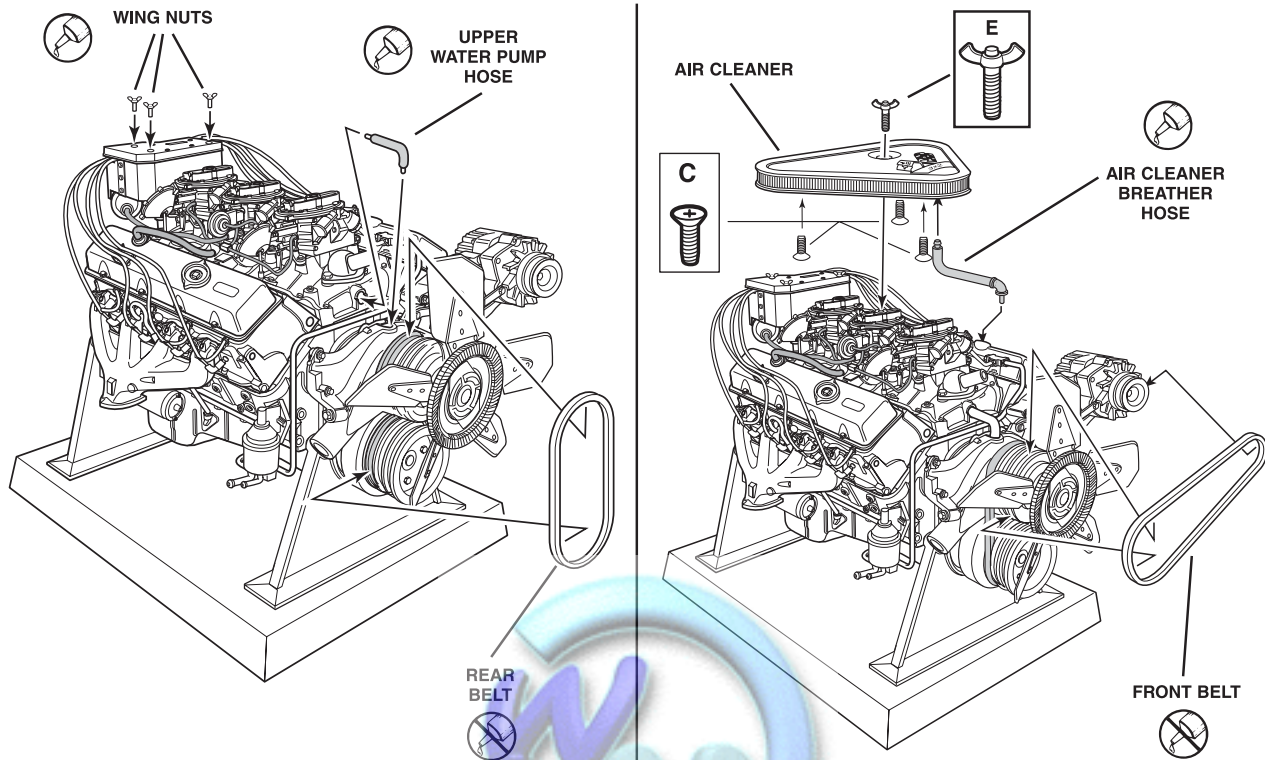
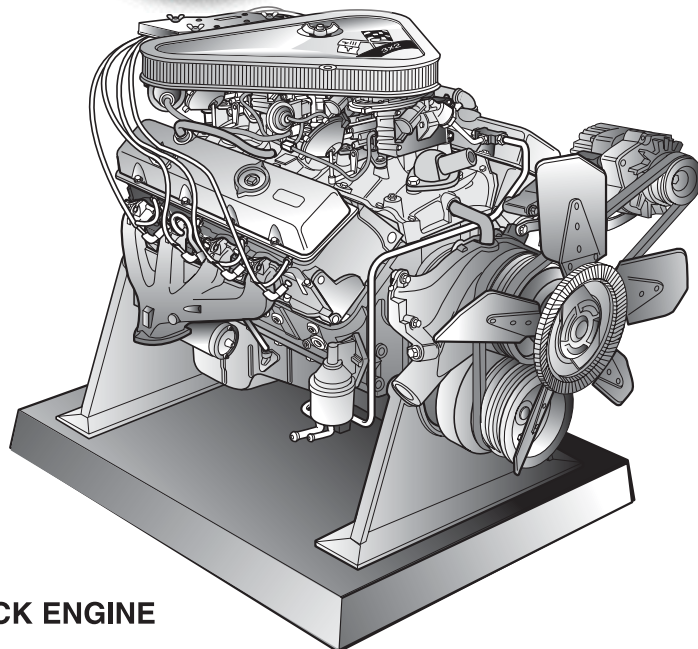
9**FINAL ASSEMBLY****10****COMPLETED ENGINE****CHEVROLET L89 BIG BLOCK ENGINE**