

Revell

Amphibious Transport Dock U.S.S. NEW YORK (LPD-21)

05118-0389

© 2012 Revell GmbH & Co. KG. A subsidiary of Hobbico, Inc.

PRINTED IN CHINA

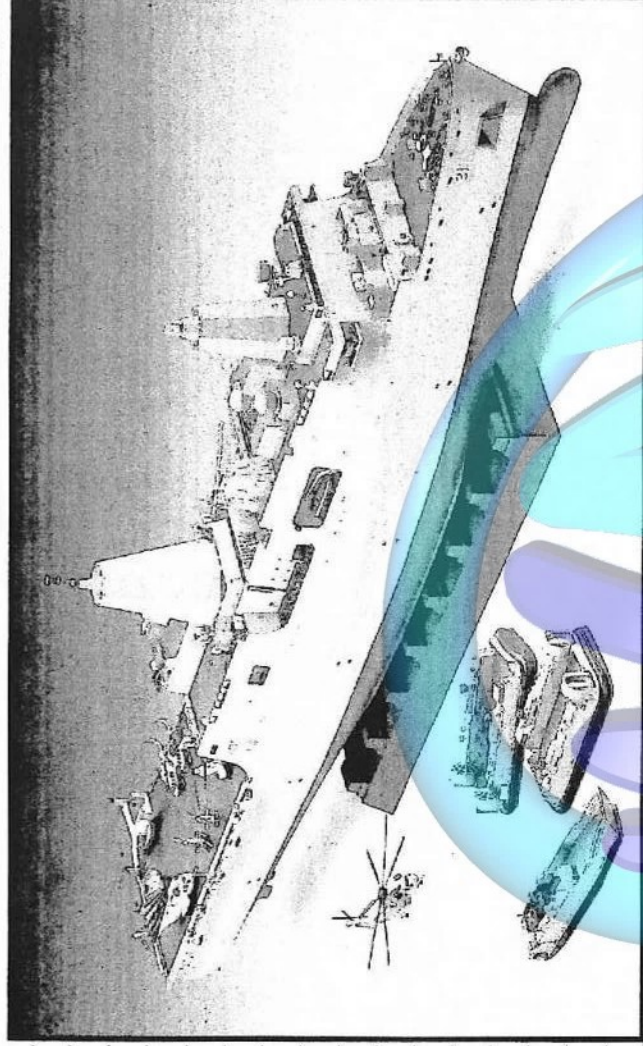

Amphibious Transport Dock U.S.S. NEW YORK (LPD-21)

Die U.S.S. New York ist ein „Amphibisches Transport Schiff“ der US Navy. Es gehört zu der San-Antonio-Klasse, die nach dem Prinzip der Stealth-Technologie konzipiert sind. Die Schiffe dieser Klasse dienen der amphibischen Kriegsführung, also dem Transport von US Marines, deren Fahrzeuge und Material. Dazu hat das Schiff drei Decks mit rund 2.300 m² Platz für Kampffahrzeuge. Neben der Stammbesatzung von 360 Mann, gibt es Platz für weitere 700-800 Marines. Über das flutbare Welldeck am Heck können die Landungsboote Material und Soldaten an Land bringen. Weiterhin hat das Schiff ein großes Landedeck mit dazugehörigem Hangar. Helikopter werden aber nicht permanent mitgeführt, sondern im Rahmen einzelner Einsätze temporär auf dem Schiff stationiert.

Die Besonderheit des Schiffes liegt aber vielmehr in seinem Namen. Nach den Terroranschlägen vom 11. September 2001, bat der damalige Gouverneur von New York, den damaligen Marineminister ein Kriegsschiff im Kampf gegen den Terror nach dem Bundesstaat New York zu benennen. Dieser Bitte wurde entsprochen, so dass die U.S.S. New York am 19. Dezember 2007 vom Stapel lief und am 7. November 2009 in New York City in Dienst gestellt worden ist. Es wurden sogar 6,8 Tonnen Stahl aus den Trümmern des World Trade Centers im Vordersteven verbaut.

Amphibious Transport Dock U.S.S. NEW YORK (LPD-21)

The U.S.S. New York is a US Navy amphibious transport ship. It is one of the San Antonio Class designed according to the principles of stealth technology. The ships of this class are used for amphibious warfare and to transport US Marines, their vehicles and equipment. The ship therefore has three decks with about 2,300 m² of space for combat vehicles. In addition to the basic crew of 360 men there is room for a further 700-800 marines. The landing craft, equipment and soldiers can be landed through the floodable well deck aft. In addition the ship has a large landing deck with hangar. However helicopters are not permanently carried, but can be temporarily stationed on board for individual missions.

The special feature of the ship however is its name. After the terrorist attacks of 11th September 2001, the then governor of New York asked the then Secretary of the Navy to name a warship in the war against terror after the city of New York. This request was met; the U.S.S. New York was launched on 19th December 2007 and went into service on 7th November 2009. There were even 6.8 tonnes of steel from the ruins of the World Trade Center incorporated in the forepart.

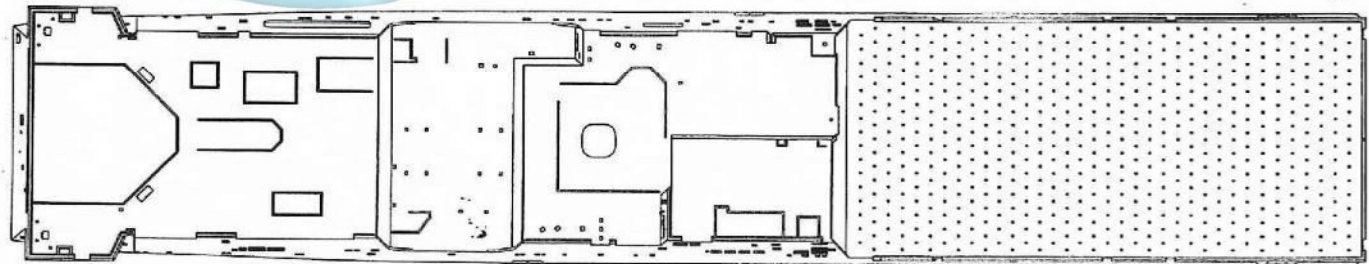
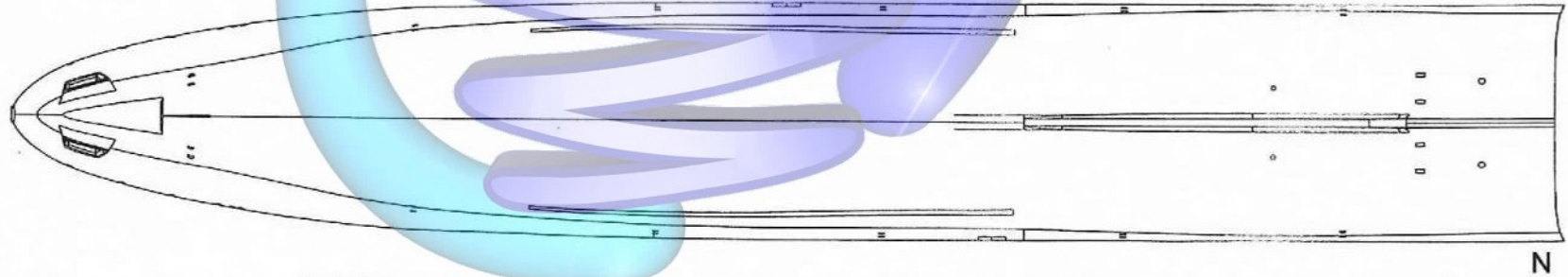
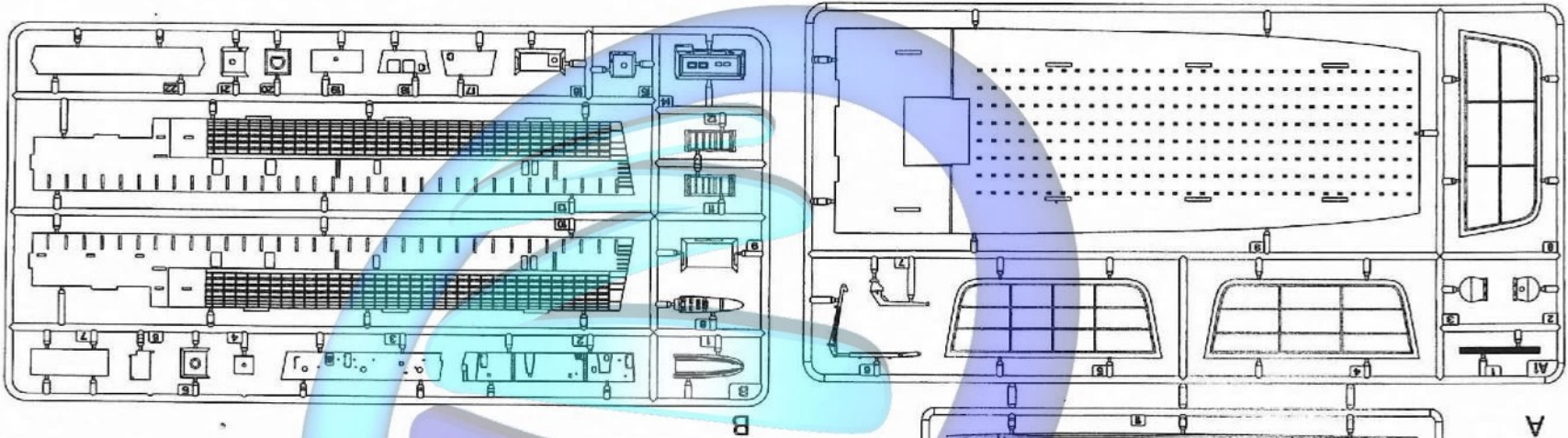
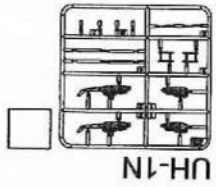
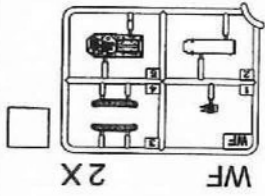
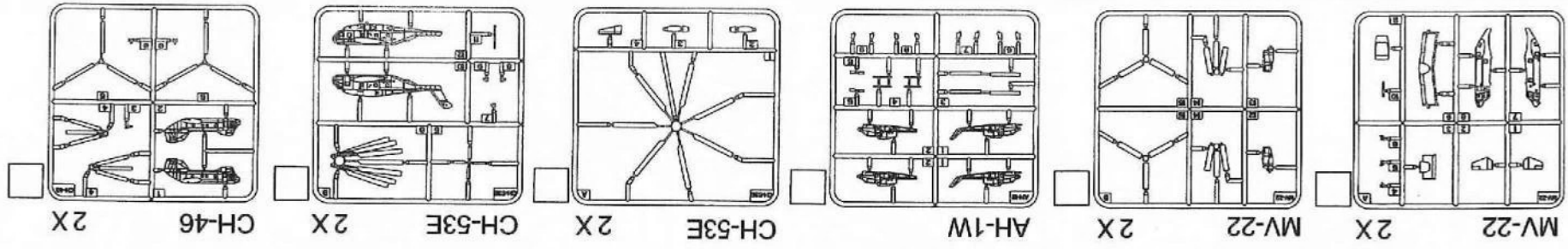

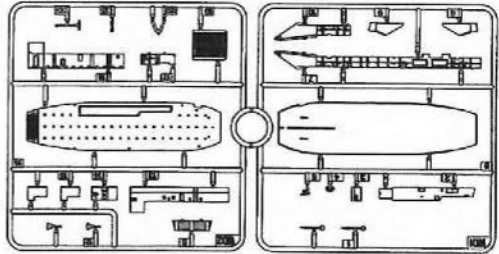
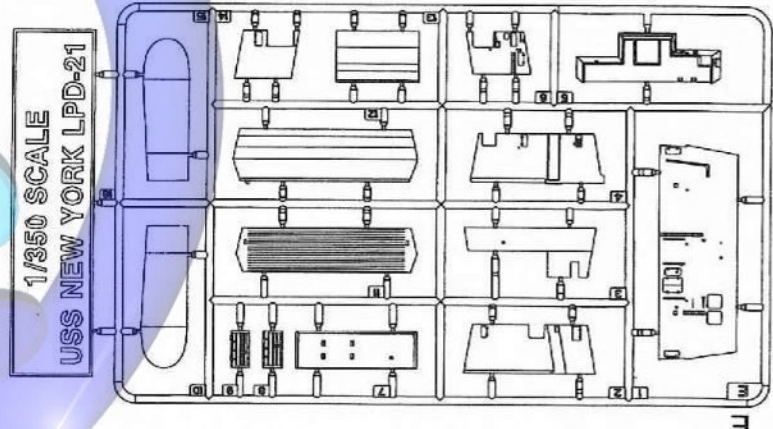
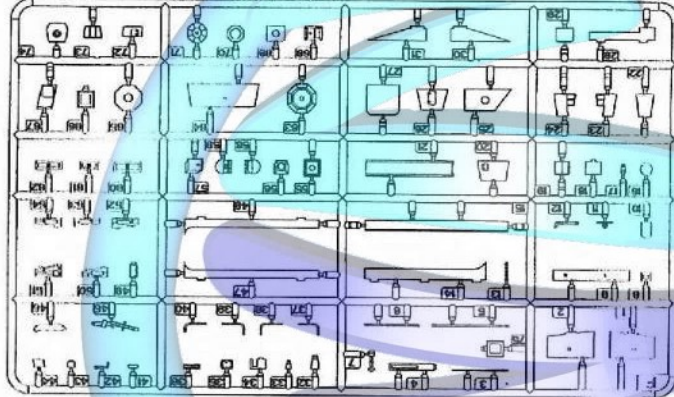
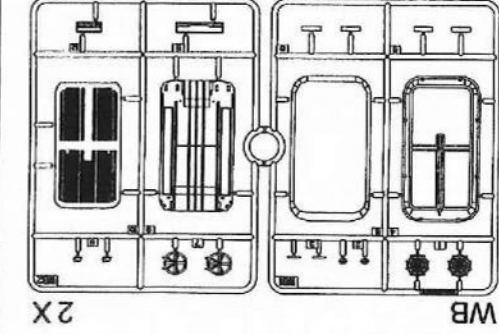
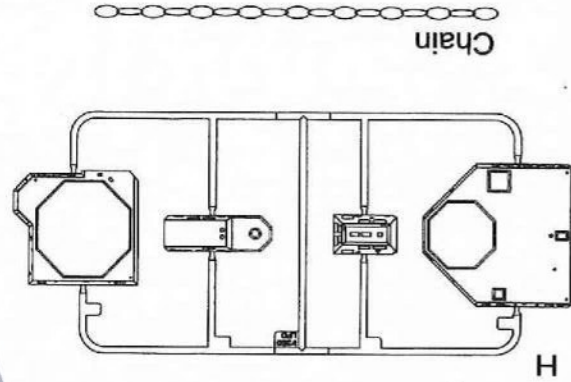
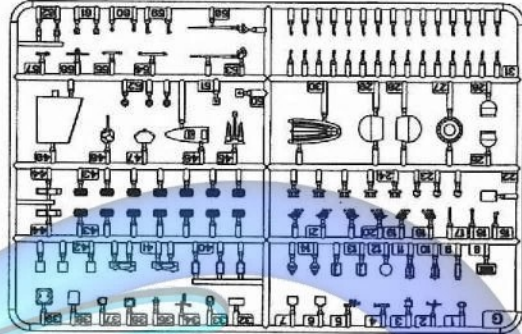
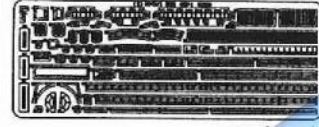
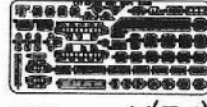
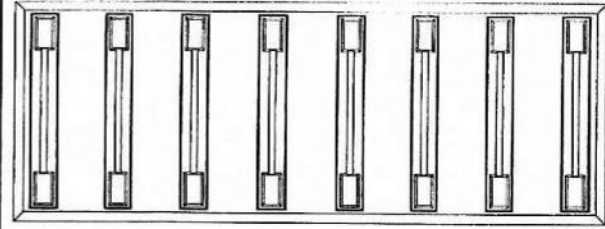

1/350 SCALE
USS NEW YORK LPD-21

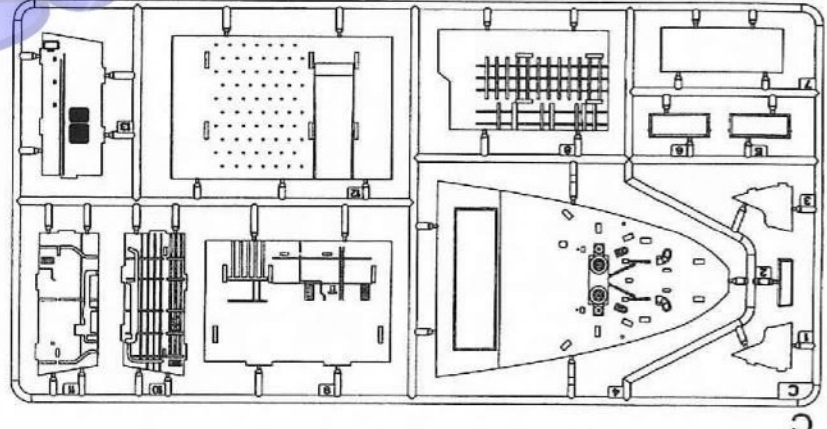
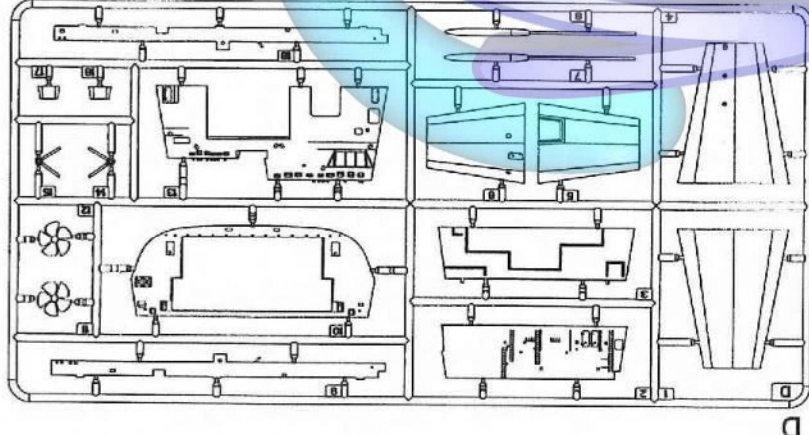
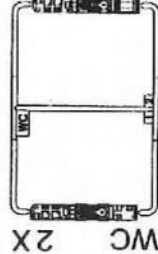

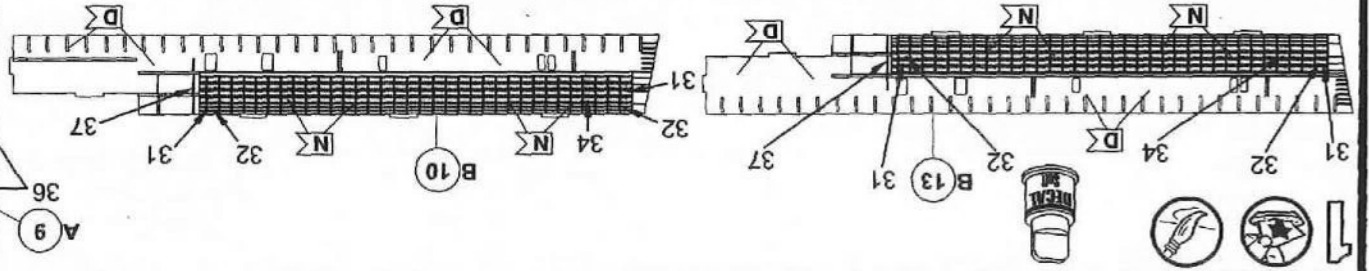
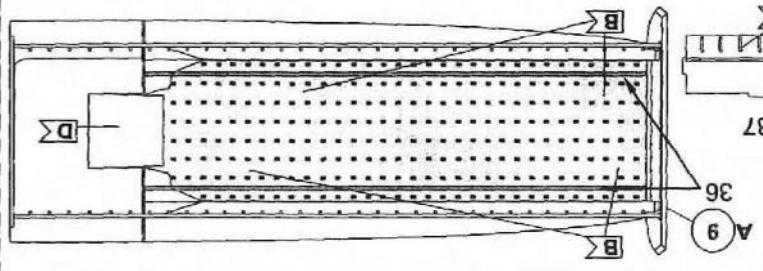
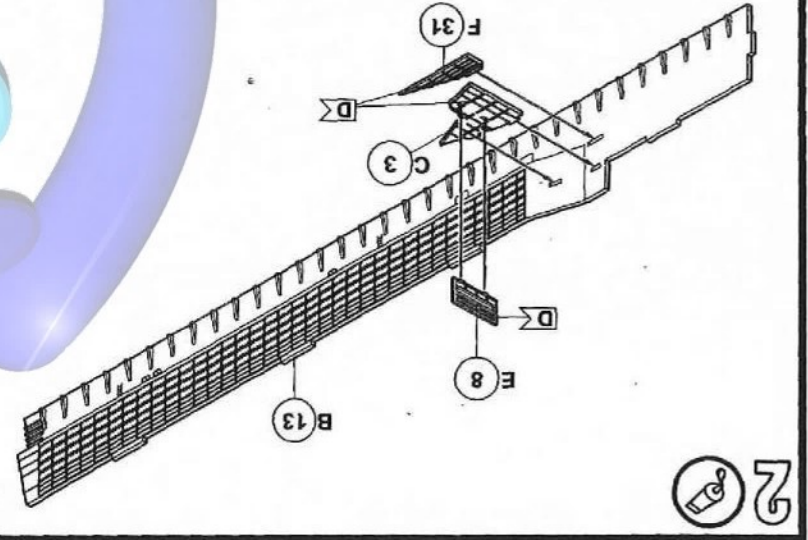
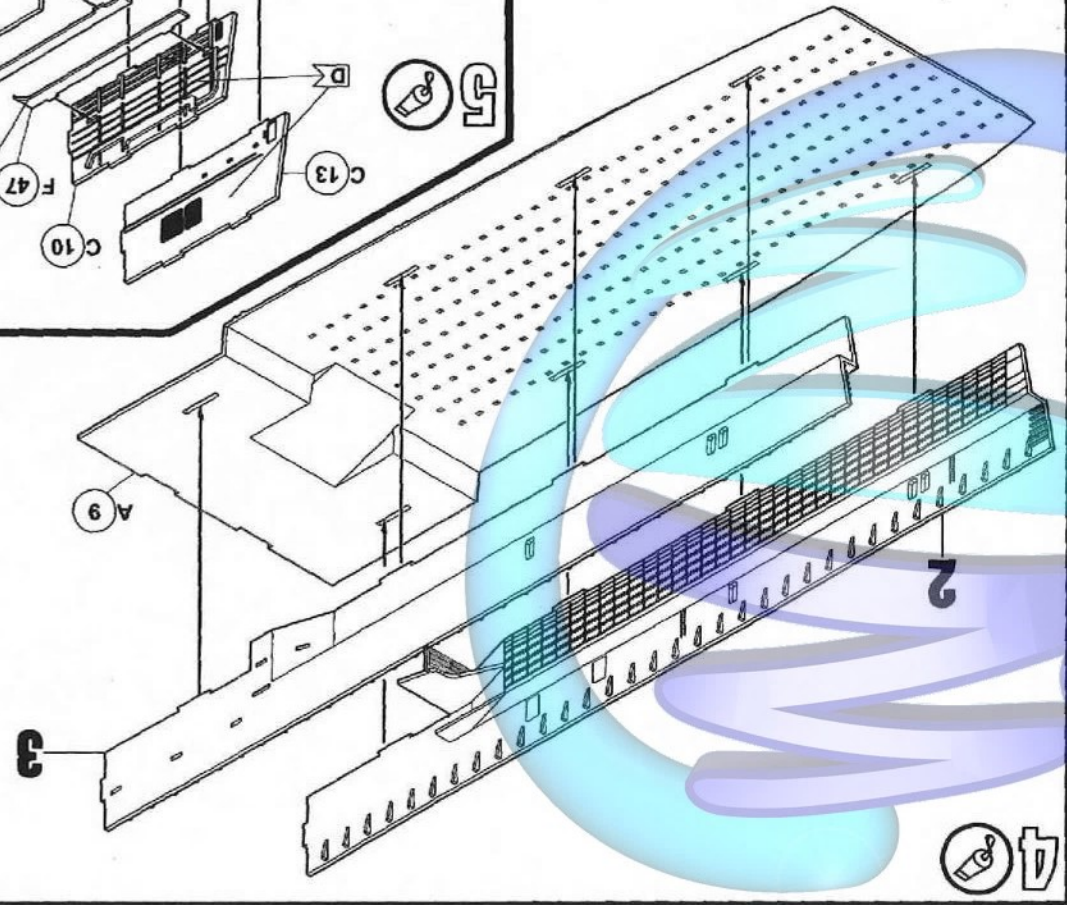
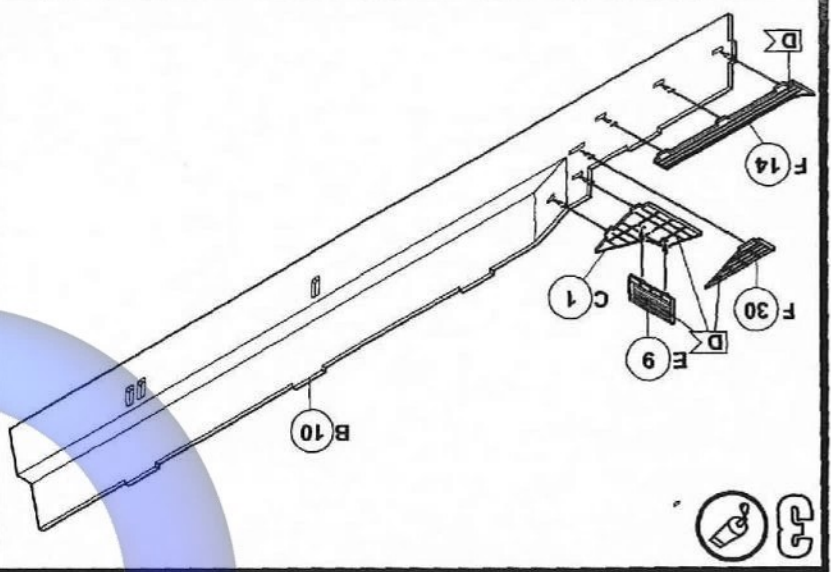
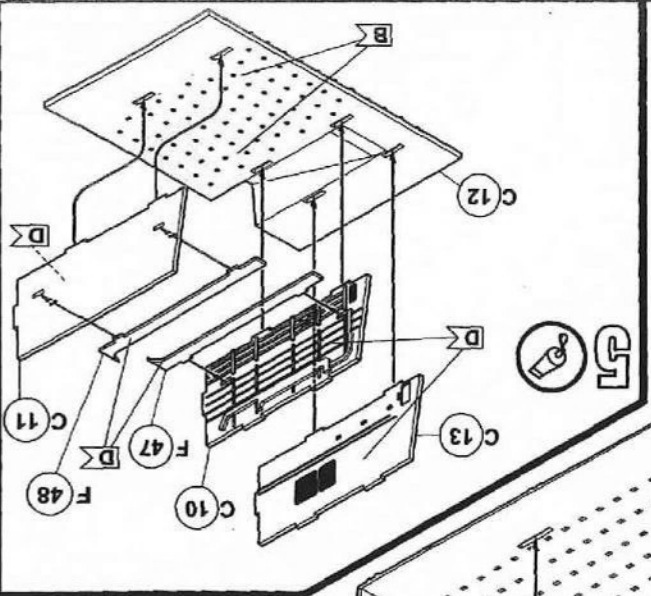

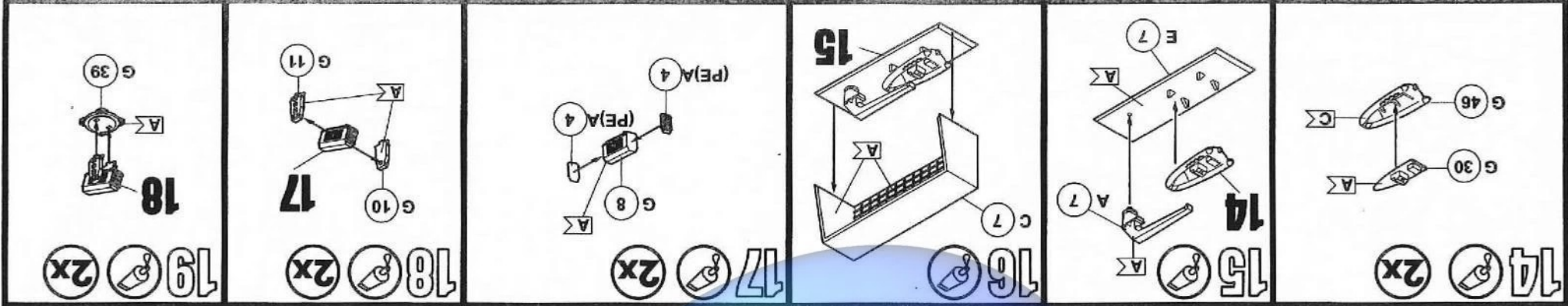
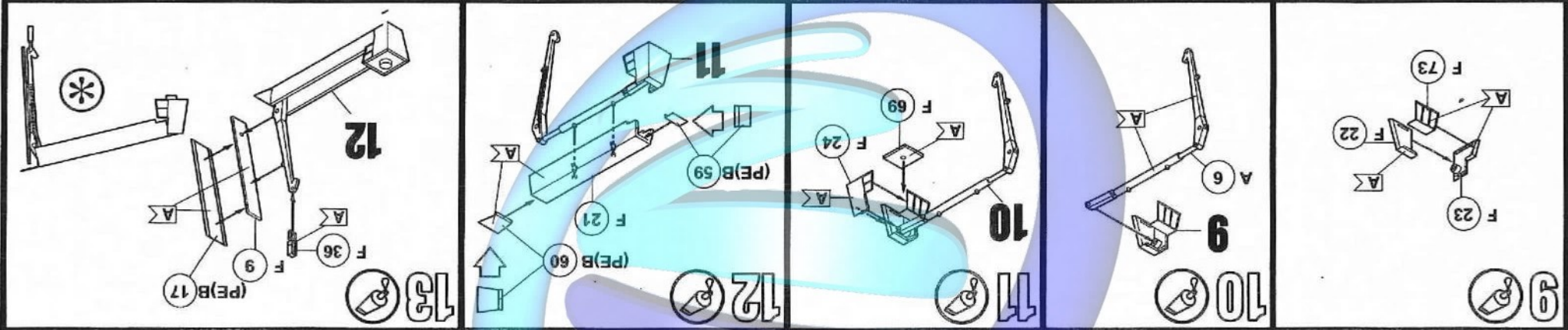
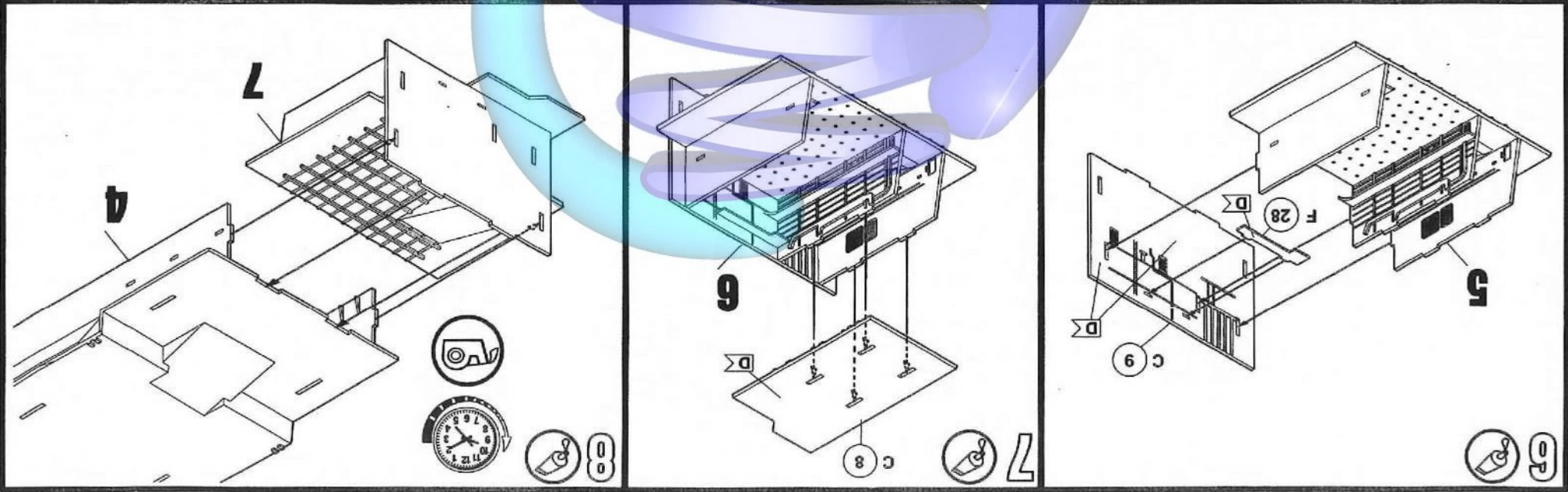

21

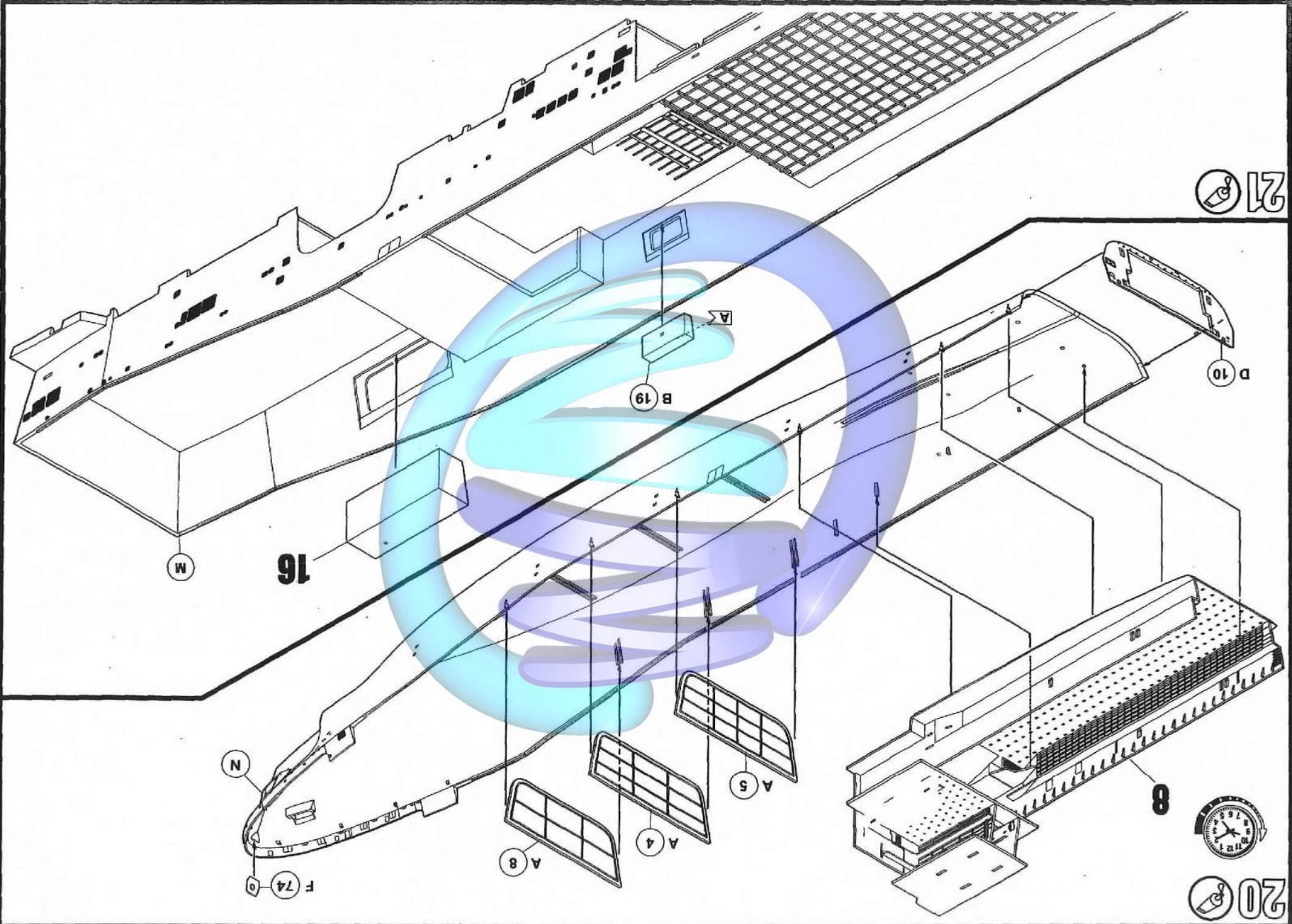

20

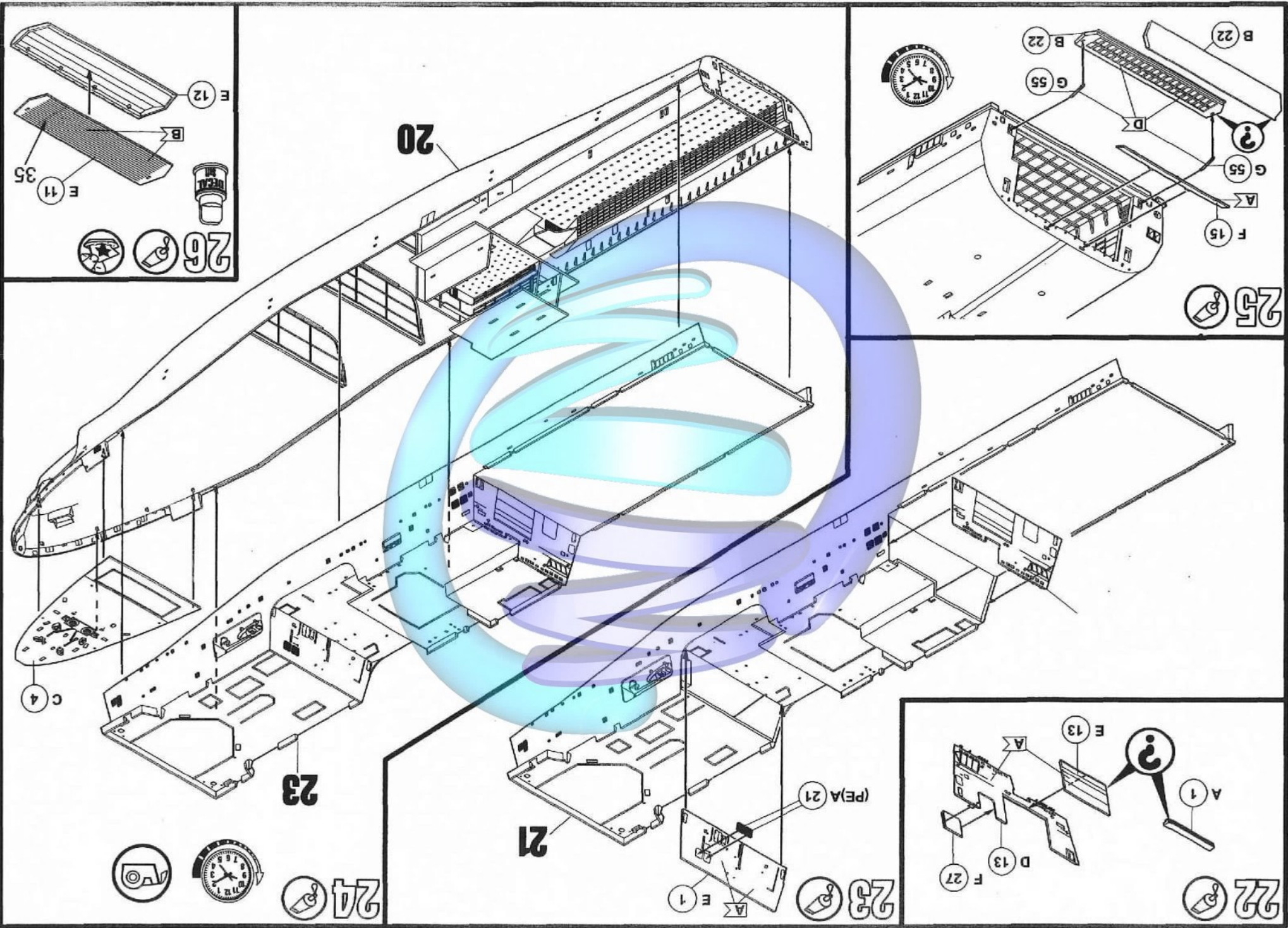

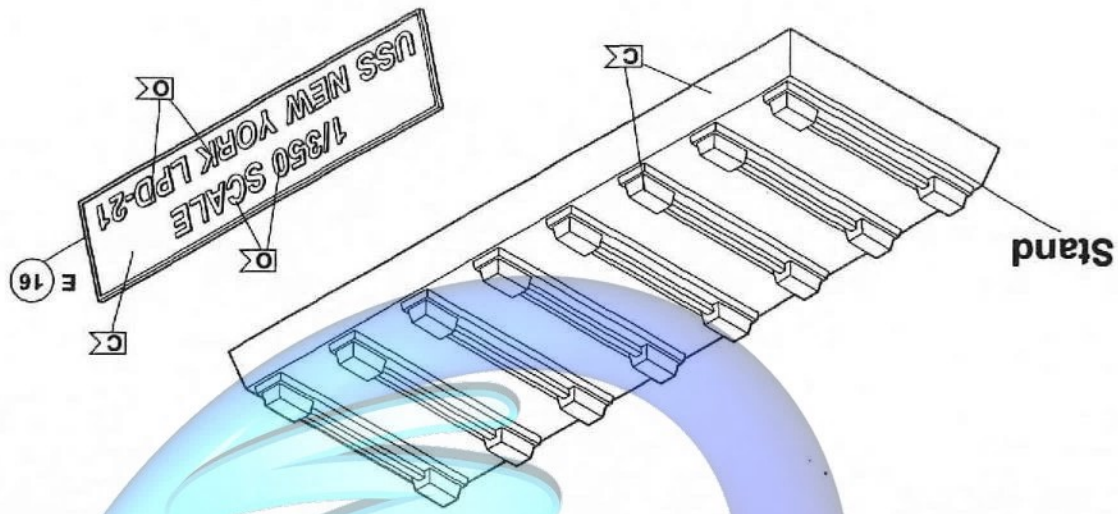

29

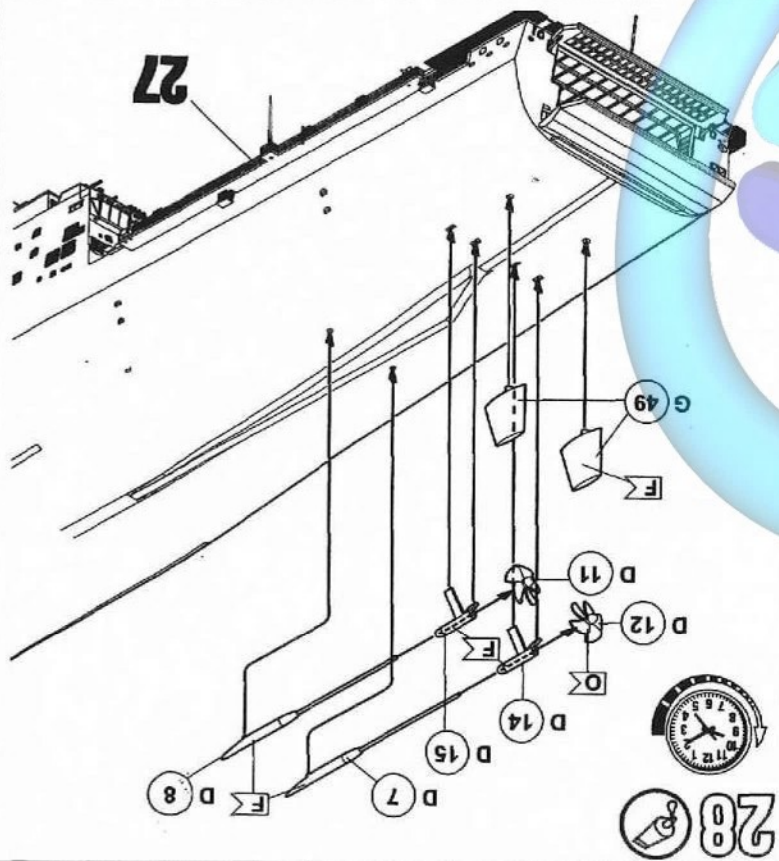

28

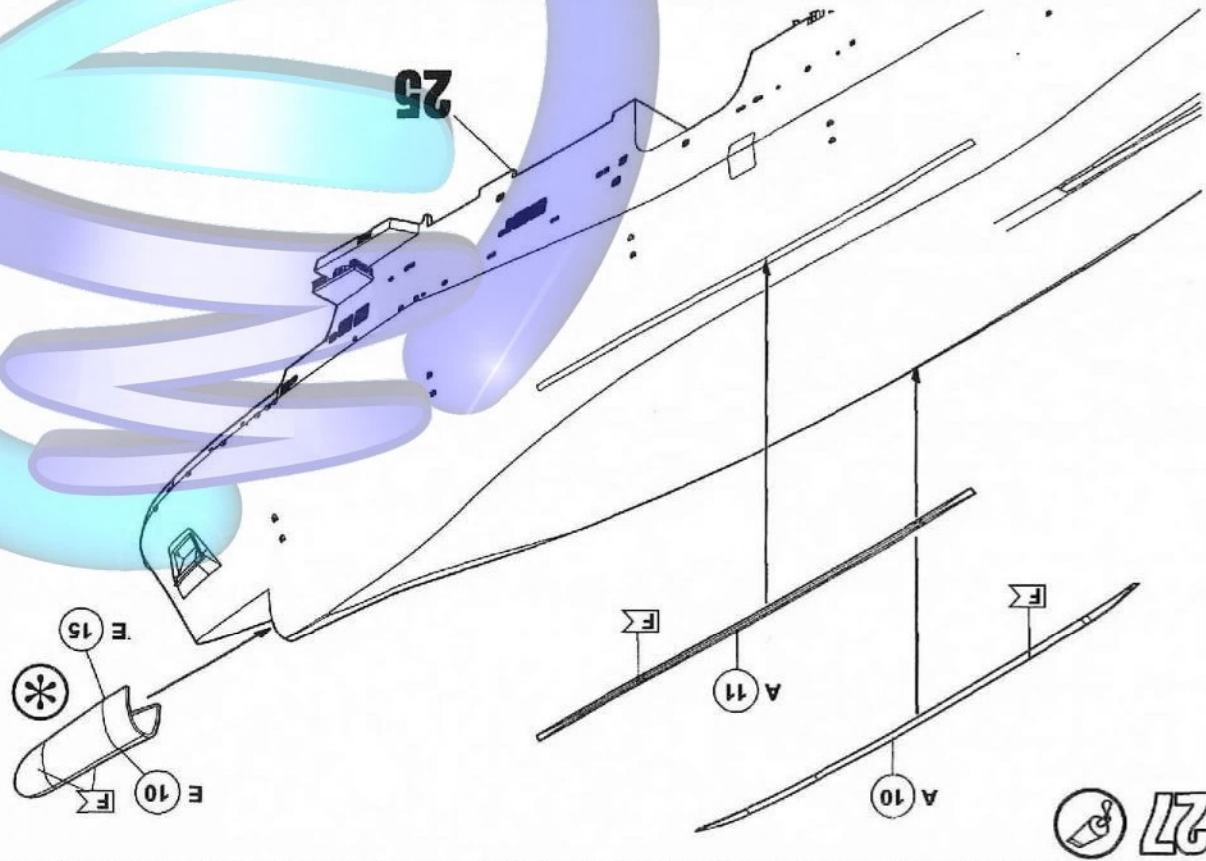

27

