



## ATF Dingo 2 GE A2 PatSi

Das Allschutz-Transportfahrzeug (ATF) Dingo hat sich seit der Einführung im Jahre 2000 zu einem wahren Allrounder in der Bundeswehr entwickelt. Selbst für Aufgaben, für die der Dingo ursprünglich nicht vorgesehen war. Die seit 1990 weltweit geänderte militärische Lage zeigte, dass für viele neue Aufgaben die vorhandenen Transportfahrzeuge wie der LKW 2 t, Unimog der Besatzung keinen Schutz boten, oder aber TPz Fuchs und SPz Marder zu groß und zu schwer waren. Zudem gewann der Schutz gegen Minen und Sprengsätzen an Bedeutung. Nachdem 147 Dingo 1 auf dem Unimog-Fahrgestell U-1550-L gebaut waren, folgte der Dingo 2 auf dem U-5000 Fahrgestell, welches eine höhere Nutzlast zulässt und weitere Verbesserungen beinhaltet. Fast 600 Dingo 2 wurden von der Bundeswehr in unterschiedlichen Varianten beschafft. Rechnet man internationale Nutzer wie Belgien, Luxemburg, Österreich, Tschechien und Norwegen hinzu, so konnte Krauss-Maffei Wegmann bereits über 1.000 Dingo 2 ausliefern (Stand 2013).

Die Variante „ATF Dingo 2 GE A2 PatSi“ ist seit 2006 als Patrouillen- und Sicherungsfahrzeug in Afghanistan im Einsatz. Das Fahrzeug bietet Platz für 6 Soldaten. Zum Selbstschutz ist es im Regelfall mit einer mechanischen Überkopf-Waffenstation vom Typ 1530 mit einem 7,62 mm MG3A1 ausgerüstet, welche auch von innen bedient werden kann. Der Antrieb besteht aus einem Turbodiesel Motor mit 163 kw (222 PS). Allradfunktion mit Differentialsperre, abschaltbaren ABS und Reifendruckregelanlage. Zur Orientierung kann eine GPS-gestützte Navigationsanlage genutzt werden. Des Weiteren verfügt der Dingo 2 über eine Standheizung, Klimaanlage und ABC-Schutzbelüftungsanlage, sowie außen über eine Rückblickkamera und eine Außenbordsperrstelle. Für seine Fahrzeugklasse hat der Dingo 2 einen hervorragenden Minenschutz, welcher durch den V-förmigen Deflektor unter der Sicherheitszelle erreicht wird. Diese Zelle, in dem die Besatzung sitzt, ist zudem gegen 7,62 mm Munition geschützt. Die Reifen haben Notlaufeigenschaften, die eine Weiterfahrt bei zerstörtem Mantel bei reduzierter Geschwindigkeit zulassen. Das Gefechtsgewicht beträgt 12,5 t. Mit 149 Stück ist der „ATF Dingo 2 GE A2 PatSi“ das zahlenmäßig größte Bauteil.

## ATF Dingo 2 GE A2 PatSi

Since it was introduced in 2000, the Allschutz-Transportfahrzeug (ATF = all-protected transport vehicle) Dingo has developed into a real all-rounder in the German Army; even for missions for which the Dingo was originally not intended. The changes in the worldwide military situation since 1990 showed that for many new missions the available transport vehicles such as the LKW 2t Unimog 2 tonne truck offered no protection for the crew and that the TPz Fuch and SPz Marder were too large and heavy. In addition, increasing importance was given to protection against mines and explosives. After 147 of the Dingo 1 had been built on the Unimog chassis U-1550-L, it was followed by the Dingo 2 on the U-5000 chassis, which gave it a higher load capacity and incorporated other improvements. Almost 600 of the Dingo 2 were purchased by the German army in several variants. Taking into account international users such as Belgium, Luxemburg, Austria, the Czech Republic and Norway, Krauss-Maffei Wegmann have already supplied over 1,000 of the Dingo 2 (2013 position).

The "ATF Dingo 2 GE A2 PatSi" variant has been in service in Afghanistan since 2006 as a patrol and security vehicle. The vehicle can accommodate 6 troops. By way of self protection, as a rule it is equipped with a type 1530 mechanical overhead weapons station with a 7.62 mm MG3A1, which can also be operated from inside. It is driven by a 163 kW (222 hp) turbo-diesel engine and has all-wheel drive with differential lock, ABS that can be overridden and a tyre pressure control system. A GPS navigation system can be used. In addition the Dingo 2 has auxiliary heating, air conditioning and ABC protective ventilation as well as an external rear view camera and outboard public address system. The Dingo 2 has outstanding anti-mine protection for its class, which is accessed via the V-shaped deflector under the safety cell. This cell, in which the crew sits, is also protected against 7.62 mm ammunition. The tyres will run on empty, which enables it to keep moving at reduced speed if the outer casing is damaged. The combat weight is 12.5 tonnes. With sales figures of 149 the ATF Dingo 2 GE A2 PatSi is the vehicle in greatest demand.

Fern hergestellt und im Eigentum von Revell GmbH. Widerrechtliche Nachahmungen werden gerichtlich verfolgt. Co. product is not made in Germany. Revell GmbH. All rights reserved. No part of this publication may be reproduced without the written permission of Revell GmbH.

Modell ist ein Produkt von Revell GmbH. Infringeing rights are reserved. Revell GmbH. All rights reserved. No part of this publication may be reproduced without the written permission of Revell GmbH.

Forma produsa este de Revell GmbH. Toate drepturile rezervate. Revell GmbH. All rights reserved. No part of this publication may be reproduced without the written permission of Revell GmbH.

Model je proizvedeno u Revell GmbH. Sve prava su zadržana. Revell GmbH. All rights reserved. No part of this publication may be reproduced without the written permission of Revell GmbH.

Model je proizveden u Revell GmbH. Sve prava su zadržana. Revell GmbH. All rights reserved. No part of this publication may be reproduced without the written permission of Revell GmbH.

Model je proizveden u Revell GmbH. Sve prava su zadržana. Revell GmbH. All rights reserved. No part of this publication may be reproduced without the written permission of Revell GmbH.

Model je proizveden u Revell GmbH. Sve prava su zadržana. Revell GmbH. All rights reserved. No part of this publication may be reproduced without the written permission of Revell GmbH.

Model je proizveden u Revell GmbH. Sve prava su zadržana. Revell GmbH. All rights reserved. No part of this publication may be reproduced without the written permission of Revell GmbH.

Von fern hergestellt und im Eigentum von Revell GmbH. Widerrechtliche Nachahmungen werden gerichtlich verfolgt. Forma produsa este de Revell GmbH. Toate drepturile rezervate. Revell GmbH. All rights reserved. No part of this publication may be reproduced without the written permission of Revell GmbH.

Modell ist ein Produkt von Revell GmbH. Infringeing rights are reserved. Revell GmbH. All rights reserved. No part of this publication may be reproduced without the written permission of Revell GmbH.

Forma produsa este de Revell GmbH. Toate drepturile rezervate. Revell GmbH. All rights reserved. No part of this publication may be reproduced without the written permission of Revell GmbH.

Model je proizvedeno u Revell GmbH. Sve prava su zadržana. Revell GmbH. All rights reserved. No part of this publication may be reproduced without the written permission of Revell GmbH.

Model je proizveden u Revell GmbH. Sve prava su zadržana. Revell GmbH. All rights reserved. No part of this publication may be reproduced without the written permission of Revell GmbH.

Model je proizveden u Revell GmbH. Sve prava su zadržana. Revell GmbH. All rights reserved. No part of this publication may be reproduced without the written permission of Revell GmbH.

Model je proizveden u Revell GmbH. Sve prava su zadržana. Revell GmbH. All rights reserved. No part of this publication may be reproduced without the written permission of Revell GmbH.

Model je proizveden u Revell GmbH. Sve prava su zadržana. Revell GmbH. All rights reserved. No part of this publication may be reproduced without the written permission of Revell GmbH.







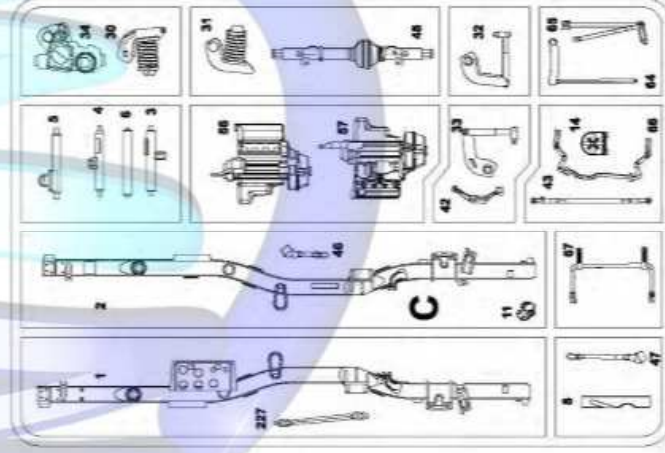
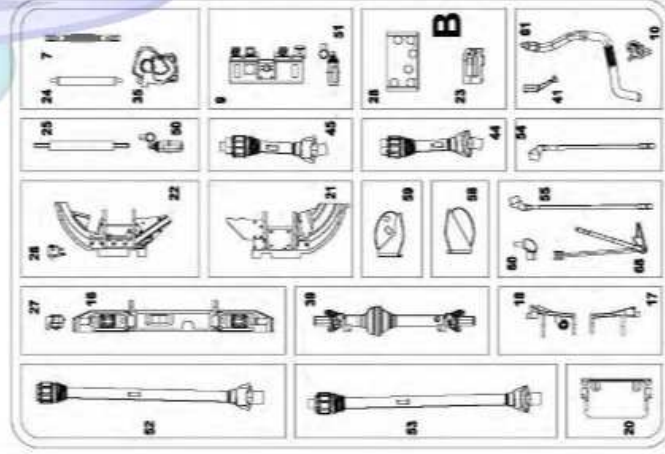
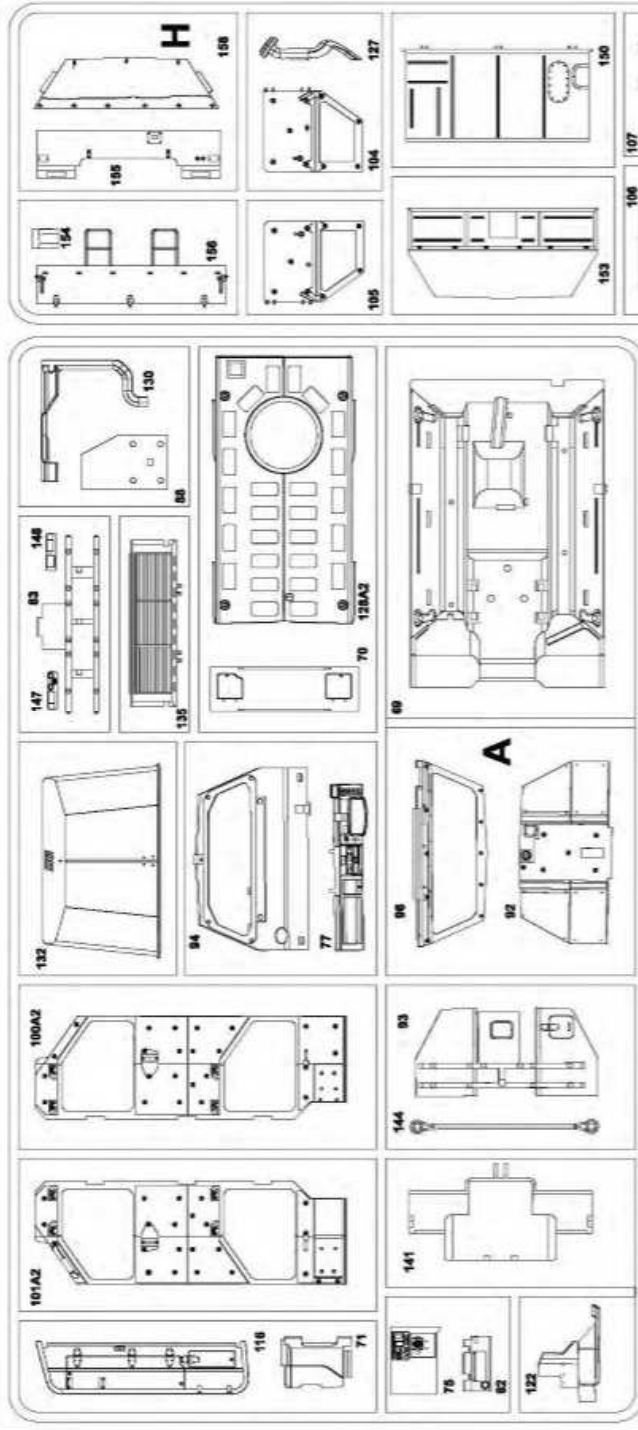



- A < D < G
- 64 65 66
- 67

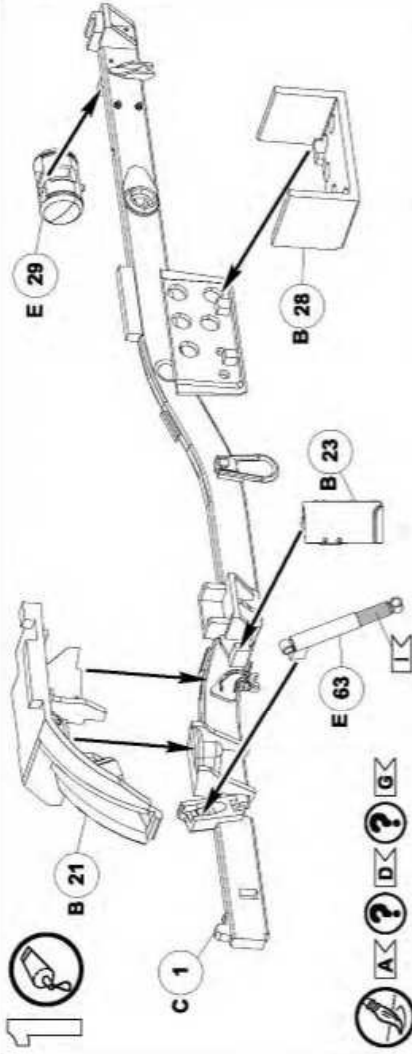

2

3

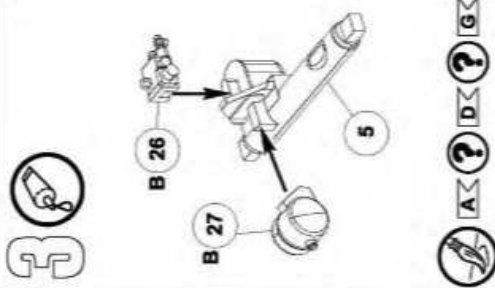
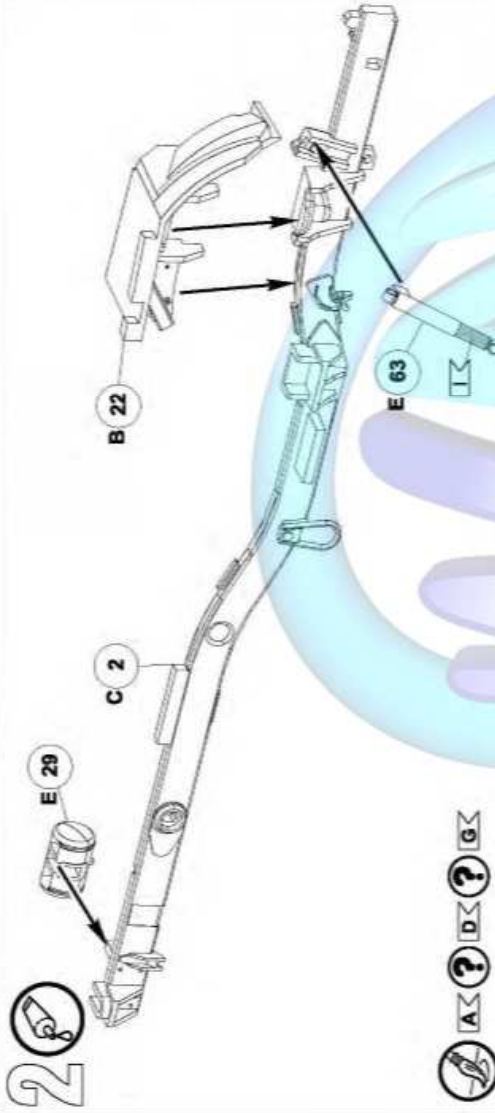

4

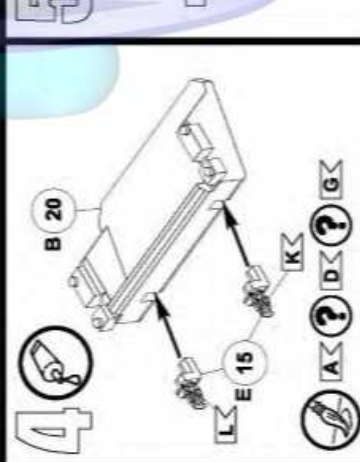

5

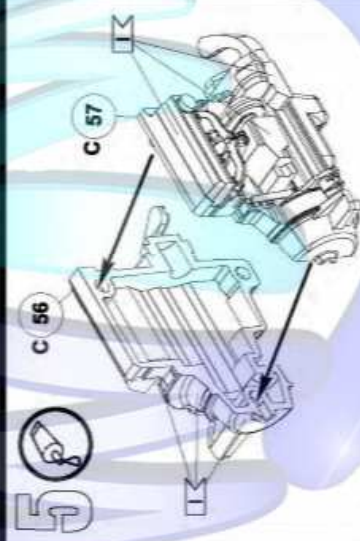

6



7

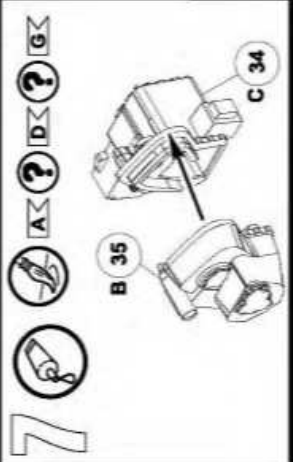

8

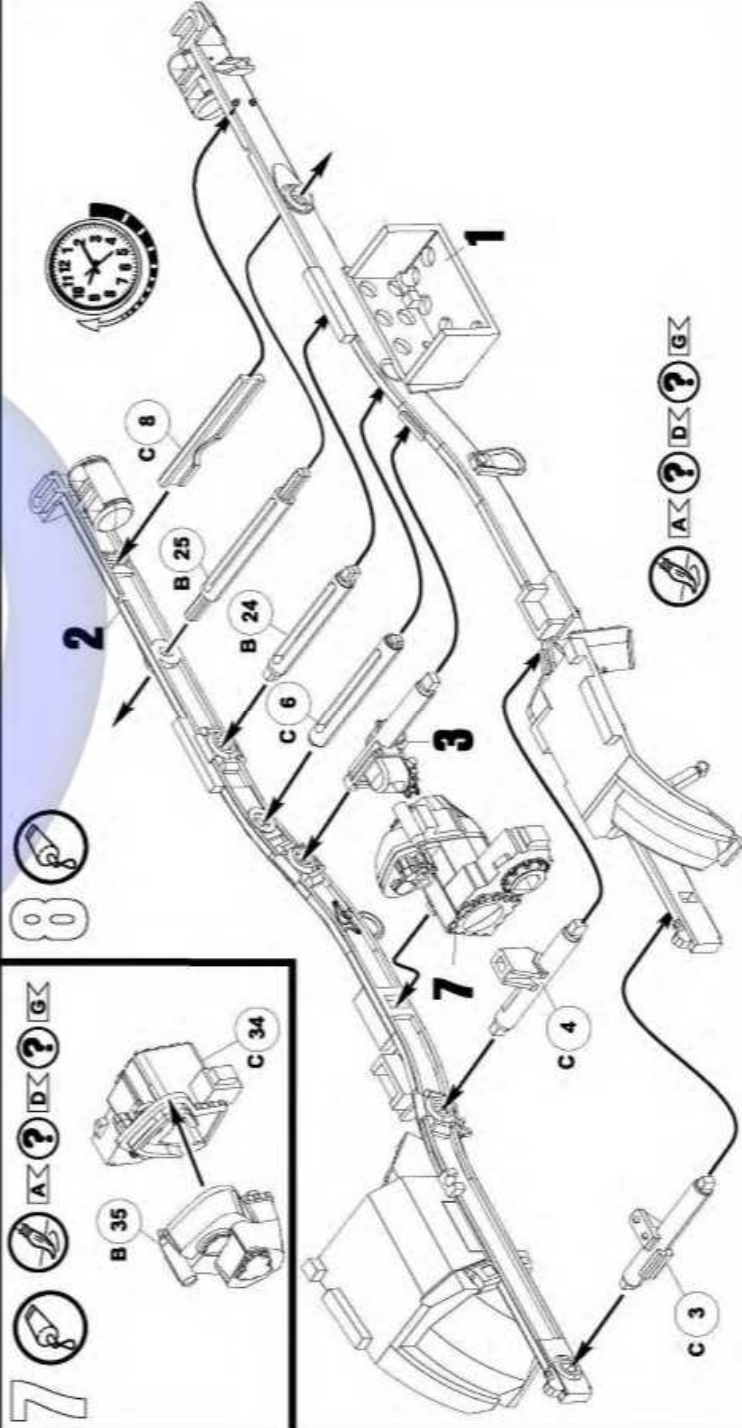

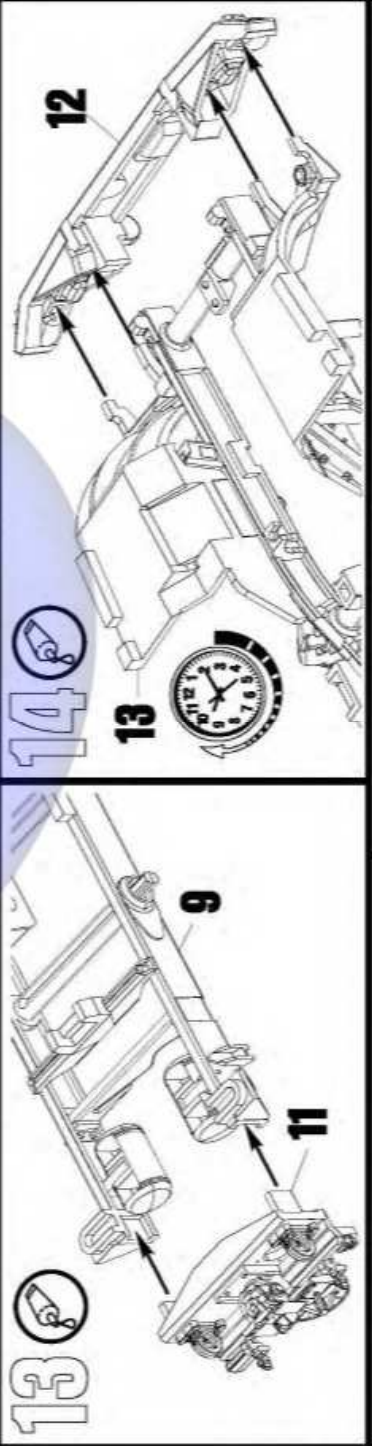
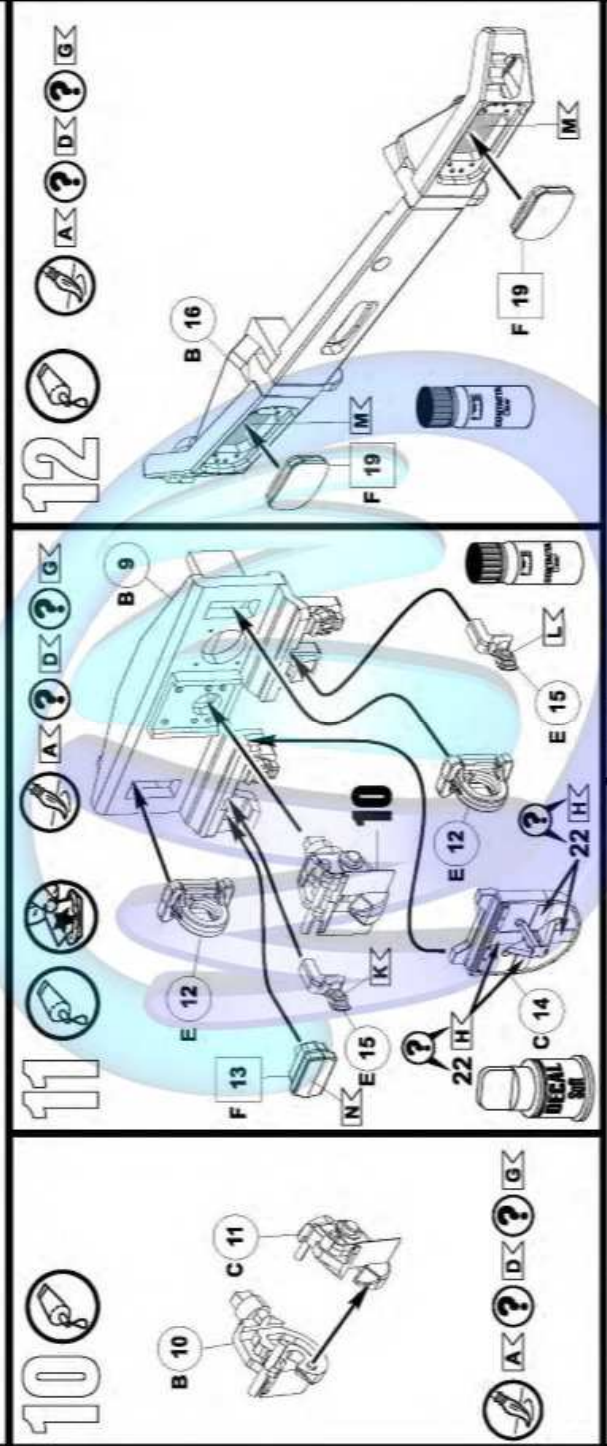
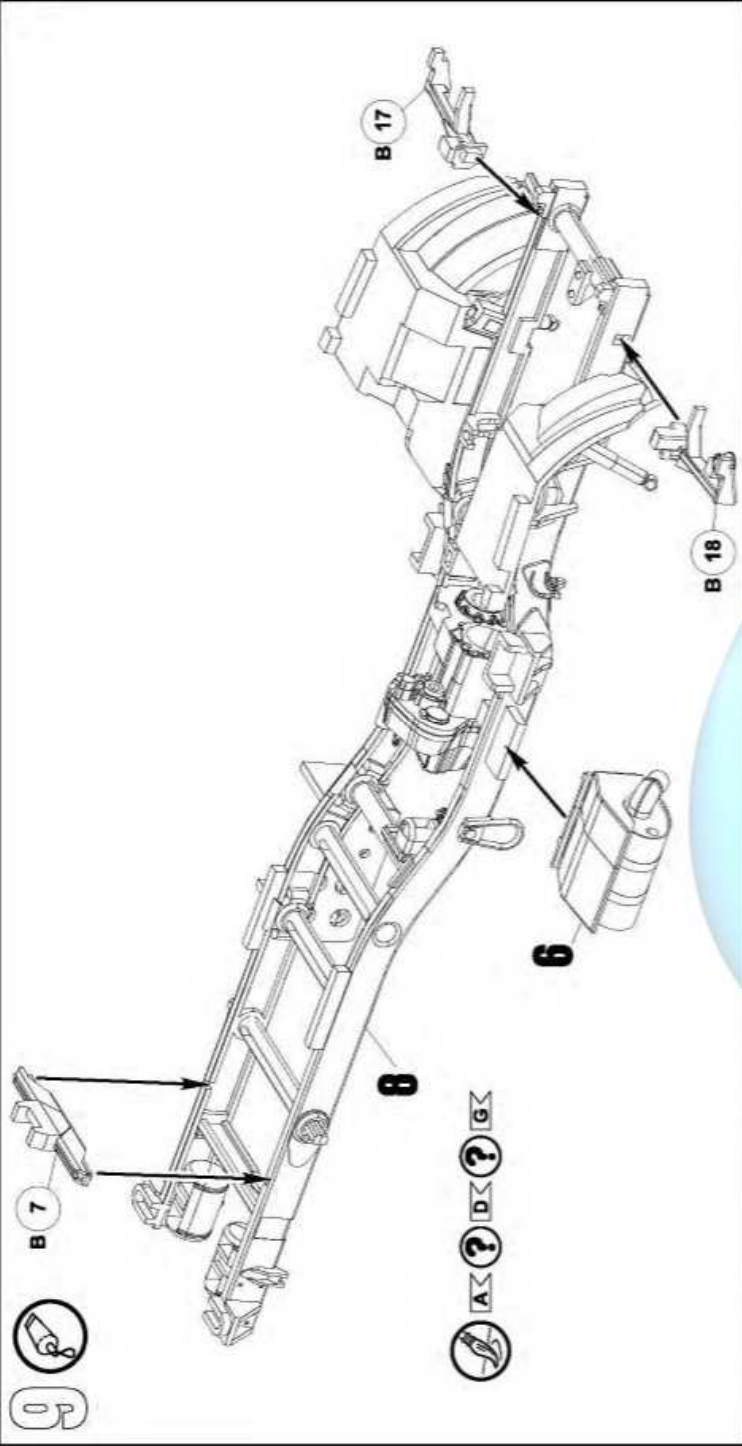



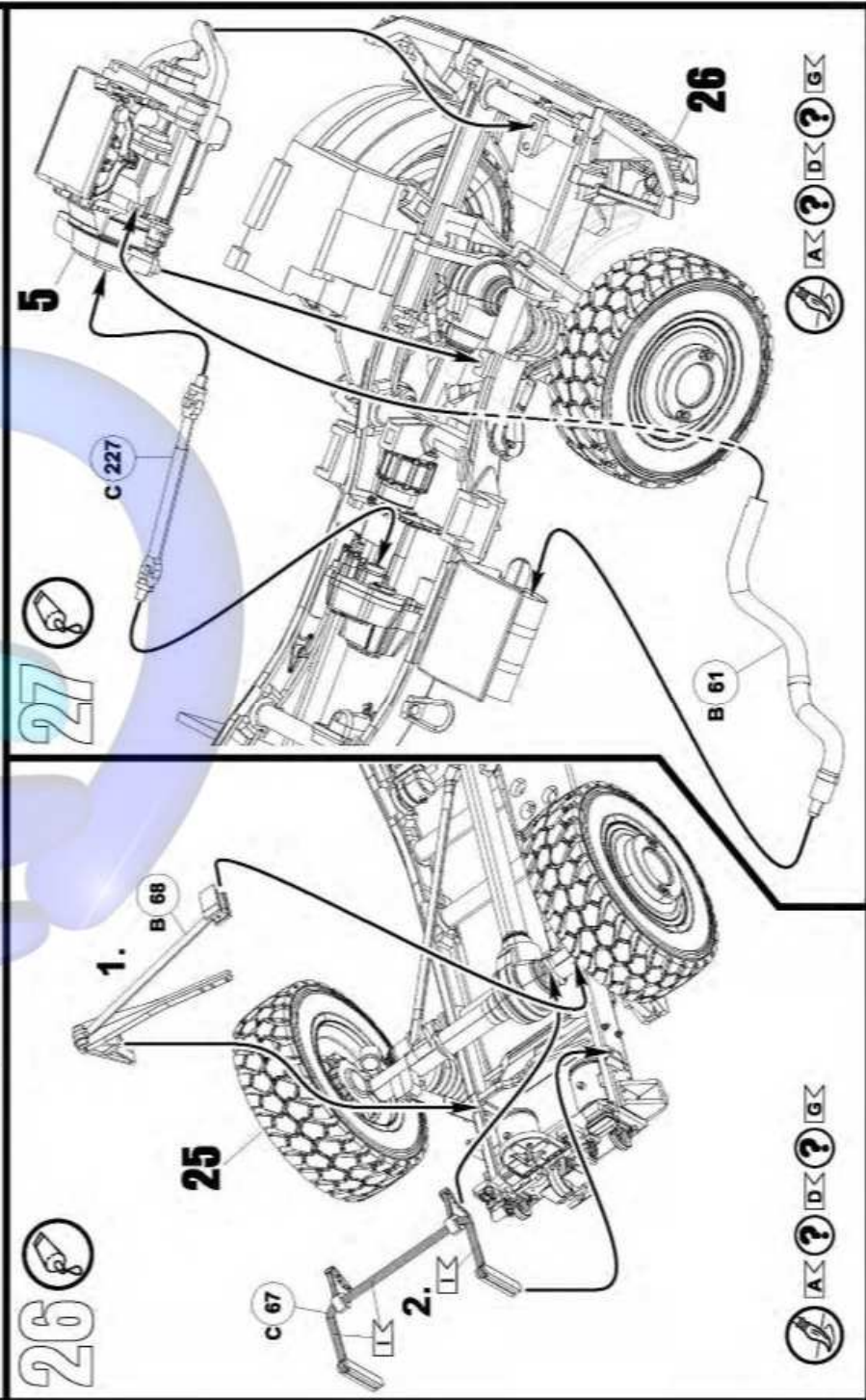
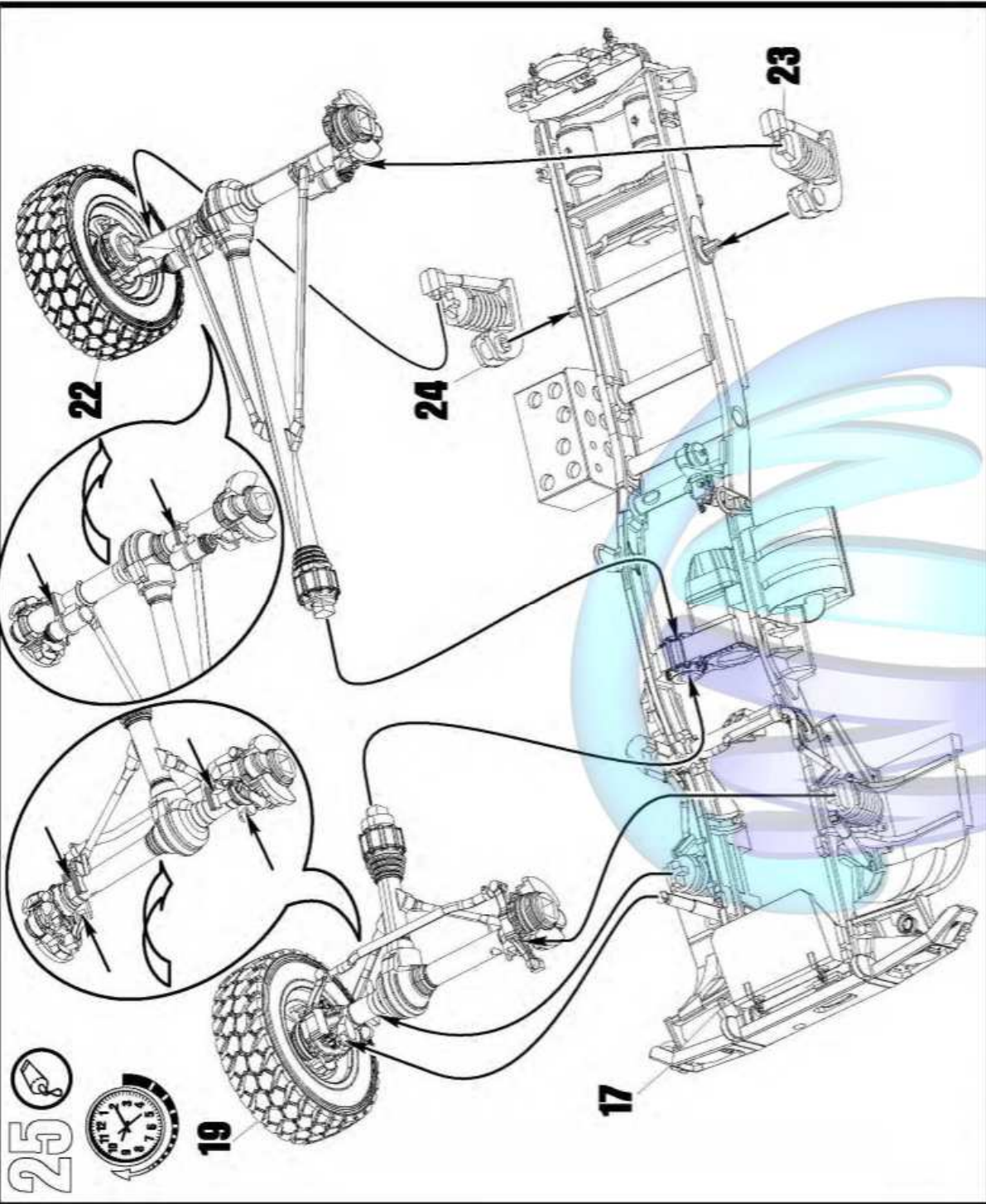

28

27

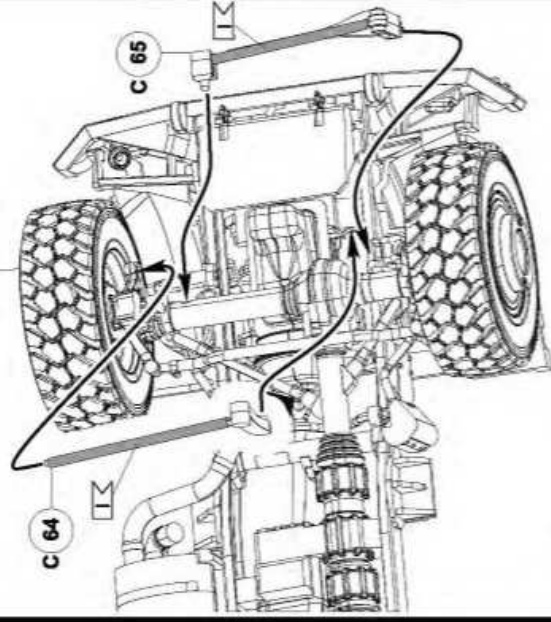

29

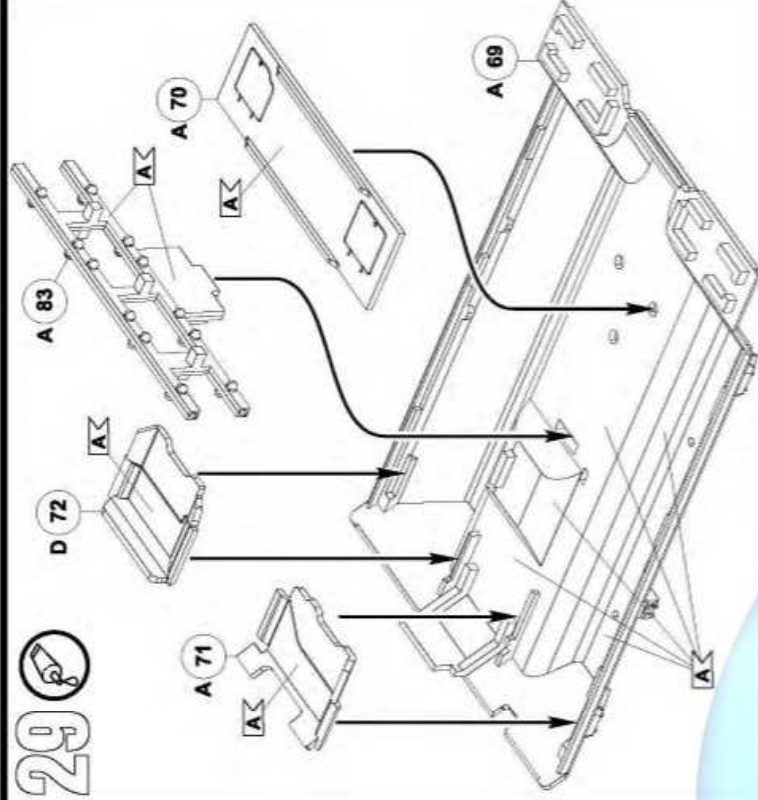

30

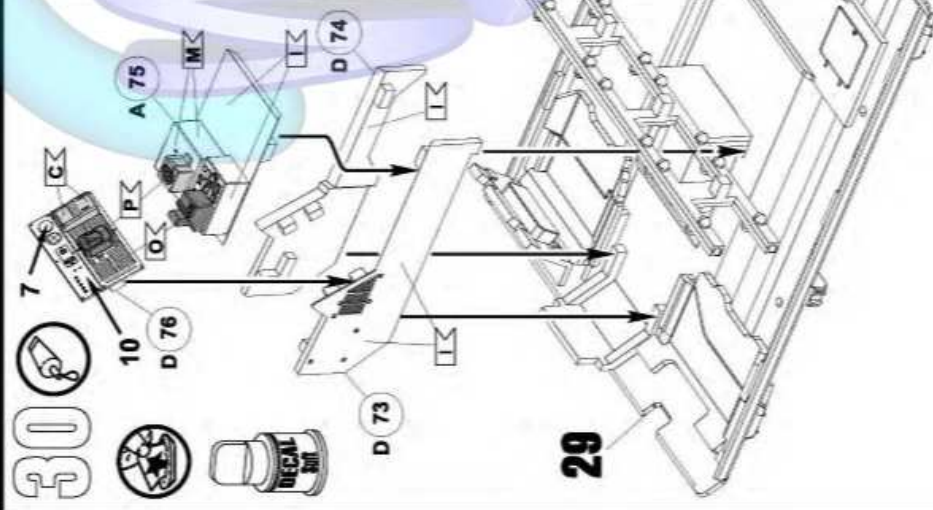

31

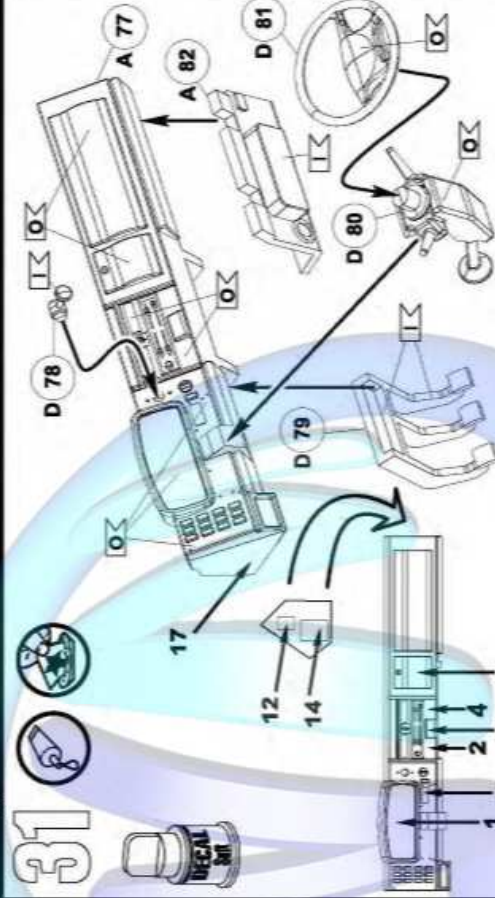
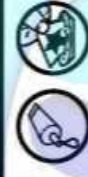
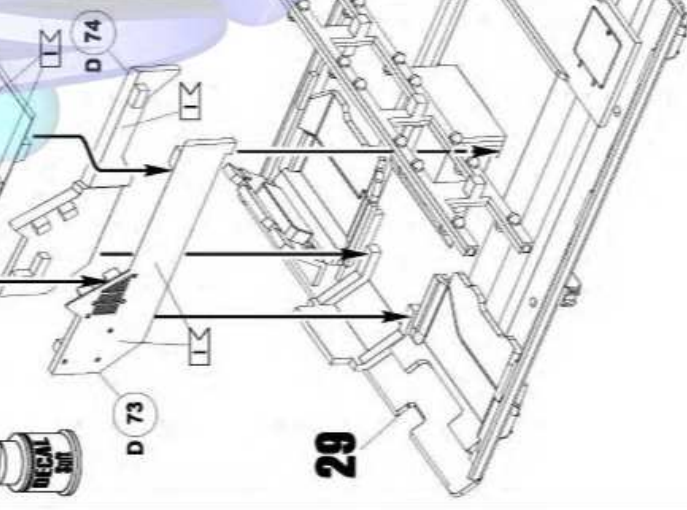
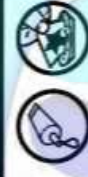

32

33

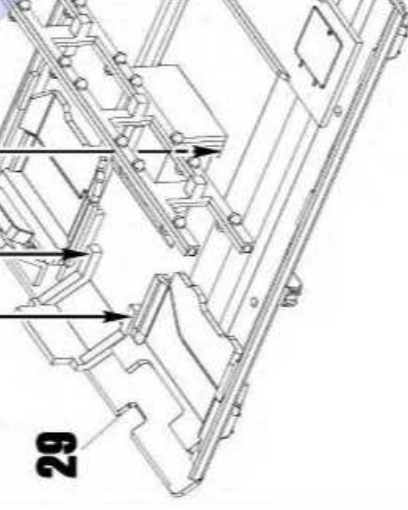
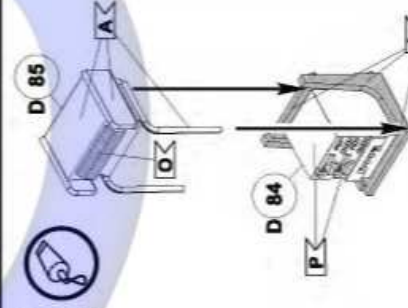

34

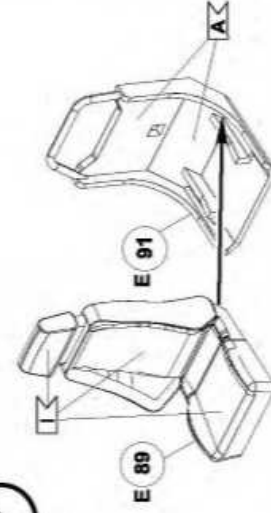

2x

35

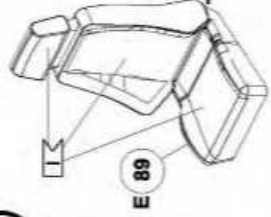

4x

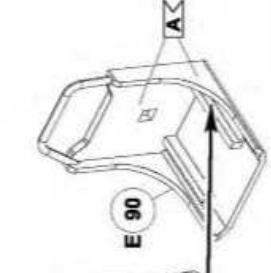

36

37

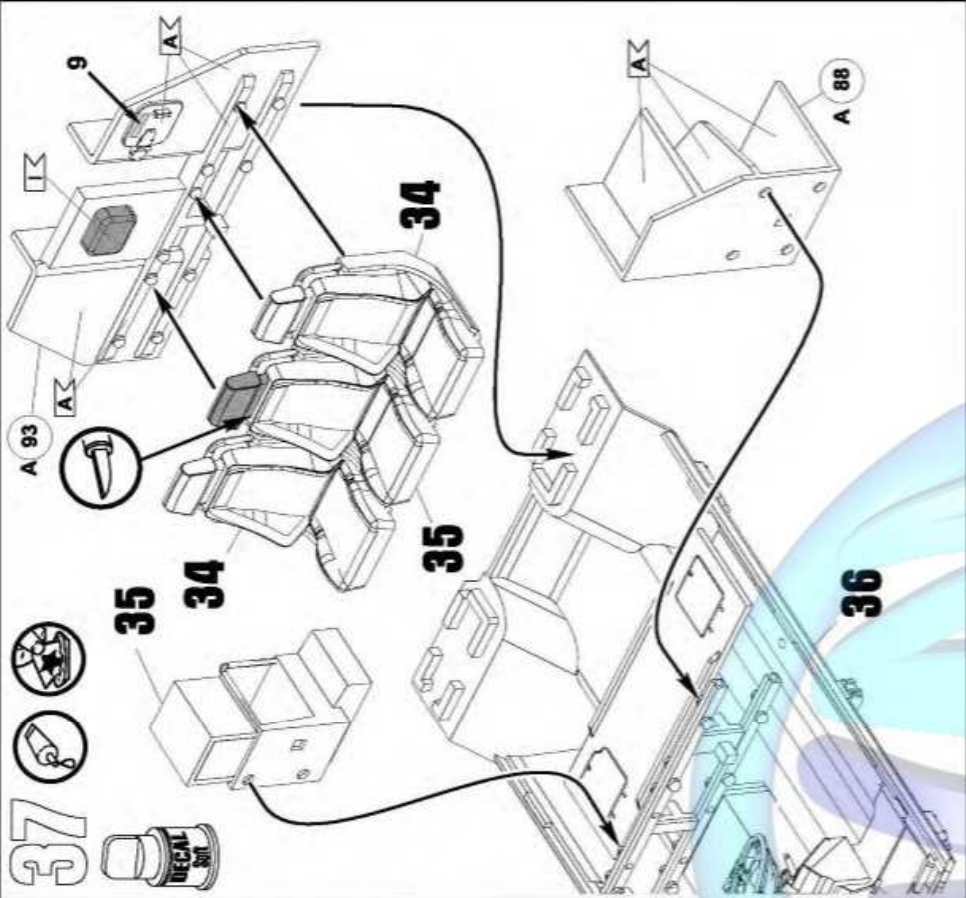

38

39

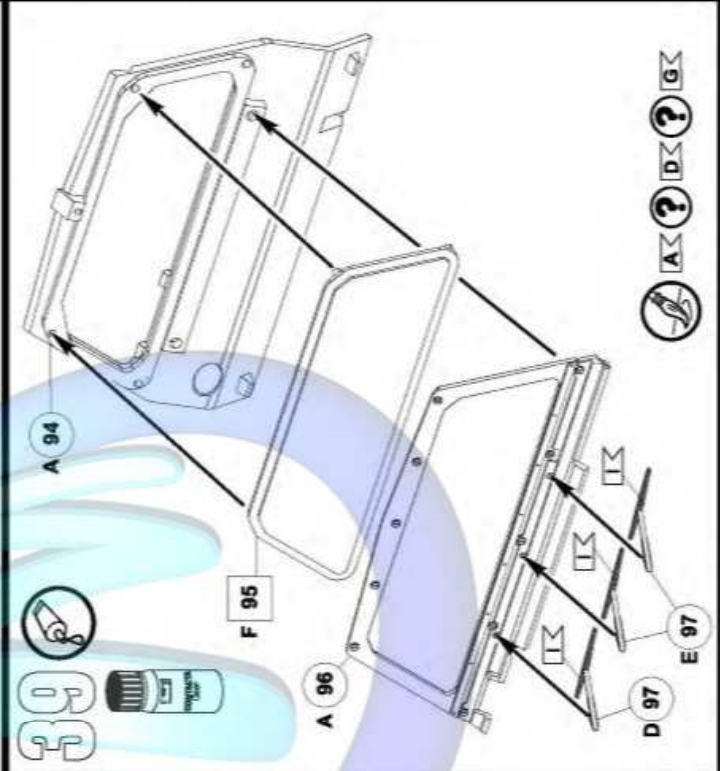

40

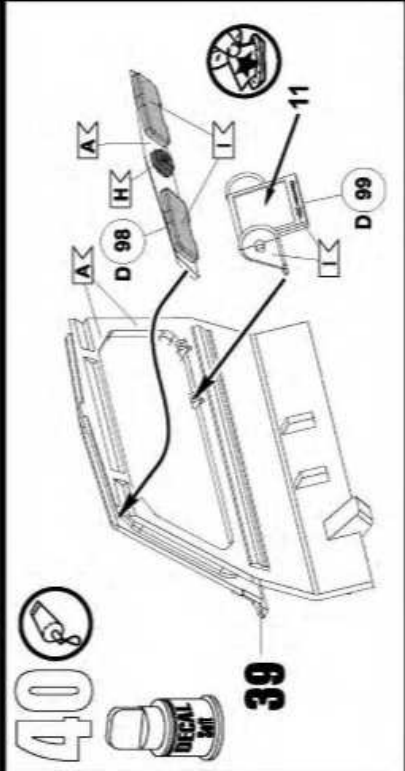



# 49

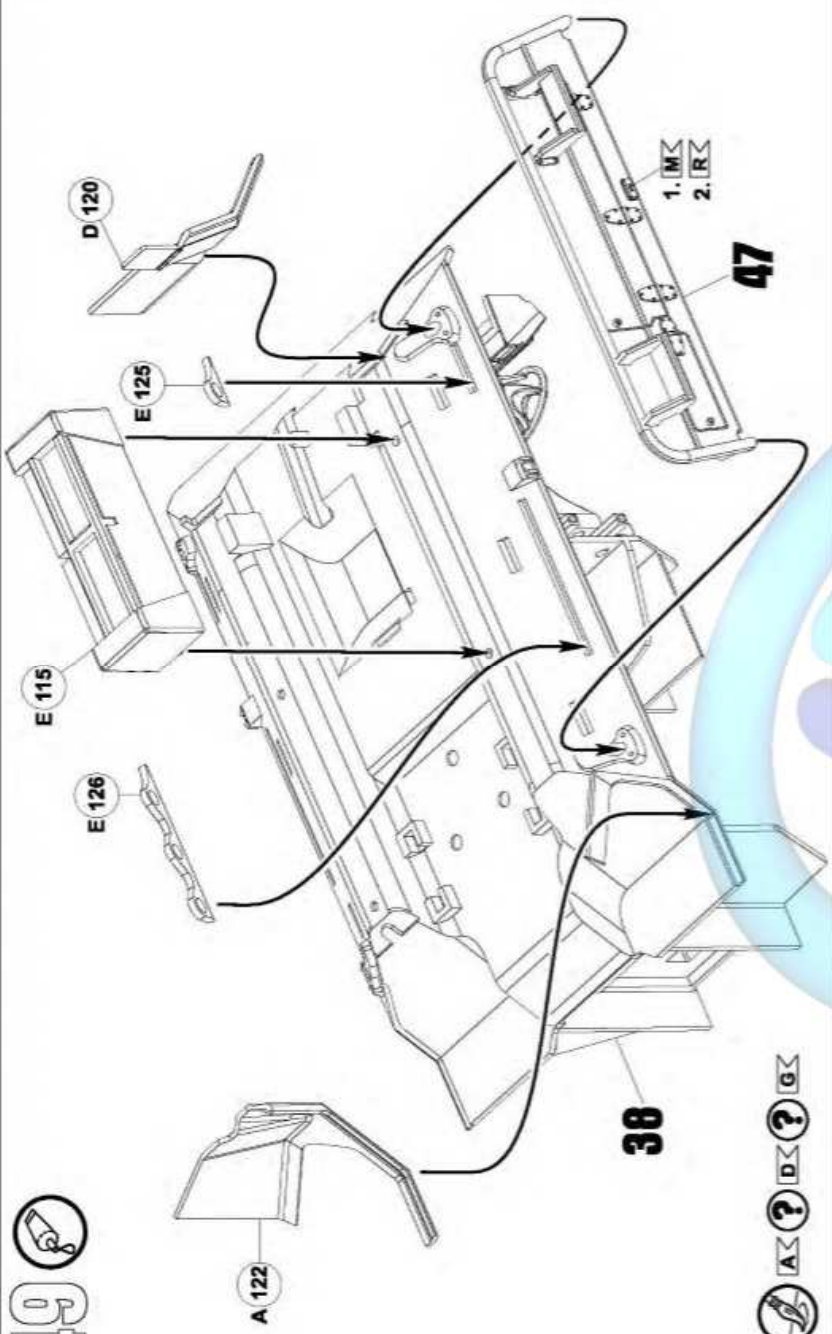

- 

# 50

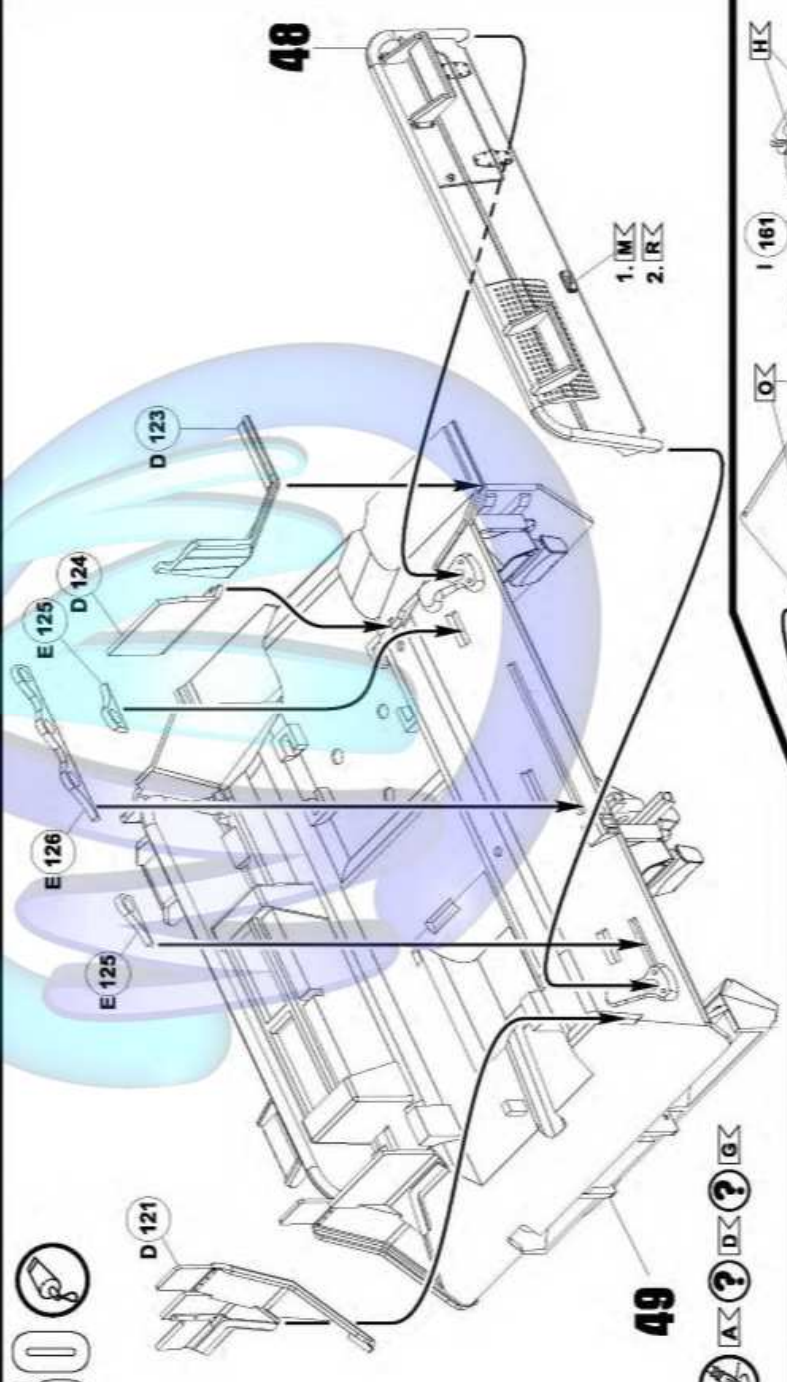

- 

# 51

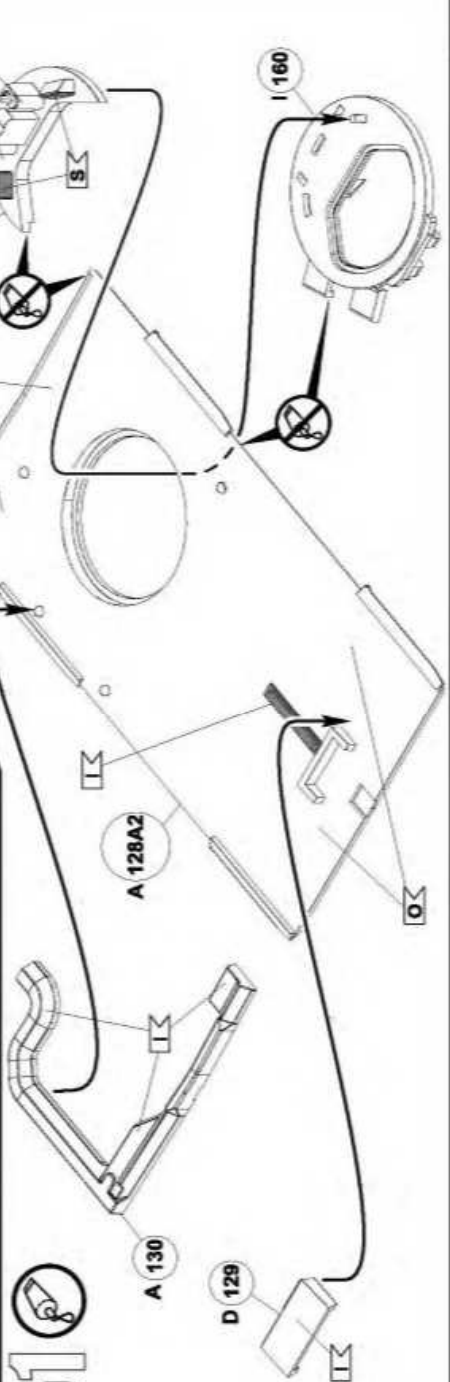



52

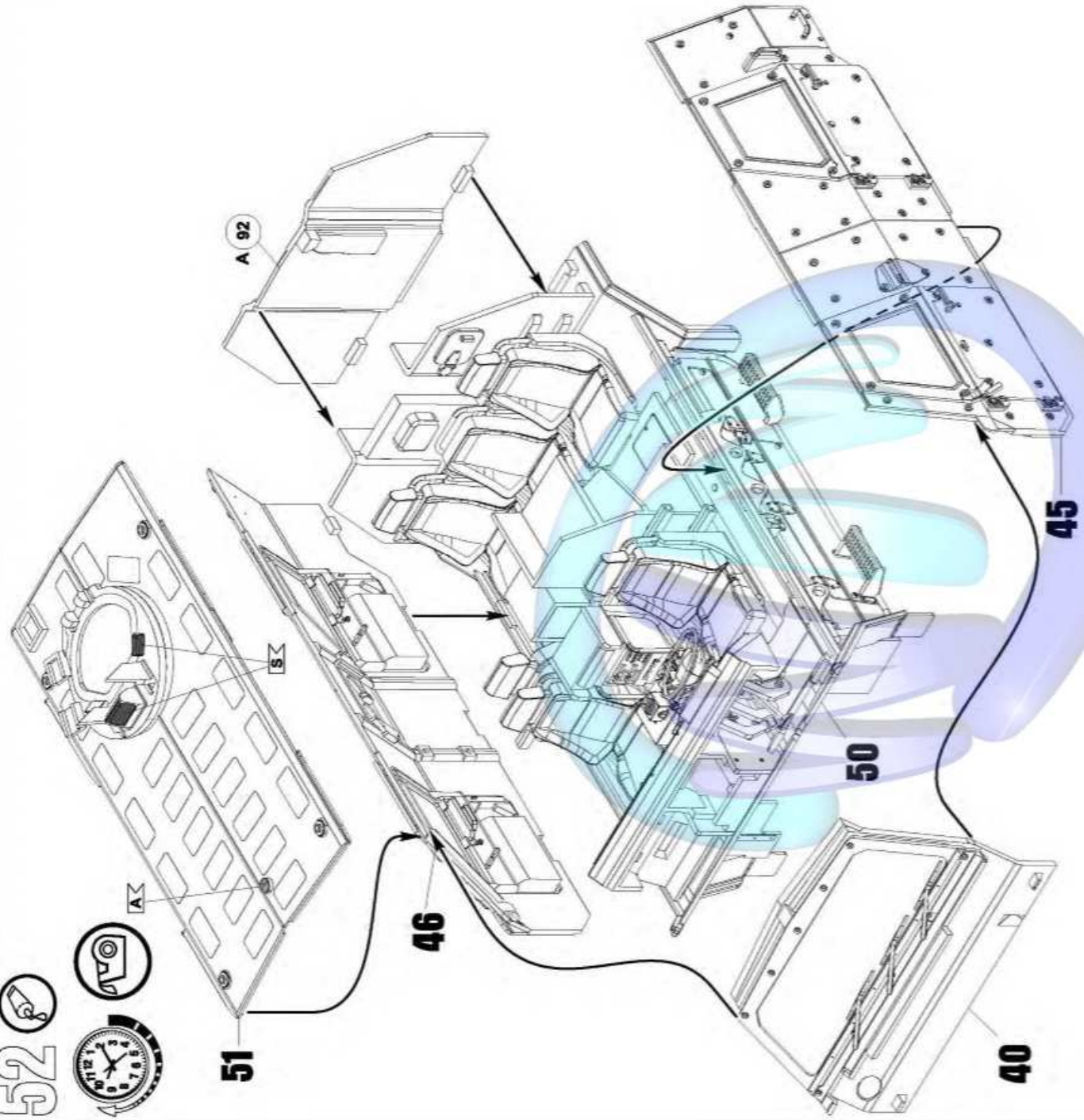

53

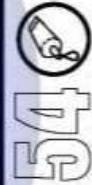
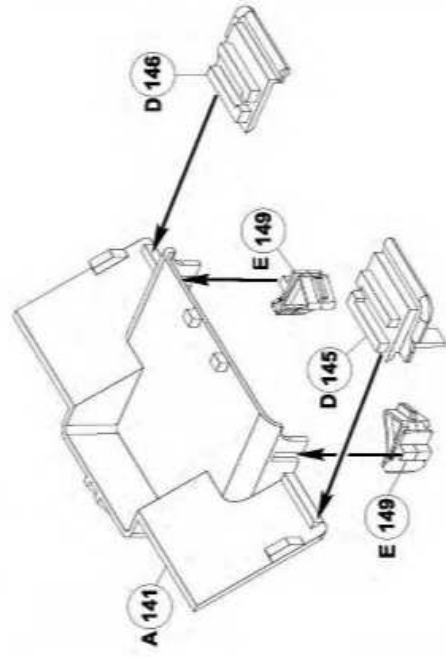

54

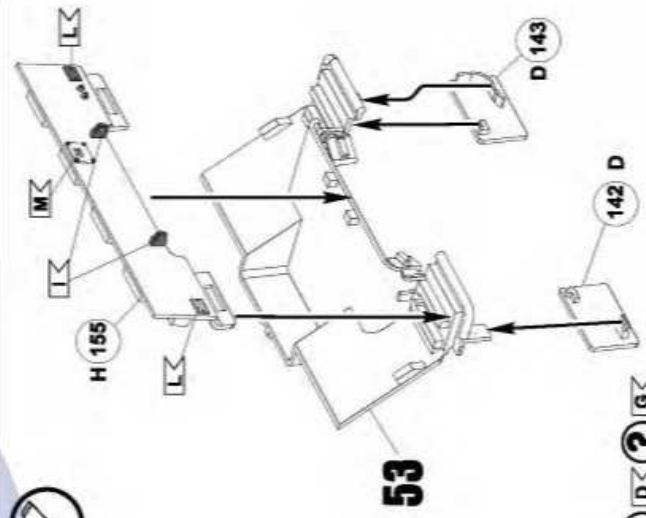

53



54

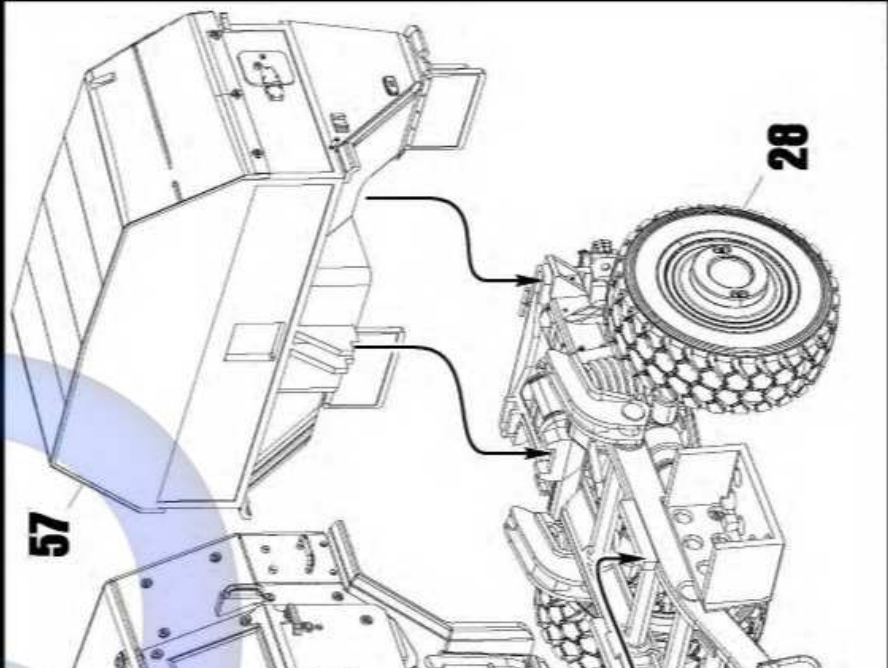
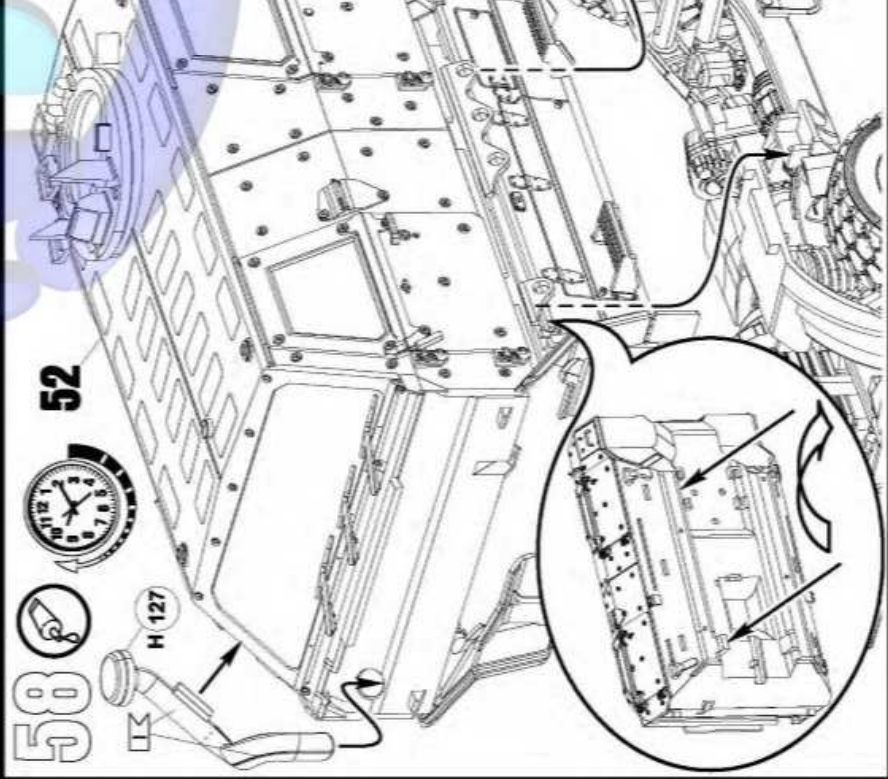
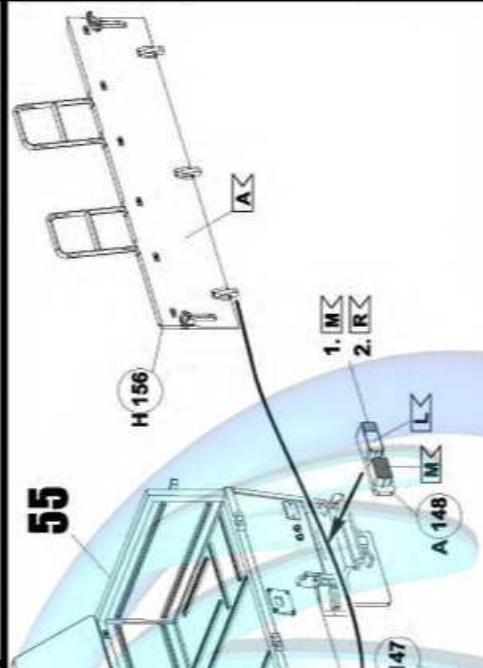
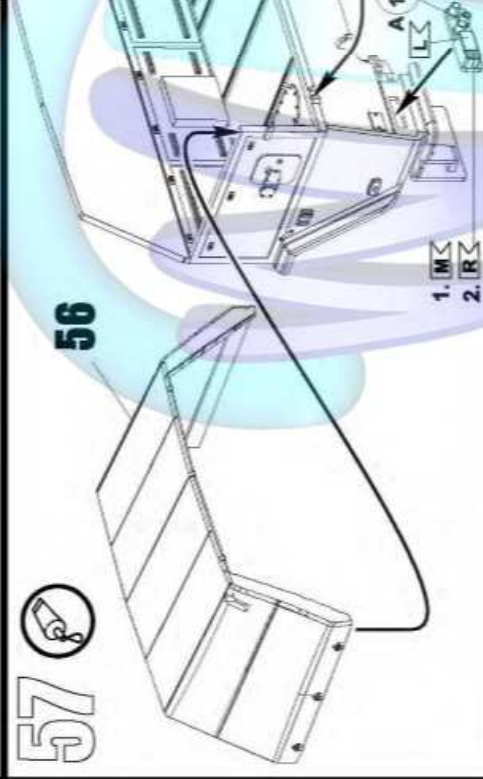
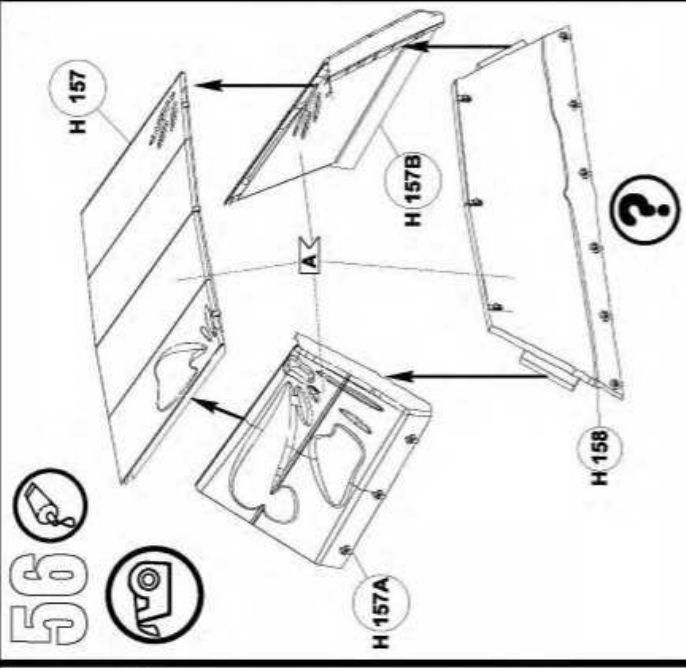
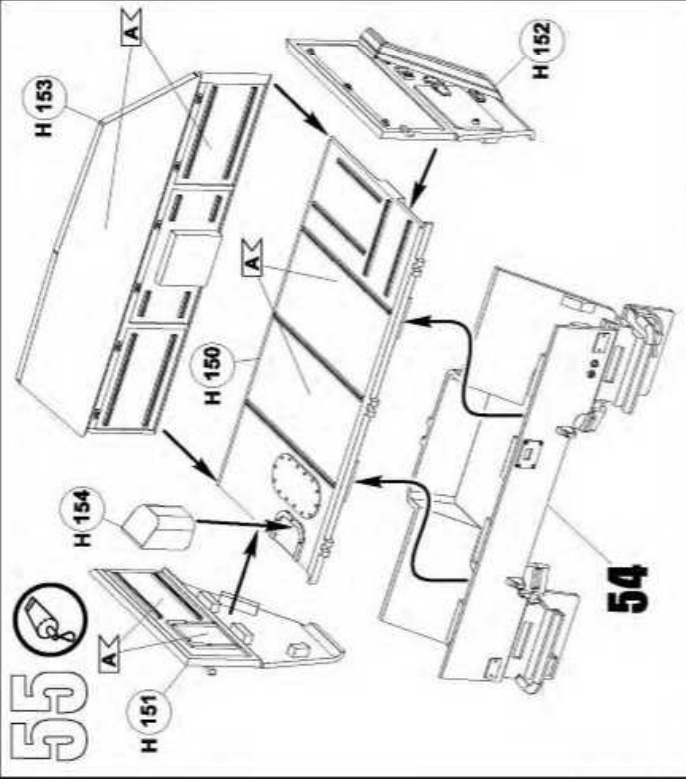

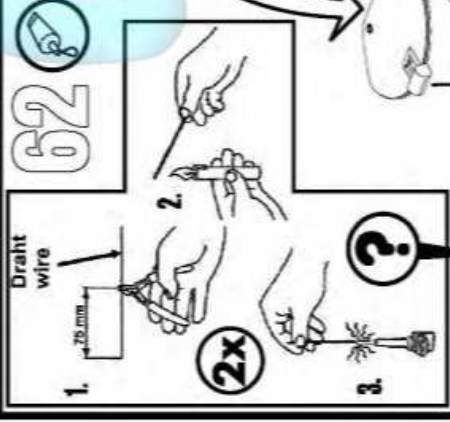
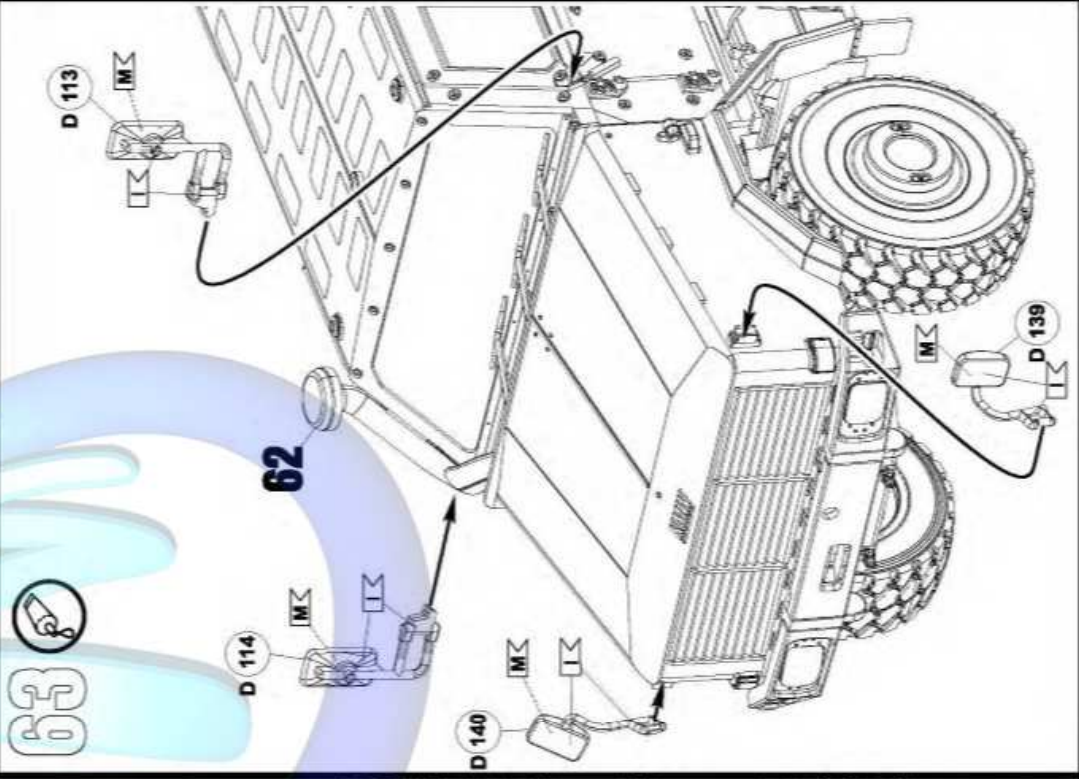
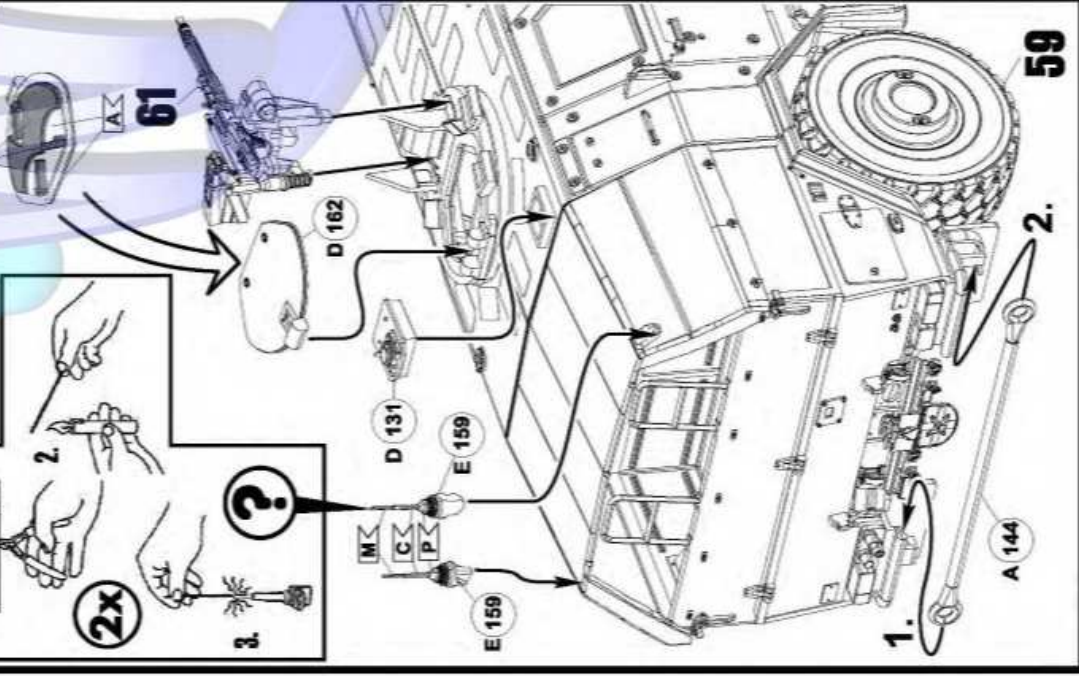
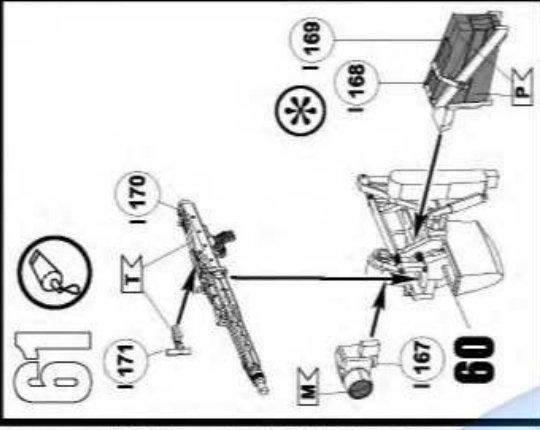
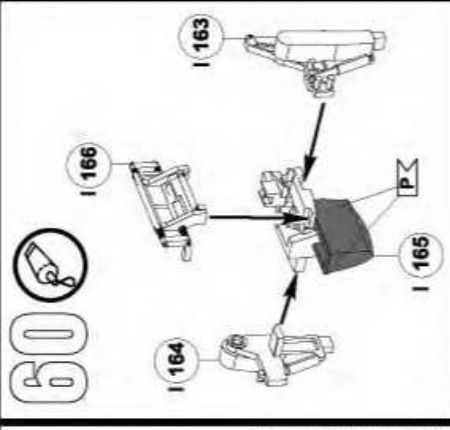
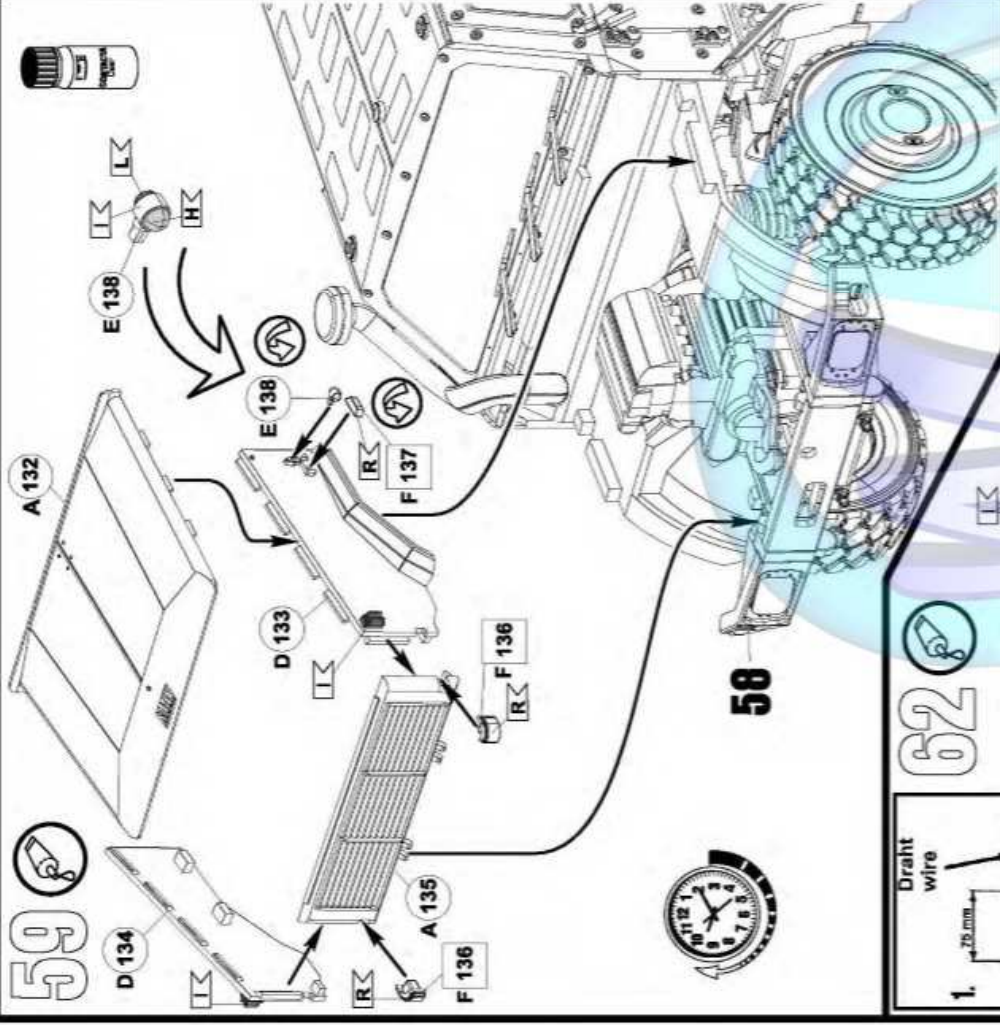



A	B	C	I

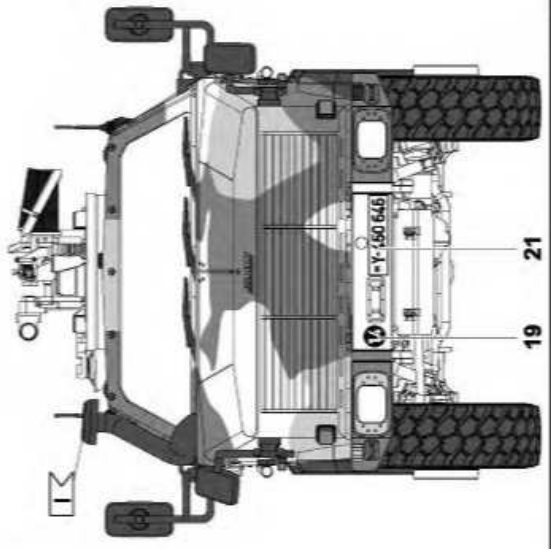
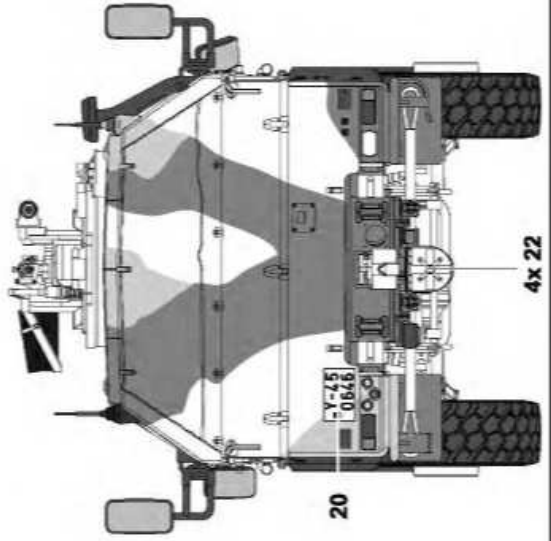
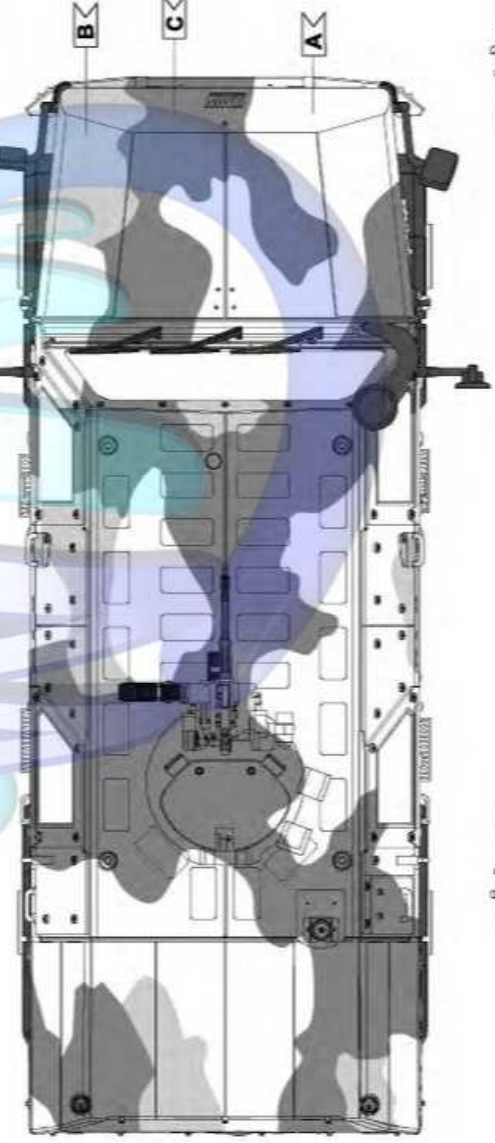
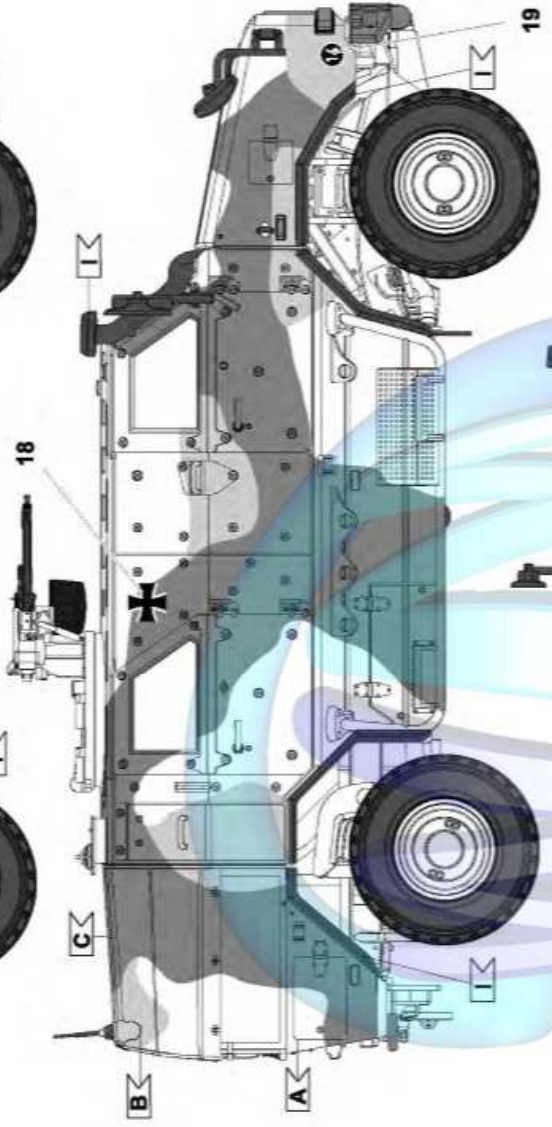
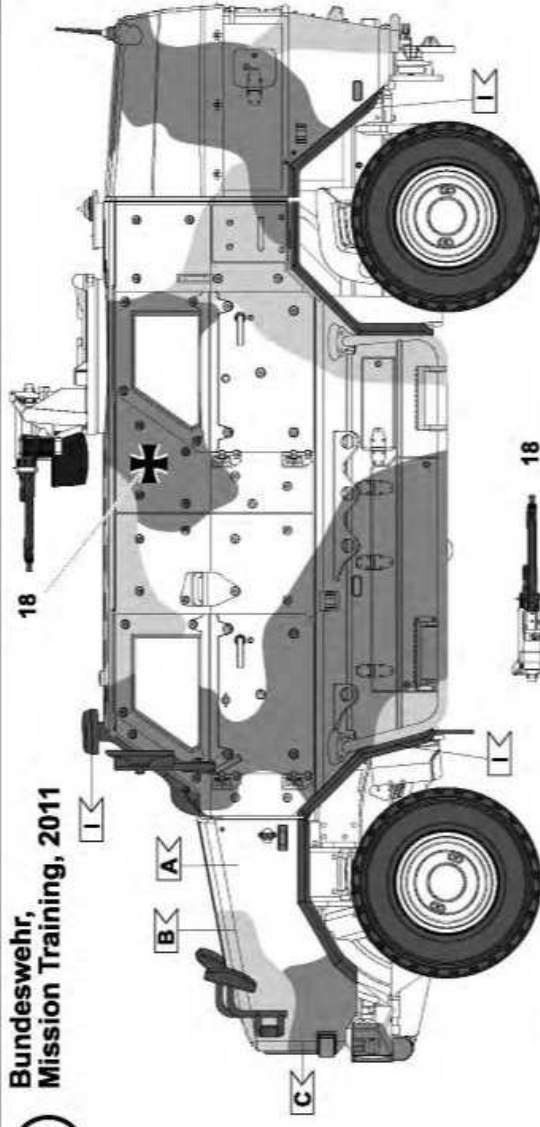





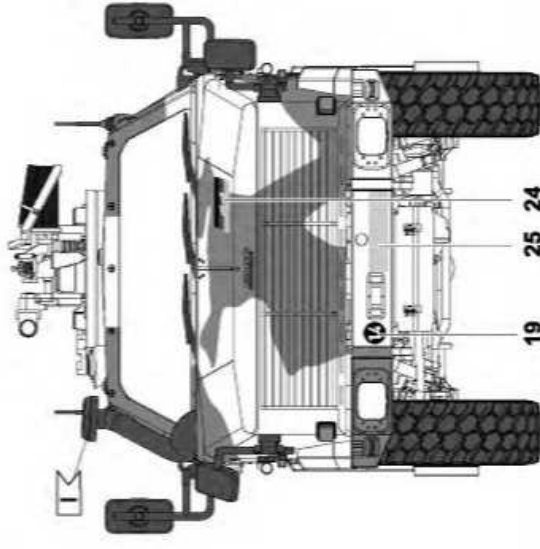
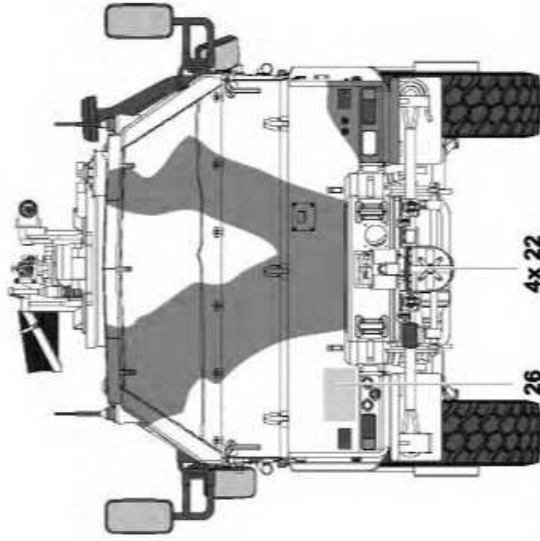
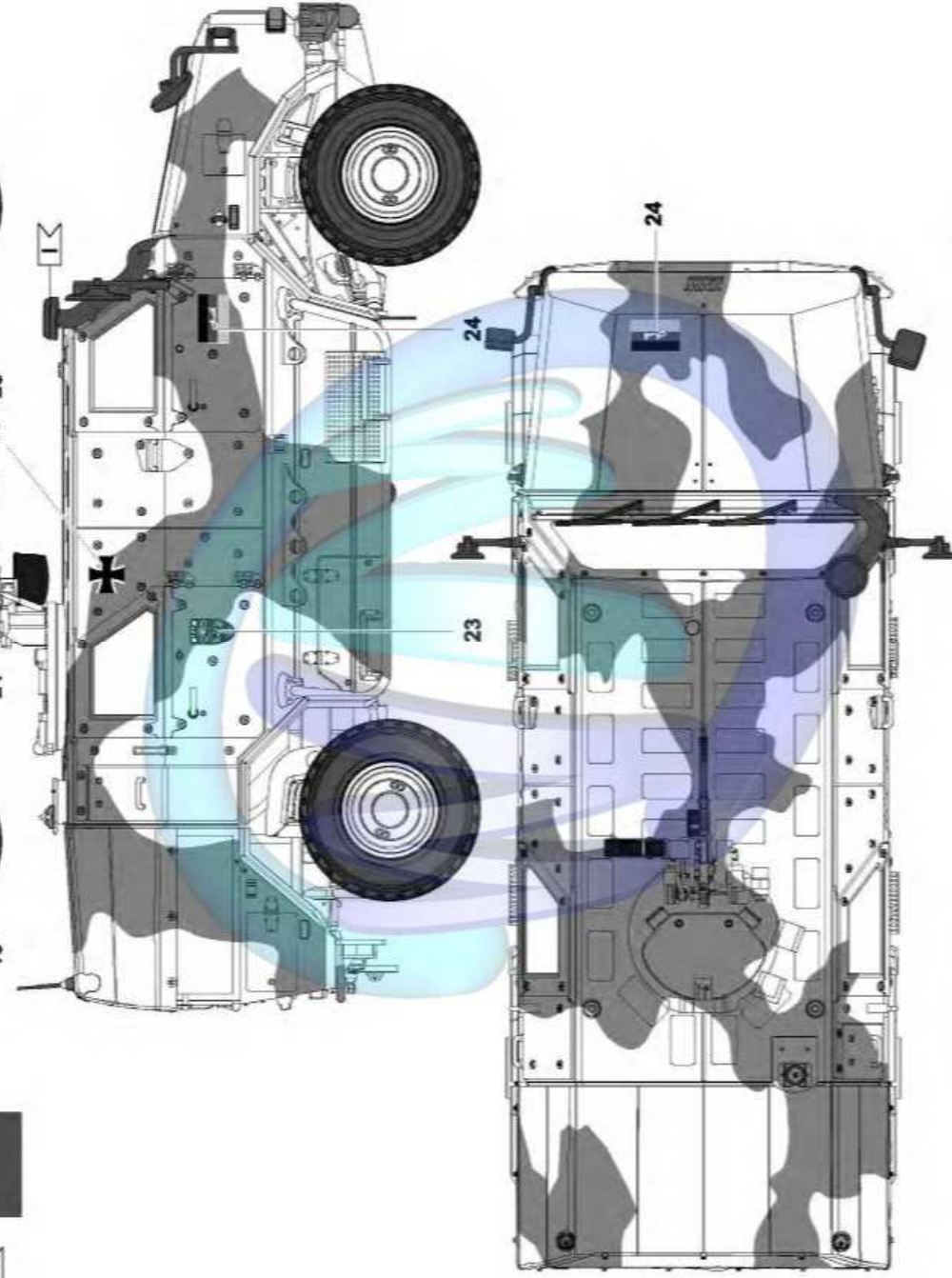
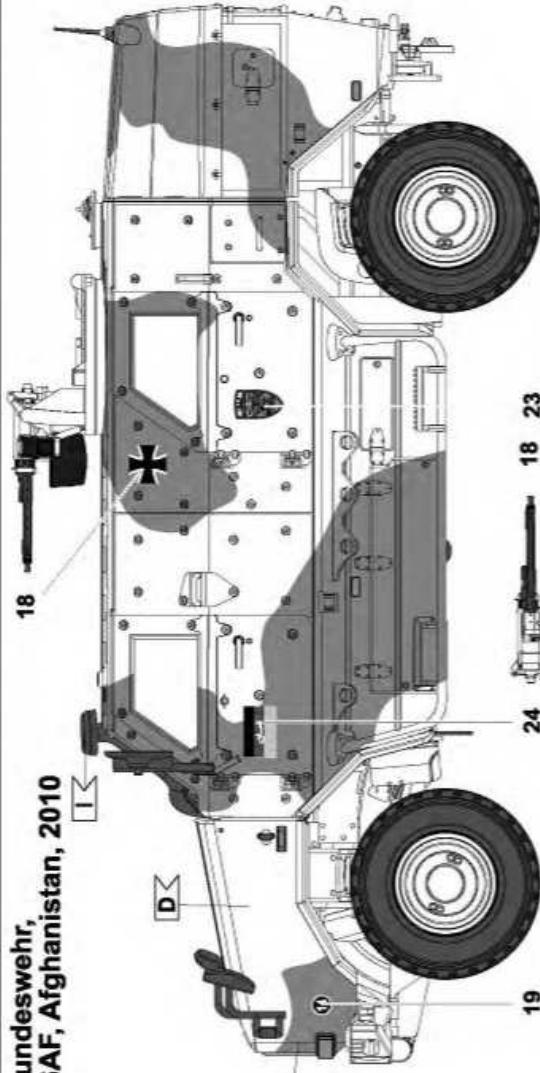
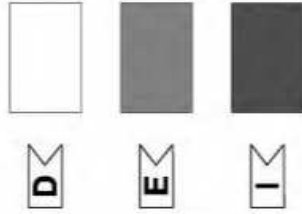

Bundeswehr, ISAF, Afghanistan, 2010





Bundeswehr  
ISAF, Afghanistan, 2012



-  D
-  E
-  F
-  I

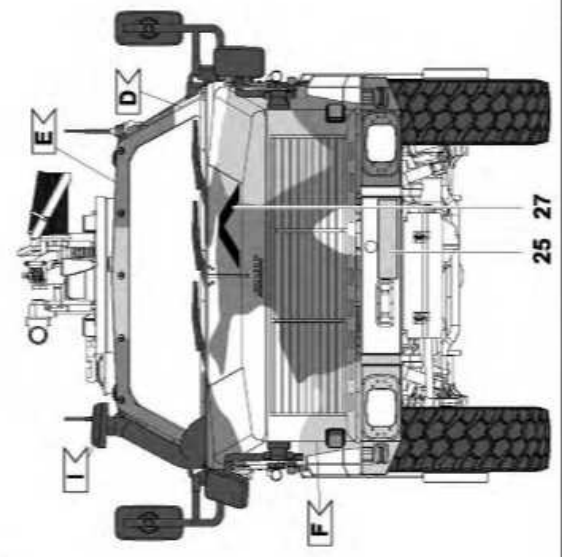
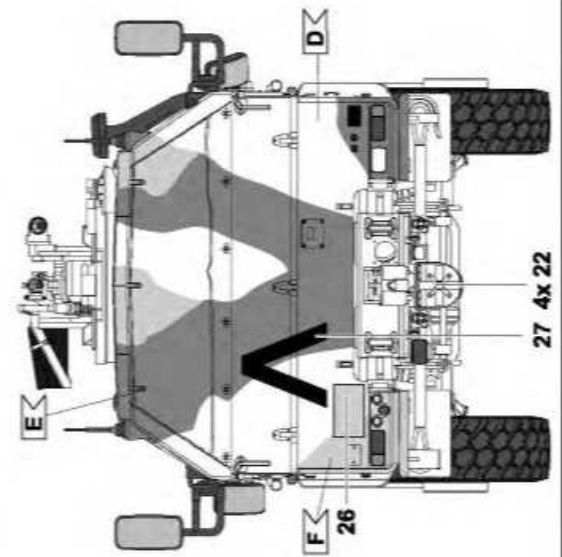
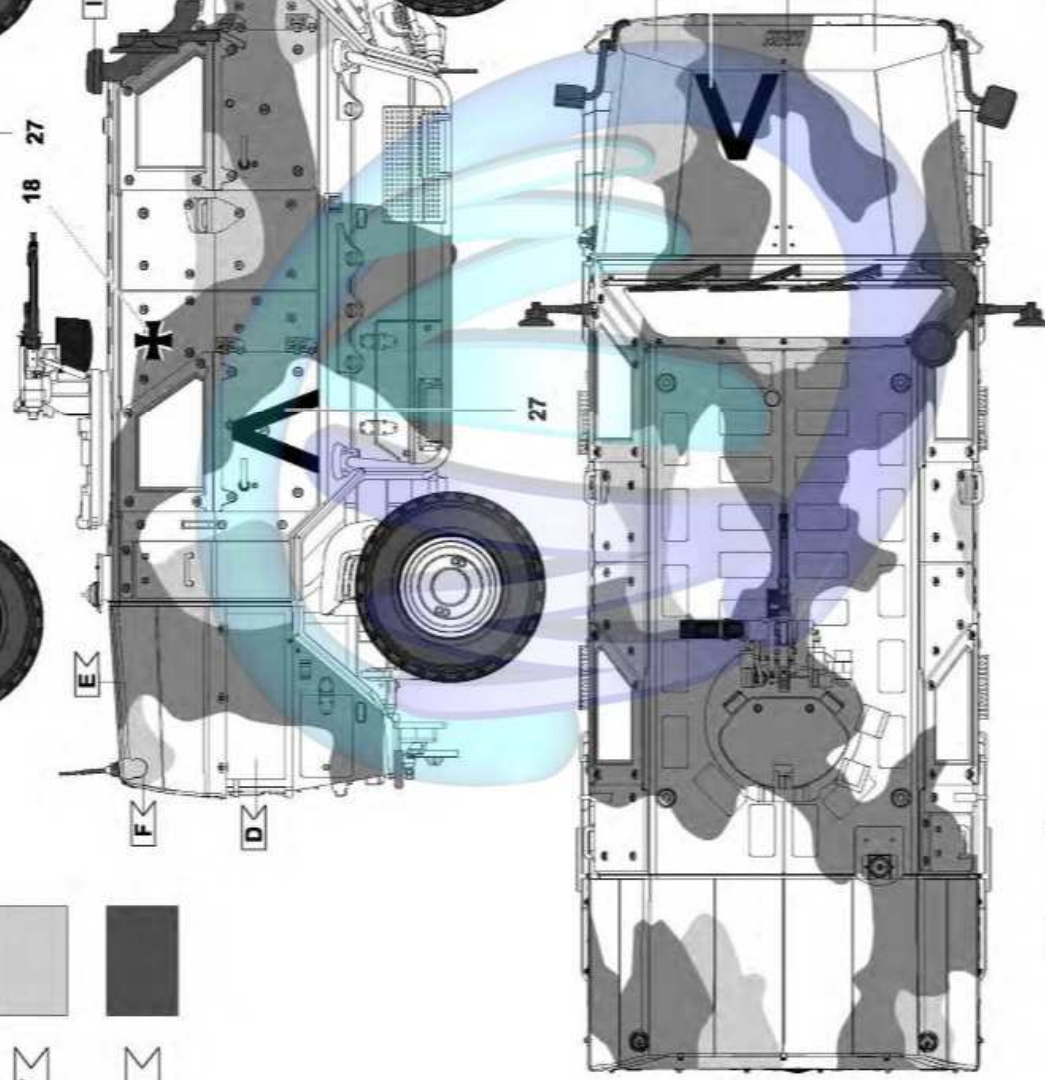
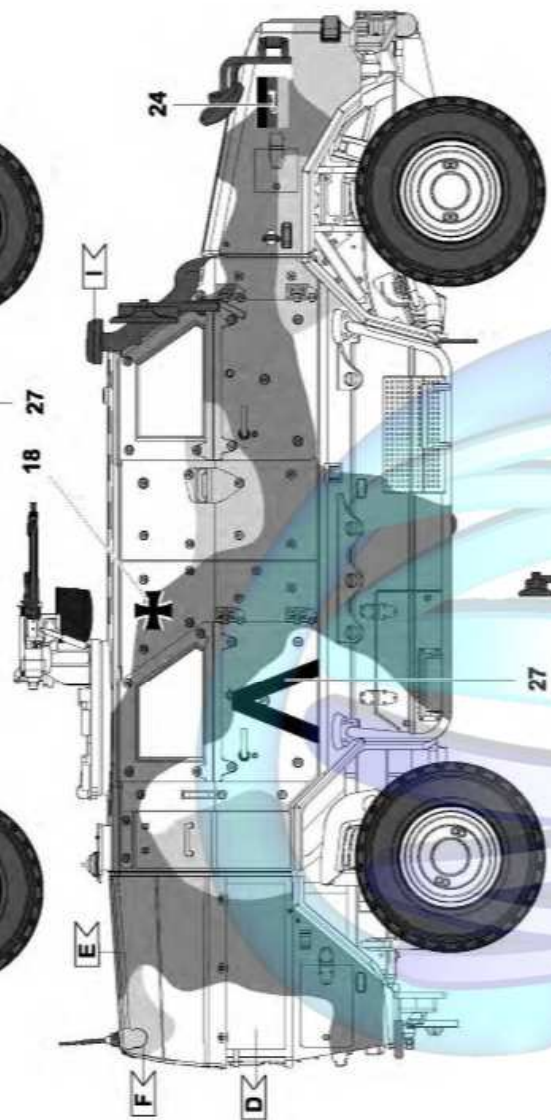
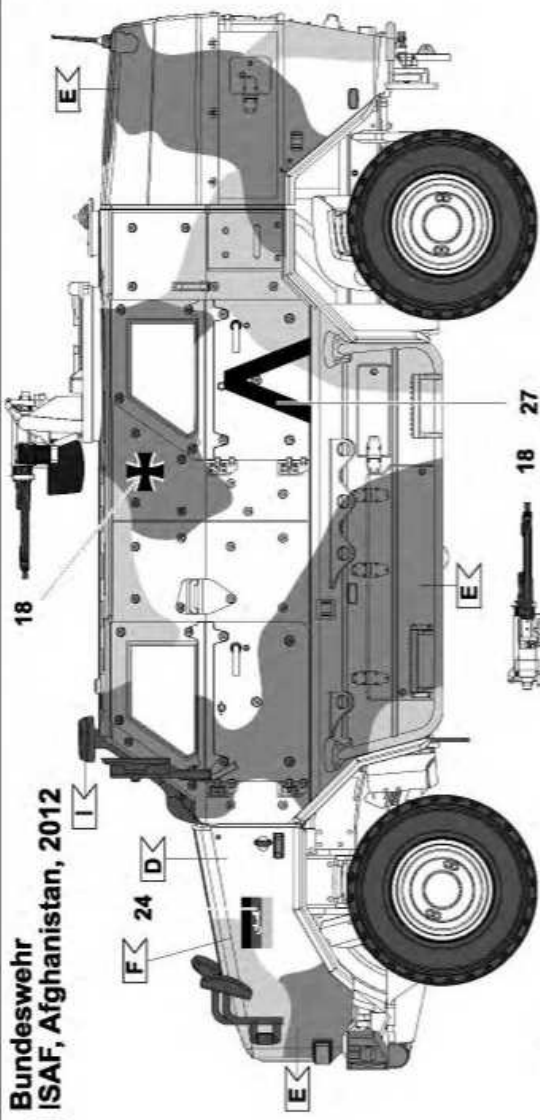

27 4x 22

25 27

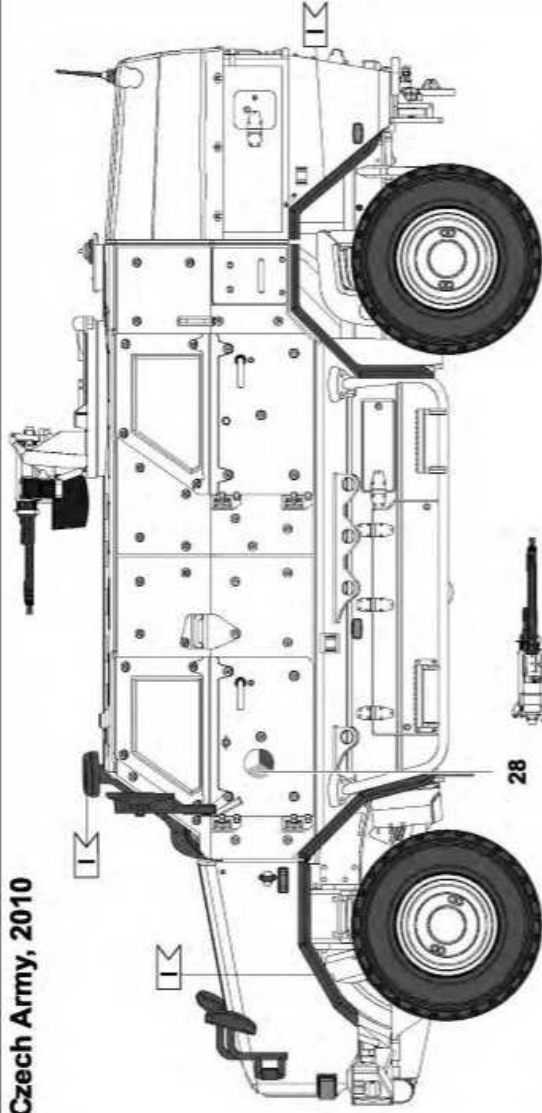
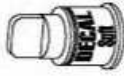

28

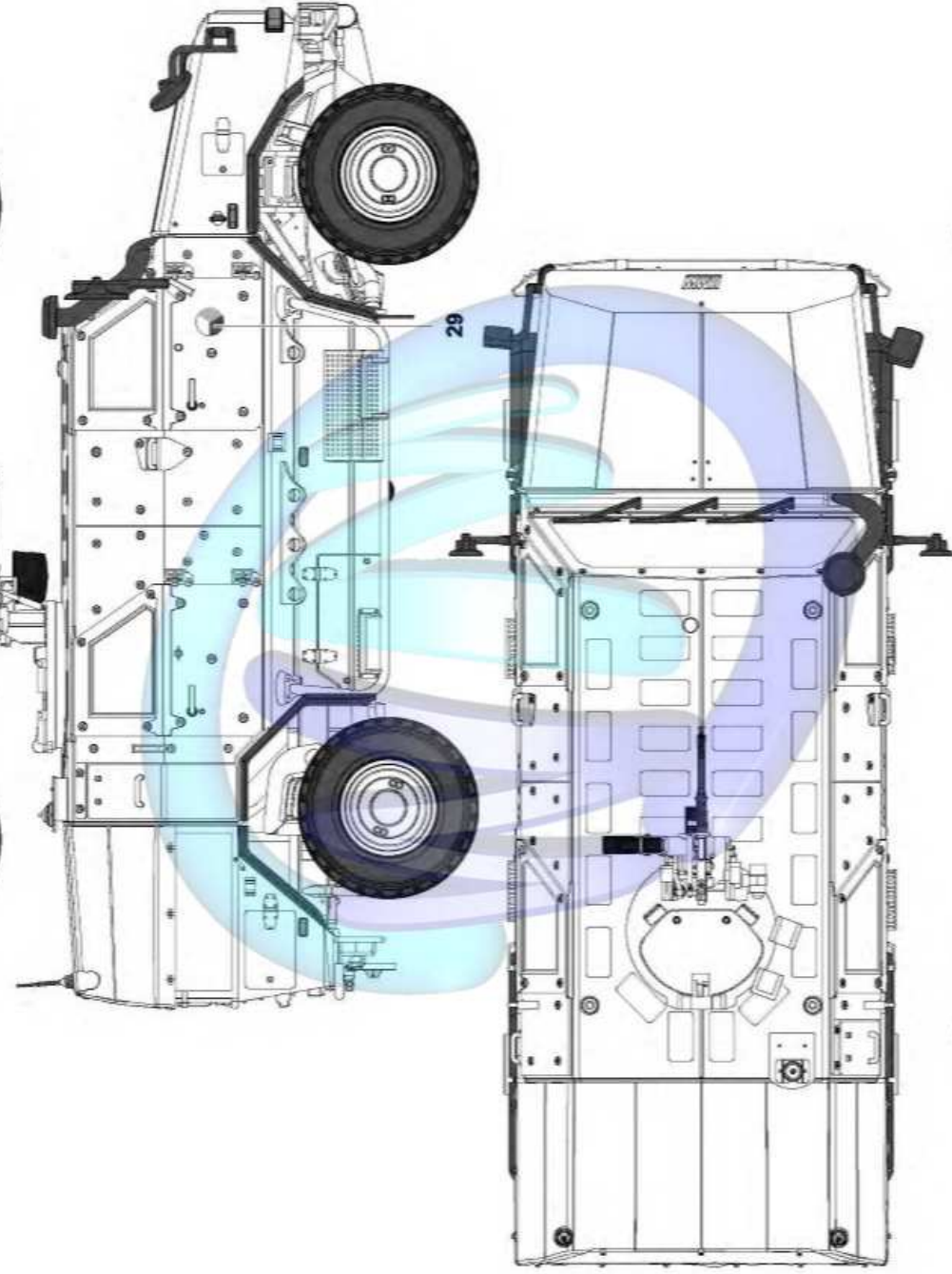

29

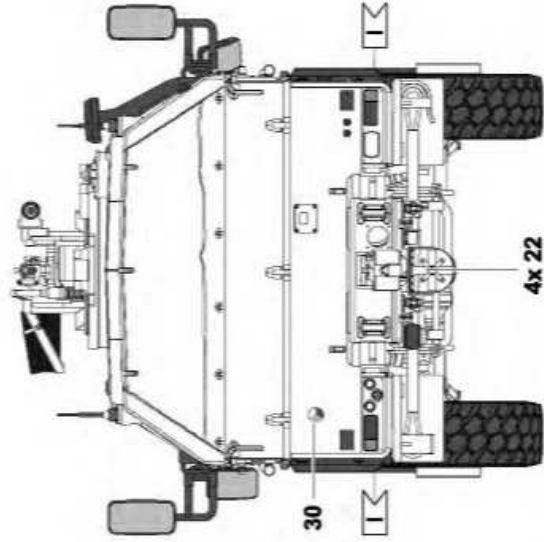

30

4x22

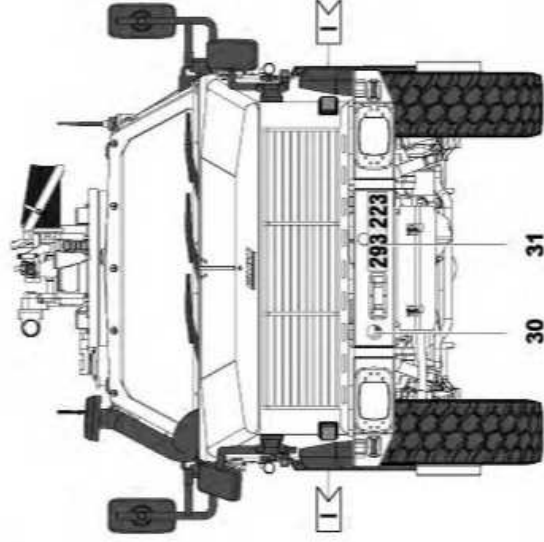

30

31